



Brokerage

NAU
YACHTS

ZALIV III

MOTOR YACHT MONDOMARINE 50.02M 2011

€17,250,000 (VAT paid)
FLAG - MALTA

MOTOR YACHT

ZALIV III



ZALIV III is a 50-metre motor yacht built by **Mondomarine** in 2011 and fully refitted in 2024, combining Italian design excellence with outstanding performance. Constructed entirely from aluminium, her hull and superstructure were designed by Studio Vafiadis.

The recent upgrade programme included a full hull repaint (2025), complete engine overhauls, installation of state-of-the-art audio-visual systems, new teak decking, refreshed upholstery, marble restoration, and a comprehensive update of both interior and exterior spaces.

She accommodates up to 12 guests in six luxurious staterooms. The main deck master suite features a king-size bed, his-and-hers bathrooms with Jacuzzi, steam room, and shower, a walk-in wardrobe, a private lounge, office, and wine cellar. On the lower deck, a VIP suite with its own study can serve as a second master. Two additional guest cabins and a second VIP suite, all with en suite bathrooms, complete the guest accommodation.

Outdoor living is a highlight, with a sundeck offering a Jacuzzi, lounge area, al fresco dining, sunpads, bar, and TV, as well as generous aft deck lounges on both the upper and main decks.

Powered by twin MTU 16V4000M90 engines, **ZALIV III** cruises between 14 and 20 knots. Zero-speed stabilisers ensure exceptional comfort underway and at anchor. Since launch, she has been meticulously maintained by her original owner.

[see more information about M/Y ZALIV III at www.nauyachts.com](http://www.nauyachts.com)

SPECIFICATION

SHIPYARD, MODEL	Mondomarine 50M
BUILT	2011
LENGTH	50.02 m
WATERLINE LENGTH	46.8 m
HULL CONFIGURATION	SEMI-DISPLACEMENT
BEAM	9.1 m
RANGE	2500
DRAFT	2.3 m
GROSS TONNAGE	499 GT
YACHT CLASS	RINA
CABINS	6+5
MASTER CABIN	MAIN DECK
GUESTS	12
BERTHS	12+9
CREW	9
HEADS	8+5

EXTERIOR DESIGN	STUDIO VAFIADIS
INTERIOR DESIGN	STUDIO VAFIADIS
HULL	ALUMINUM
SUPERSTRUCTURE	ALUMINIUM
ENGINES	2 x 16V4000M90 3770 h.p.
TYPE OF DRIVE	SHAFT LINE
ENGINE HOURS	6500 h
MAXIMUM SPEED	20 kn
CRUISING SPEED	14 kn
FUEL CONSUMPTION AT ECONOMICAL SPEED	~ 450 l/h
FUEL	80000 l
GREY WATER	2000 l
BLACK WATER	2000 l
FRESH WATER	11000 l
DISPLACEMENT	N/A

[see more information about M/Y ZALIV III at www.nauyachts.com](http://www.nauyachts.com)



EXTERIOR MONDOMARINE 50M 2011 MY
ZALIV III

M/Y ZALIV III



EXTERIOR MONDOMARINE 50M 2011 MY
ZALIV III

M/Y ZALIV III



EXTERIOR MONDOMARINE 50M 2011 MY
ZALIV III

M/Y ZALIV III



EXTERIOR MONDOMARINE 50M 2011 MY
ZALIV III

M/Y ZALIV III



SUNDECK DINING AREA

M/Y ZALIV III



SUNDECK JACUZZI

M/Y ZALIV III



SUNDECK DINING AREA

M/Y ZALIV III



FORWARD

M/Y ZALIV III



LEFT SIDE

M/Y ZALIV III



LOUNGE AREA AFT OF THE UPPER DECK

M/Y ZALIV III



LOUNGE AREA AFT OF THE UPPER DECK

M/Y ZALIV III



COCKPIT DINING AREA

M/Y ZALIV III



UPPER SALON

M/Y ZALIV III



MAIN SALON

M/Y ZALIV III



MAIN SALON DINING AREA

M/Y ZALIV III



MASTER CABIN

M/Y ZALIV III



MASTER CABIN

M/Y ZALIV III



STUDY IN THE MASTER STATEROOM

M/Y ZALIV III



MASTER BATHROOM

M/Y ZALIV III



MASTER BATHROOM

M/Y ZALIV III



GUEST CABIN

M/Y ZALIV III



GUEST BATHROOM

M/Y ZALIV III



SWIMMING PLATFORM AND WATER TOYS

M/Y ZALIV III

General Arrangement

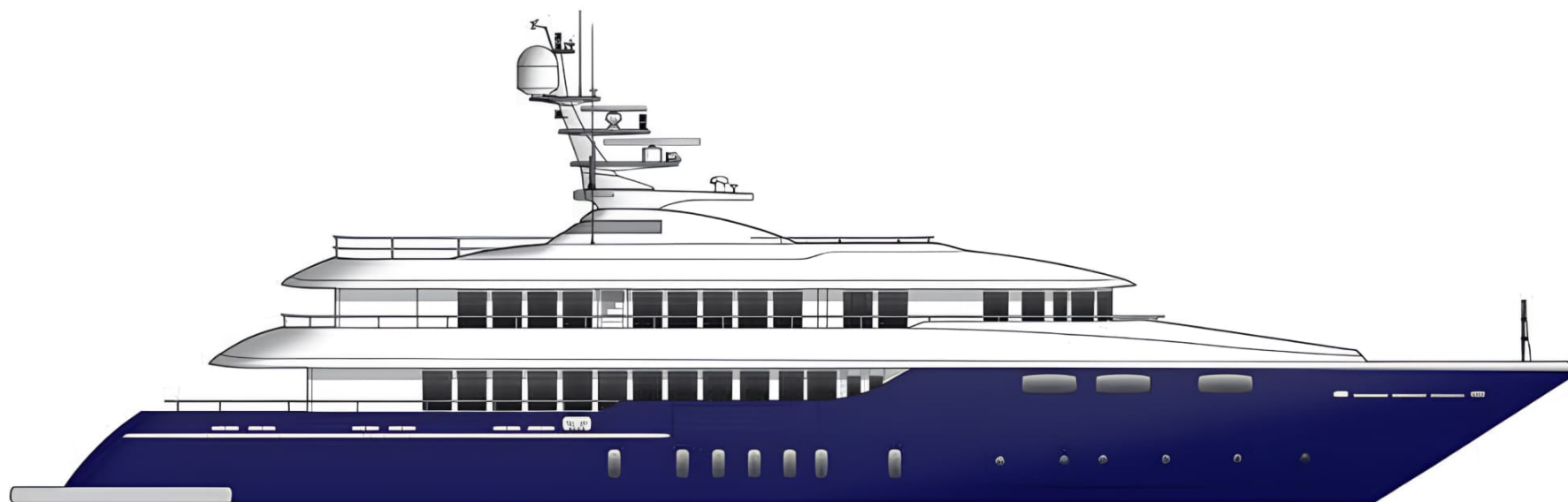

PROFILE

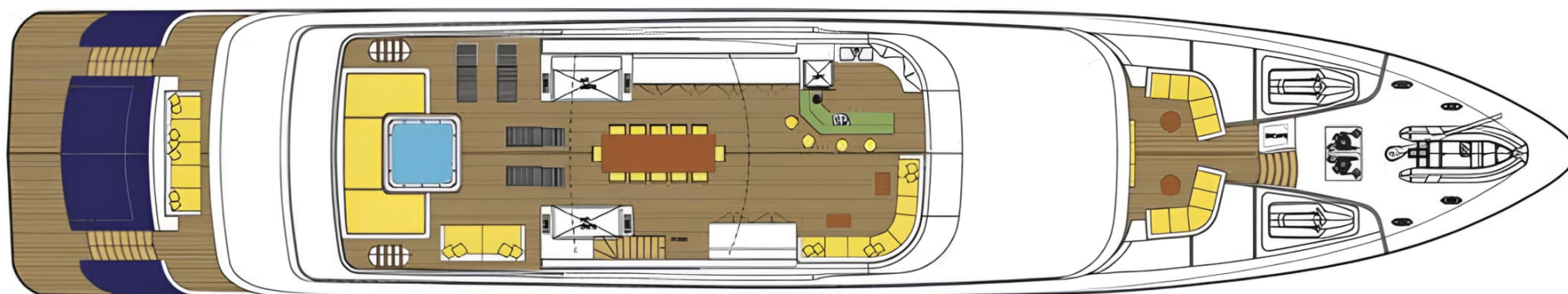

SUNDECK



UPPER DECK

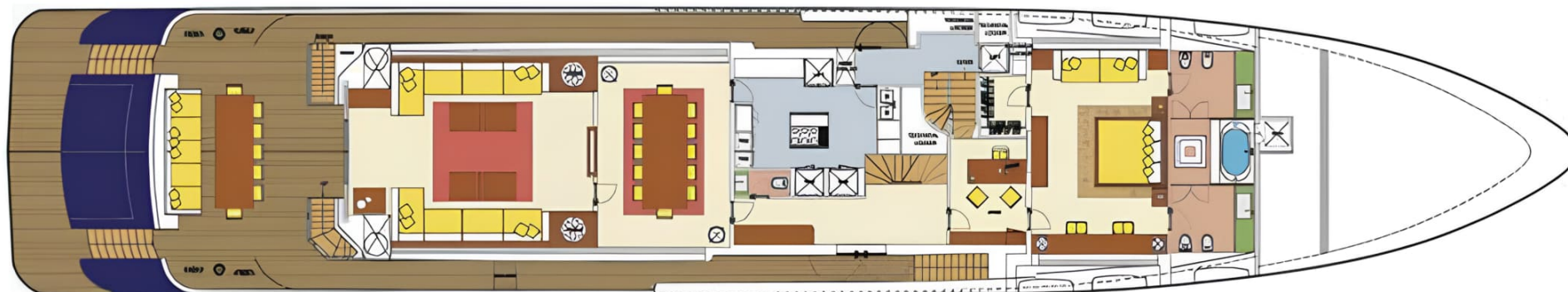

MAIN DECK

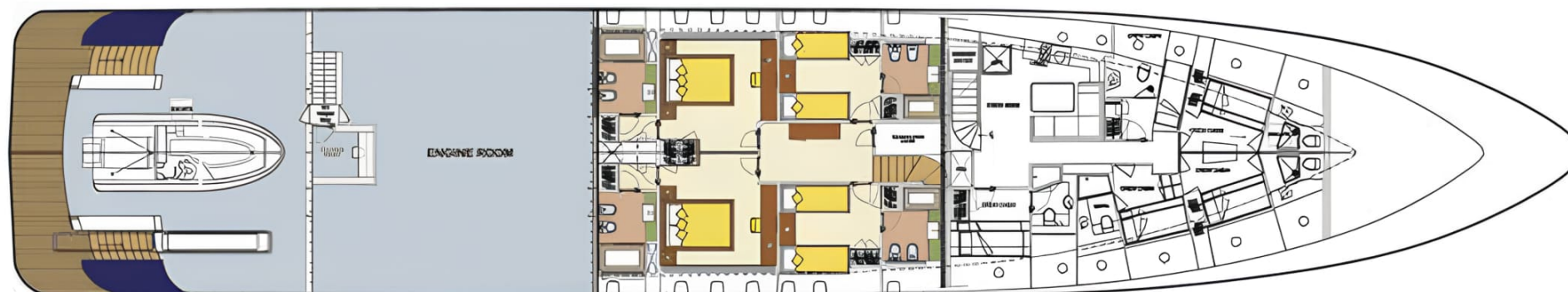

LOWER DECK



KIRILL KUATOV

+377 607 93 15 20

+39 333 576 44 44

 [Send e-mail](#)

 WhatsApp

 Telegram

[More information about M/Y ZALIV III at www.nauyachts.com](#)

[Watch video](#)