



New Build

NAU  
YACHTS

M44 HT

MOTOR YACHT CRANCHI 13.82M 2027

FLAG -

MOTOR YACHT

## M44 HT



**Cranchi M44 HT** is a 13.82-meter sport cruiser designed with a focus on comfort, practicality, and fuel efficiency. The model combines a sleek, recognizable silhouette with a highly functional layout that prioritizes easy handling and relaxed living on board.

One of the standout features of the **M44 HT** is its soft hardtop roof, which easily retracts to transform the enclosed cockpit into an open-air space. This flexibility allows the yacht to adapt to changing weather conditions and guest preferences. The cockpit includes a dining area, a compact galley, and a sun lounger under the retractable roof.

The helm station blends analog and digital instrumentation, offering intuitive control and clear visibility. The refreshed interior, styled by designer Christian Grande, features a light color palette and high-quality finishes. The lower deck accommodates up to five guests in two cabins, each with its own bathroom—an ideal setup for weekend cruises or short family getaways.

Powered by twin Volvo Penta D6-400 diesel engines, the **M44 HT** offers a solid balance of performance and fuel economy. With a 940-liter fuel tank and 300-liter freshwater capacity, it's well-suited for extended coastal trips without frequent stops.

CE-certified in Category B, the yacht is rated for up to 12 people. The **Cranchi M44 HT** is a well-rounded choice for those seeking a stylish, reliable, and well-equipped yacht for family cruising or coastal exploration.

[see more information about M/Y M44 HT at www.nauyachts.com](http://www.nauyachts.com)

# SPECIFICATION

SHIPYARD, MODEL	Cranchi M44 HT
DELIVERY AT THE SHIPYARD	2027
LENGTH	13.82 m
WATERLINE LENGTH	11.99 m
HULL CONFIGURATION	PLANING
BEAM	4 m
RANGE	384
DRAFT	0.96 m
GROSS TONNAGE	N/A
YACHT CLASS	CE (B)
CABINS	2
MASTER CABIN	LOWER DECK
GUESTS	5
BERTHS	5
CREW	N/A
HEADS	3

EXTERIOR DESIGN	CENTRO STUDI RICERCHE CRANCHI
INTERIOR DESIGN	CHRISTIAN GRANDE
HULL	GRP
SUPERSTRUCTURE	GRP
ENGINES	2 x Volvo Penta D6 400 h.p.
TYPE OF DRIVE	VOLVO PENTA IPS
ENGINE HOURS	N/A
MAXIMUM SPEED	35 kn
CRUSING SPEED	27 kn
FUEL CONSUMPTION AT ECONOMICAL SPEED	~ 3.8 l/h
FUEL	940 l
GREY WATER	N/A
BLACK WATER	N/A
FRESH WATER	300 l
DISPLACEMENT	11

[see more information about M/Y M44 HT at www.nauyachts.com](http://www.nauyachts.com)





EXTERIOR CRANCHI M44 HT

M/Y M44 HT





EXTERIOR CRANCHI M44 HT

M/Y M44 HT





EXTERIOR CRANCHI M44 HT

M/Y M44 HT





EXTERIOR CRANCHI M44 HT

M/Y M44 HT





EXTERIOR CRANCHI M44 HT

M/Y M44 HT





EXTERIOR CRANCHI M44 HT

M/Y M44 HT





BOW LOUNGE AREA

M/Y M44 HT





COCKPIT DINING AREA

M/Y M44 HT





MAIN HELM STATION

M/Y M44 HT





MAIN DECK AFT SUNBATHING AREA

M/Y M44 HT





LOWER DECK LOBBY

M/Y M44 HT





LOWER DECK LOBBY

M/Y M44 HT





LOWER DECK LOBBY

M/Y M44 HT





GALLEY

M/Y M44 HT





GALLEY

M/Y M44 HT





VIP CABIN

M/Y M44 HT





VIP BATHROOM

M/Y M44 HT





VIP BATHROOM

M/Y M44 HT





GUEST CABIN

M/Y M44 HT





GUEST CABIN

M/Y M44 HT





GUEST BATHROOM

M/Y M44 HT



# General Arrangement





---

---

MAIN DECK



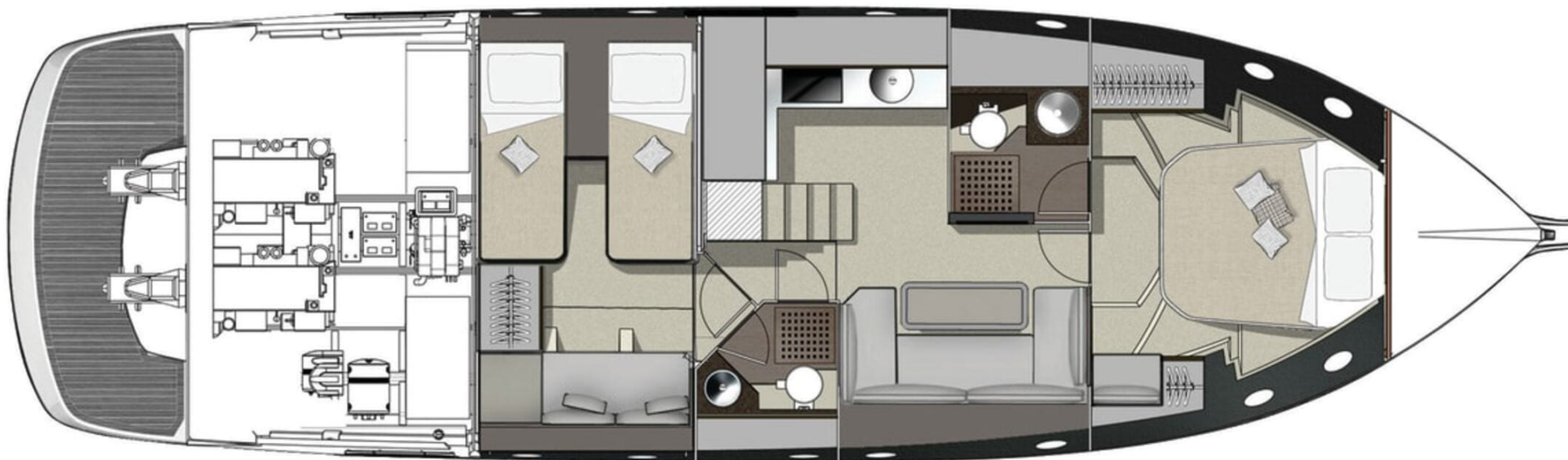

---

---

LOWER DECK





## KIRILL KUATOV

+377 607 93 15 20

+39 333 576 44 44

 [Send e-mail](#)

 WhatsApp

 Telegram

[More information about M/Y M44 HT at www.nauyachts.com](#)

[Watch video](#)