



New Build

NAU
YACHTS

X96 TRIPLEX

MOTOR YACHT EXTRA YACHTS BY ISA 29.26M 2025

FLAG -

MOTOR YACHT

X96 TRIPLEX

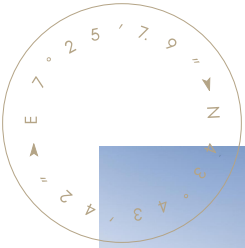

Extra X96 Triplex is a 29.26-meter motor yacht that offers the space and comfort typically found on much larger vessels. Designed by Francesco Guida with interiors by Hot Lab, the yacht accommodates 10 guests in five spacious staterooms, along with crew quarters for five. Built for extended cruising with a range of up to 2,000 nautical miles, she combines performance with luxurious onboard living. The layout of the **X96 Triplex** is crafted to maximize both interior volume and outdoor living. The generous sundeck and upper deck provide multiple open-air lounging and dining areas, ideal for relaxation and socializing. Expansive glass panels and sliding doors connect the inside with the outside, flooding the interiors with natural light and creating a seamless flow between spaces. On the main deck, the open-plan salon blends elegance and functionality, while the full-beam master suite offers panoramic views and refined comfort. Below deck, four guest cabins — two VIPs and two twins, each with en-suite bathrooms — ensure privacy and a high level of accommodation for all guests. Powered by three Volvo IPS 1350 engines, the yacht reaches a cruising speed of 12 knots and a maximum speed of 17.5 knots. Comfort is further enhanced by CMC electric stabilizers, with the option to install a Seakeeper 35 gyro stabilizer. Key features include: fuel capacity: 15,000 liters, two 35 kW generators, a watermaker for long-range autonomy and customizable cabin layout and finishes. With a delivery time of just 16 months from contract signing, the **Extra X96 Triplex** is an ideal choice for discerning owners seeking a stylish and spacious yacht with long-range capabilities and flexible design potential.

[see more information about M/Y X96 TRIPLEX at www.nauyachts.com](http://www.nauyachts.com)

SPECIFICATION

| | |
|--------------------|---------------------------------|
| SHIPYARD, MODEL | Extra Yachts by ISA X96 TRIPLEX |
| BUILT | 2025 |
| LENGTH | 29.26 m |
| WATERLINE LENGTH | 25.76 m |
| HULL CONFIGURATION | SEMI-DISPLACEMENT |
| BEAM | 7.62 m |
| RANGE | 2000 |
| DRAFT | 1.52 m |
| GROSS TONNAGE | 238 GT |
| YACHT CLASS | RINA |
| CABINS | 5+3 |
| MASTER CABIN | MAIN DECK |
| GUESTS | 10 |
| BERTHS | 10+5 |
| CREW | 5 |
| HEADS | 6+3 |

| | |
|--------------------------------------|------------------------------------|
| EXTERIOR DESIGN | PALUMBO SUPERYACHTS GUIDA DESIGN |
| INTERIOR DESIGN | PALUMBO SUPERYACHTS HOTLAB |
| HULL | GRP |
| SUPERSTRUCTURE | GRP |
| ENGINES | 3 x Volvo Penta IPS 1000 h.p. |
| TYPE OF DRIVE | VOLVO PENTA IPS |
| ENGINE HOURS | N/A |
| MAXIMUM SPEED | 17.5 kn |
| CRUISING SPEED | 12 kn |
| FUEL CONSUMPTION AT ECONOMICAL SPEED | N/A |
| FUEL | 15000 l |
| GREY WATER | 500 l |
| BLACK WATER | 500 l |
| FRESH WATER | 2400 l |
| DISPLACEMENT | 135 |

[see more information about M/Y X96 TRIPLEX at www.nauyachts.com](http://www.nauyachts.com)



EXTERIOR EXTRA YACHTS X96 TRIPLEX 2025

M/Y X96 TRIPLEX



EXTERIOR EXTRA YACHTS X96 TRIPLEX 2025

M/Y X96 TRIPLEX



EXTERIOR EXTRA YACHTS X96 TRIPLEX 2025

M/Y X96 TRIPLEX



EXTERIOR EXTRA YACHTS X96 TRIPLEX 2025

M/Y X96 TRIPLEX



EXTERIOR EXTRA YACHTS X96 TRIPLEX 2025

M/Y X96 TRIPLEX



EXTERIOR EXTRA YACHTS X96 TRIPLEX 2025

M/Y X96 TRIPLEX



SUNDECK LOUNGE AREA

M/Y X96 TRIPLEX



SUNDECK LOUNGE AREA

M/Y X96 TRIPLEX



AFT UPPER DECK LOUNGE AREA

M/Y X96 TRIPLEX



AFT UPPER DECK LOUNGE AREA

M/Y X96 TRIPLEX



AFT UPPER DECK LOUNGE AREA

M/Y X96 TRIPLEX



AFT UPPER DECK LOUNGE AREA

M/Y X96 TRIPLEX



AFT MAIN DECK LOUNGE AREA

M/Y X96 TRIPLEX



AFT MAIN DECK LOUNGE AREA

M/Y X96 TRIPLEX



AFT MAIN DECK LOUNGE AREA

M/Y X96 TRIPLEX



AFT MAIN DECK DINING AREA

M/Y X96 TRIPLEX



EXTERIOR EXTRA YACHTS X96 TRIPLEX 2025

M/Y X96 TRIPLEX



EXTERIOR EXTRA YACHTS X96 TRIPLEX 2025

M/Y X96 TRIPLEX



SWIMMING PLATFORM

M/Y X96 TRIPLEX



MAIN SALON LOUNGE AREA

M/Y X96 TRIPLEX



MAIN SALON LOUNGE AREA

M/Y X96 TRIPLEX



MAIN SALON LOUNGE AREA

M/Y X96 TRIPLEX



MAIN SALON DINING AREA

M/Y X96 TRIPLEX



MAIN SALON DINING AREA

M/Y X96 TRIPLEX



MAIN SALON DINING AREA

M/Y X96 TRIPLEX



OFFICE IN THE MASTER CABIN

M/Y X96 TRIPLEX



MASTER CABIN

M/Y X96 TRIPLEX



MASTER CABIN

M/Y X96 TRIPLEX



MASTER CABIN

M/Y X96 TRIPLEX



MASTER BATHROOM

M/Y X96 TRIPLEX



GALLEY

M/Y X96 TRIPLEX



GALLEY

M/Y X96 TRIPLEX



GUEST CABIN

M/Y X96 TRIPLEX



VIP CABIN

M/Y X96 TRIPLEX



VIP BATHROOM

M/Y X96 TRIPLEX



MAIN HELM STATION

M/Y X96 TRIPLEX



ENGINE ROOM

M/Y X96 TRIPLEX

General Arrangement

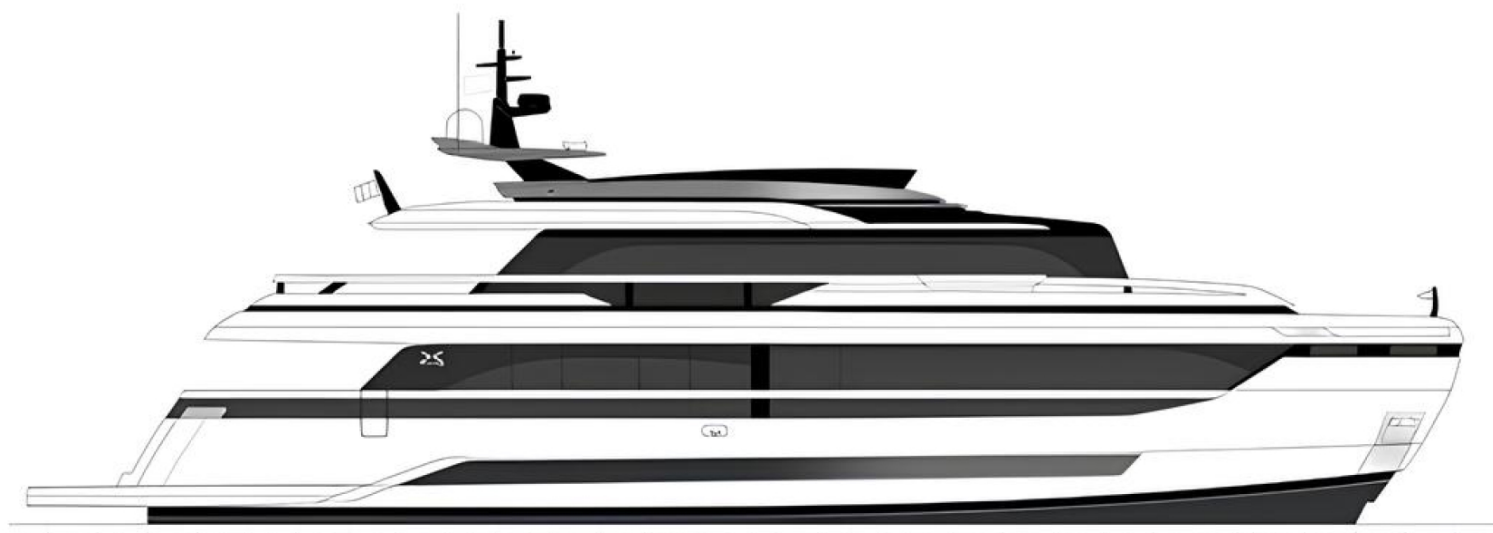

PROFILE

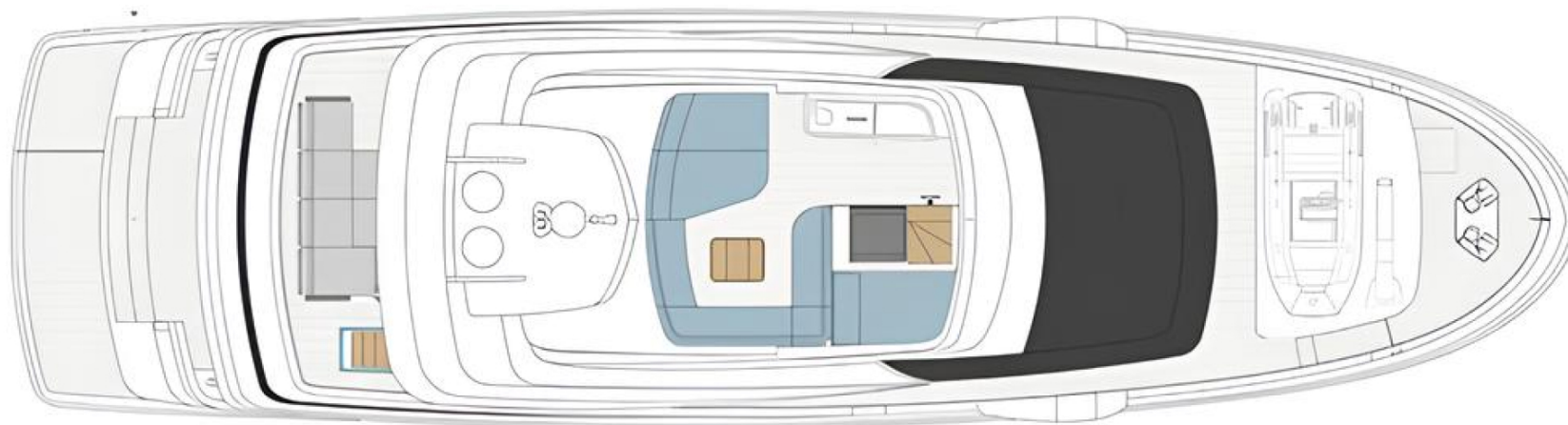

SUNDECK

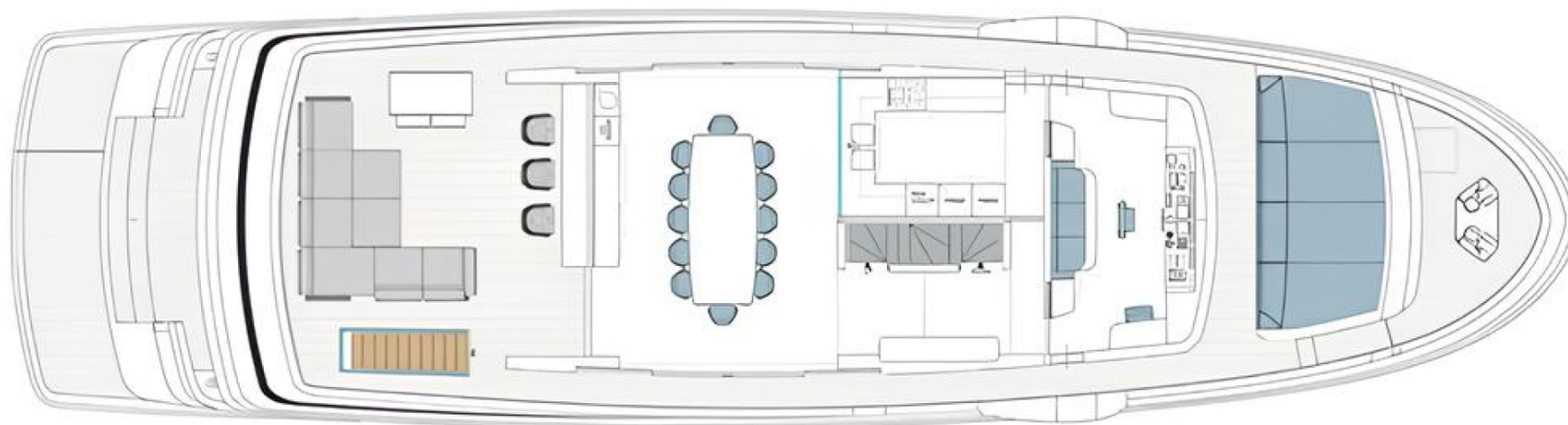

UPPER DECK

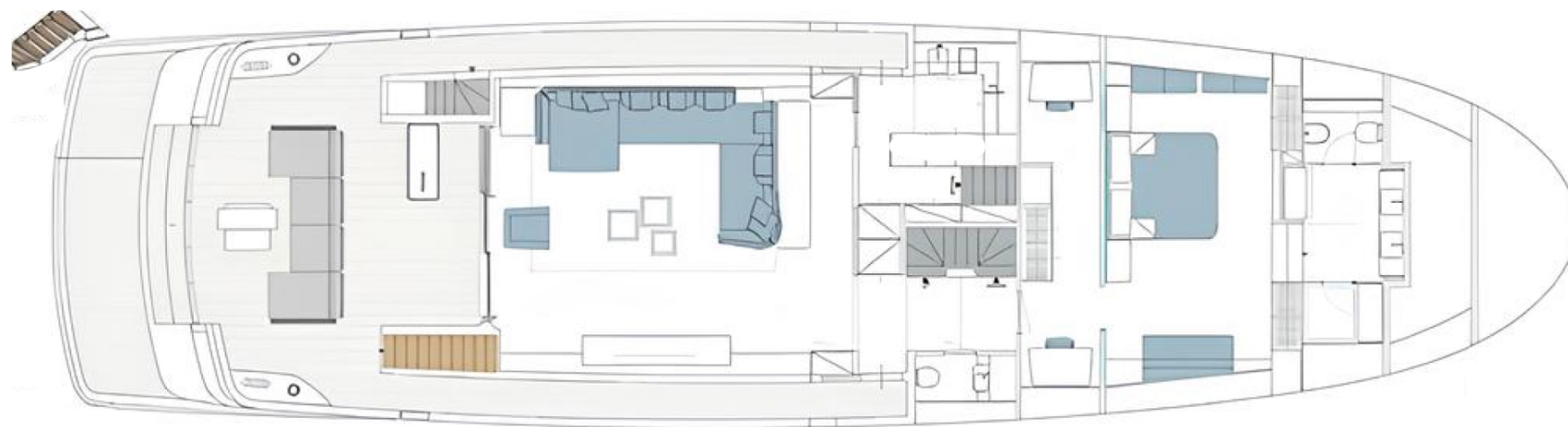

MAIN DECK



LOWER DECK



KIRILL KUATOV

+377 607 93 15 20

+39 333 576 44 44

 [Send e-mail](#)

 WhatsApp

 Telegram

[More information about M/Y X96 TRIPLEX at www.nauyachts.com](#)

[Watch video](#)