



Brokerage

NAU  
YACHTS

LADY MARINA

MOTOR YACHT    LEADSHIP 63.95M    1999

€39,950,000 (VAT  
paid)  
FLAG - CAYMAN ISLANDS

MOTOR YACHT

## LADY MARINA

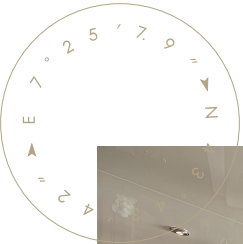

**LADY MARINA** is a 63.95-meter full-displacement motor yacht built by **Feadship** in 1999, with exterior design by De Voogt Naval Architects and interiors by Donald Starkey. Custom-built for an experienced owner with a vision for extended family world cruising, she offers robust ocean-going capability and timeless elegance. Constructed with a steel hull and aluminum superstructure, **LADY MARINA** was designed for full transoceanic autonomy and optimal seaworthiness. Her technical excellence was recognized with the International Superyacht Society Award for Best Power Yacht Over 43 Metres in 2000.

A major refit was completed in 2020, and the yacht is maintained in excellent technical and aesthetic condition. She accommodates up to 12 guests in six staterooms, including a spacious owner's suite, with three additional cabins available for personal staff or VIP guests. Crew quarters are extensive, supporting up to 18 crew members, with dedicated cabins for the captain and chief engineer.

Key features include an elevator serving all decks and a certified helipad, significantly expanding operational flexibility for remote cruising and guest transfers. Expansive exterior areas include sunbathing spaces, al fresco dining zones, and multiple lounging areas, ideal for both private relaxation and entertaining.

Powered by twin Caterpillar 3516 diesel engines (2,000 hp each), **LADY MARINA** cruises comfortably at 12.5 knots, reaches a top speed of 14.5 knots, and boasts a transatlantic range of up to 5,500 nautical miles. Her fuel capacity of 201,000 liters supports long-range autonomy without compromising comfort or safety.

Now offered for sale, **LADY MARINA** presents a rare opportunity to acquire a pedigree Northern European yacht with proven capability, elegant design, and enduring value — an ideal platform for long-distance cruising in complete comfort and style.

see more information about M/Y LADY MARINA at [www.nauyachts.com](http://www.nauyachts.com)

# SPECIFICATION

SHIPYARD, MODEL	Feadship 64M
BUILT	1999
LENGTH	63.95 m
WATERLINE LENGTH	58.71 m
HULL CONFIGURATION	DISPLACEMENT
BEAM	10.8 m
RANGE	5500
DRAFT	3.45 m
GROSS TONNAGE	1279 GT
YACHT CLASS	LLOYD'S
CABINS	6+9
MASTER CABIN	MAIN DECK
GUESTS	12
BERTHS	12+18
CREW	18
HEADS	8+9

EXTERIOR DESIGN	DONALD STARKEY
INTERIOR DESIGN	DONALD STARKEY
HULL	STEEL
SUPERSTRUCTURE	ALUMINIUM
ENGINES	2 x CAT 3516 2000 h.p.
TYPE OF DRIVE	SHAFT LINE
ENGINE HOURS	N/A
MAXIMUM SPEED	14.5 kn
CRUISING SPEED	12.5 kn
FUEL CONSUMPTION AT ECONOMICAL SPEED	N/A
FUEL	201000 l
GREY WATER	N/A
BLACK WATER	N/A
FRESH WATER	42600 l
DISPLACEMENT	1000

[see more information about M/Y LADY MARINA at www.nauyachts.com](http://www.nauyachts.com)





EXTERIOR FEADSHIP 64M 1999 MY LADY  
MARINA

M/Y LADY MARINA





AFT UPPER DECK LOUNGE AREA

M/Y LADY MARINA





BOW LOUNGE AREA

M/Y LADY MARINA





BOW LOUNGE AREA

M/Y LADY MARINA





UPPER DECK SALOON

M/Y LADY MARINA





UPPER DECK SALOON

M/Y LADY MARINA





MAIN SALON LOUNGE AREA

M/Y LADY MARINA





MAIN SALON DINING AREA

M/Y LADY MARINA





MASTER CABIN

M/Y LADY MARINA





MASTER CABIN LOUNGE AREA

M/Y LADY MARINA





OFFICE IN THE MASTER CABIN

M/Y LADY MARINA





VIP CABIN

M/Y LADY MARINA





GUEST CABIN

M/Y LADY MARINA





GYM

M/Y LADY MARINA





MASSAGE ROOM

M/Y LADY MARINA





MAIN HELM STATION

M/Y LADY MARINA





ENGINE ROOM

M/Y LADY MARINA



# General Arrangement



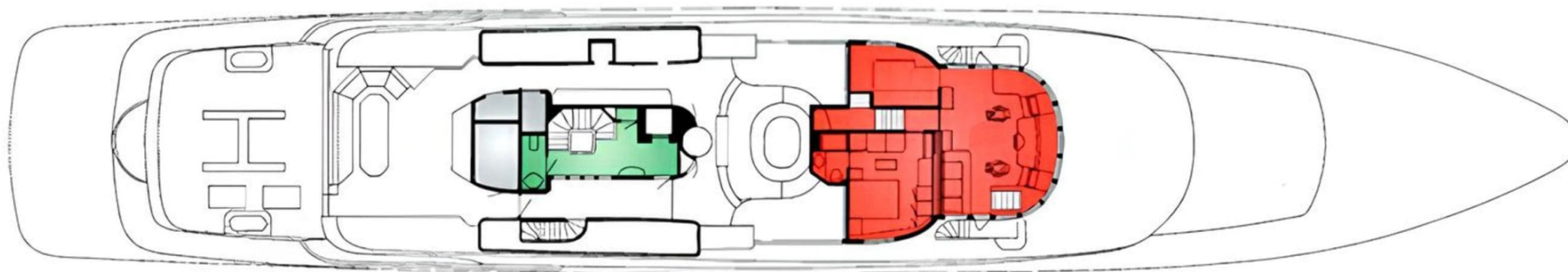

SUNDECK



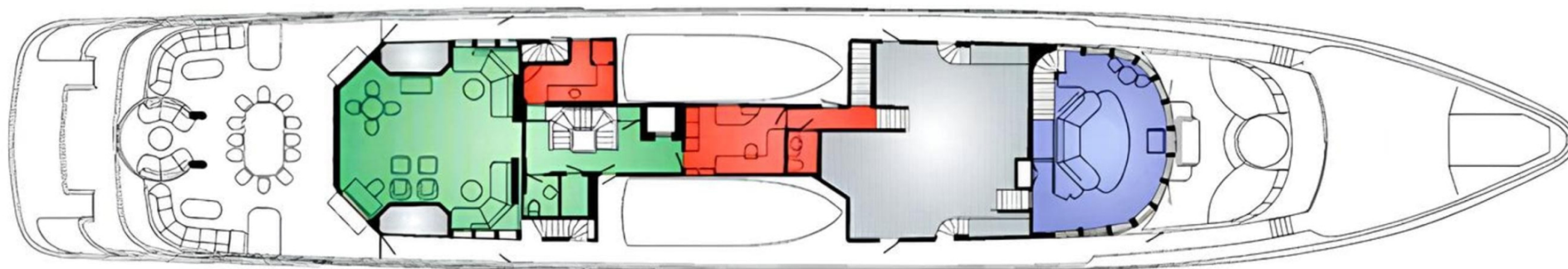

UPPER DECK





MAIN DECK





LOWER DECK





## KIRILL KUATOV

+377 607 93 15 20

+39 333 576 44 44

 [Send e-mail](#)

 WhatsApp

 Telegram

[More information about M/Y LADY MARINA at www.nauyachts.com](#)

[Watch video](#)