



Brokerage

NAU  
YACHTS

SOMNIUM

MOTOR YACHT    LEADSHIP 55.2M    2021

€62,500,000 (VAT  
paid)

FLAG - MALTA

MOTOR YACHT

## SOMNIUM

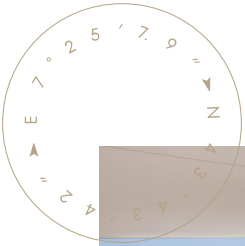

**SOMNIUM** is a 55-meter full-custom motor yacht built entirely in aluminum by **Feadship** and launched in 2021. Representing the highest standard of Northern European craftsmanship, **SOMNIUM** offers a rare opportunity to acquire a nearly new Feadship without the wait of a multi-year build process.

Designed by Studio De Voogt in collaboration with FM Architettura, the yacht features a sleek, contemporary silhouette with clean lines and a carefully curated interior that combines elegant design with premium materials. Her all-aluminum construction ensures reduced weight, improved fuel efficiency, and a shallow draft - ideal for cruising shallow waters like the Bahamas or the Southern Tyrrhenian Sea.

**SOMNIUM's** exterior areas are designed to support both relaxation and an active lifestyle. She features a jacuzzi on the sundeck, a private forward lounge, and an aft-deck swimming pool with a counter-current system. A fold-down swim platform connects directly to a fully equipped gym, creating a seamless wellness space at sea level. A tender garage includes dedicated storage for diving equipment.

The full-beam owner's stateroom is located forward on the main deck and includes a private office and a fold-out balcony. Four guest staterooms are located on the lower deck, each designed for maximum privacy and comfort. Crew and service areas have been optimized for professional operation, including a spacious galley and state-of-the-art support facilities.

Powered by twin MTU diesel engines, **SOMNIUM** reaches a top speed of 15.4 knots and cruises comfortably at 12 knots, with a transoceanic range of 5,000 nautical miles. She is equipped with modern stabilization systems, the latest navigation electronics, and is built to Lloyd's Register and MCA standards.

**SOMNIUM** offers an exceptional balance of cutting-edge technology, sophisticated design, and operational efficiency. With minimal engine hours and no need for additional outfitting, she is fully prepared for global exploration - a truly turnkey Northern European pedigree yacht.

[see more information about M/Y SOMNIUM at www.nauyachts.com](http://www.nauyachts.com)

# SPECIFICATION

SHIPYARD, MODEL	Feadship 55M
BUILT	2021
LENGTH	55.2 m
WATERLINE LENGTH	48.8 m
HULL CONFIGURATION	DISPLACEMENT
BEAM	9.8 m
RANGE	4970
DRAFT	2.65 m
GROSS TONNAGE	744 GT
YACHT CLASS	BUREAU VERITAS
CABINS	5+3
MASTER CABIN	MAIN DECK
GUESTS	12
BERTHS	12+6
CREW	6
HEADS	7+3

EXTERIOR DESIGN	DE VOOGT NAVAL ARCHITECTS
INTERIOR DESIGN	FM ARCHITETTURA
HULL	ALUMINUM
SUPERSTRUCTURE	ALUMINIUM
ENGINES	2 x MTU 10V2000 1206 h.p.
TYPE OF DRIVE	SHAFT LINE
ENGINE HOURS	N/A
MAXIMUM SPEED	15.4 kn
CRUSING SPEED	12 kn
FUEL CONSUMPTION AT ECONOMICAL SPEED	N/A
FUEL	66500 l
GREY WATER	5000 l
BLACK WATER	5000 l
FRESH WATER	14500 l
DISPLACEMENT	N/A

[see more information about M/Y SOMNIUM at www.nauyachts.com](http://www.nauyachts.com)



EXTERIOR FEADSHIP 55M 2021 MY SOMNIUM

M/Y SOMNIUM



EXTERIOR FEADSHIP 55M 2021 MY SOMNIUM

M/Y SOMNIUM



EXTERIOR FEADSHIP 55M 2021 MY SOMNIUM

M/Y SOMNIUM



EXTERIOR FEADSHIP 55M 2021 MY SOMNIUM

M/Y SOMNIUM



EXTERIOR FEADSHIP 55M 2021 MY SOMNIUM

M/Y SOMNIUM



EXTERIOR FEADSHIP 55M 2021 MY SOMNIUM

M/Y SOMNIUM



EXTERIOR FEADSHIP 55M 2021 MY SOMNIUM

M/Y SOMNIUM



EXTERIOR FEADSHIP 55M 2021 MY SOMNIUM

M/Y SOMNIUM



SUNDECK LOUNGE AREA

M/Y SOMNIUM



SUNDECK LOUNGE AREA

M/Y SOMNIUM



BOW LOUNGE AREA

M/Y SOMNIUM



AFT UPPER DECK DINING AREA

M/Y SOMNIUM



AFT AREA

M/Y SOMNIUM



FOLDING STARBOARD BALCONY

M/Y SOMNIUM

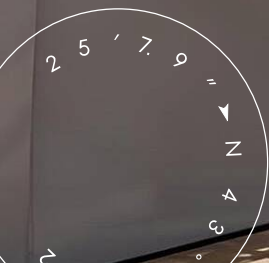

## SWIMMING PLATFORM

M/Y SOMNIUM



BEACH CLUB

M/Y SOMNIUM



UPPER DECK SALOON

M/Y SOMNIUM



MAIN SALON LOUNGE AREA

M/Y SOMNIUM



MASTER CABIN

M/Y SOMNIUM



MASTER CABIN LOUNGE AREA

M/Y SOMNIUM



OFFICE IN THE MASTER CABIN

M/Y SOMNIUM



VIP CABIN

M/Y SOMNIUM



VIP CABIN

M/Y SOMNIUM

# General Arrangement

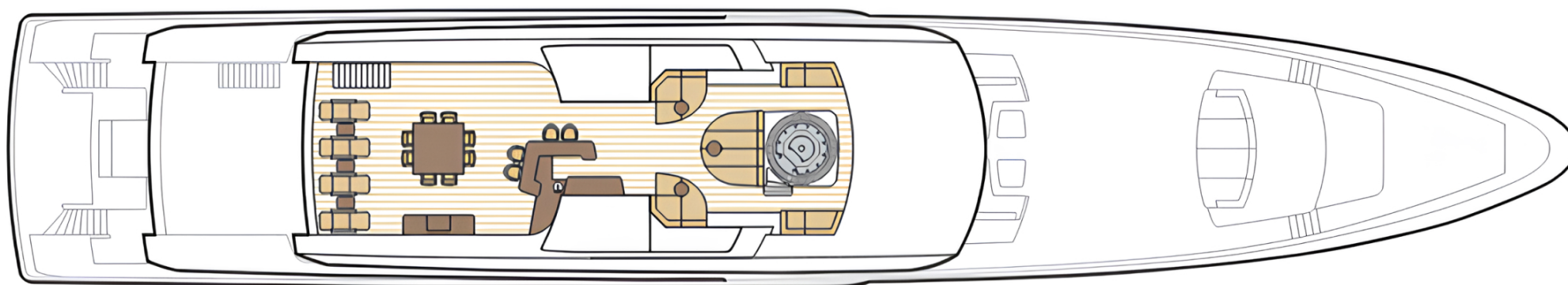

SUNDECK

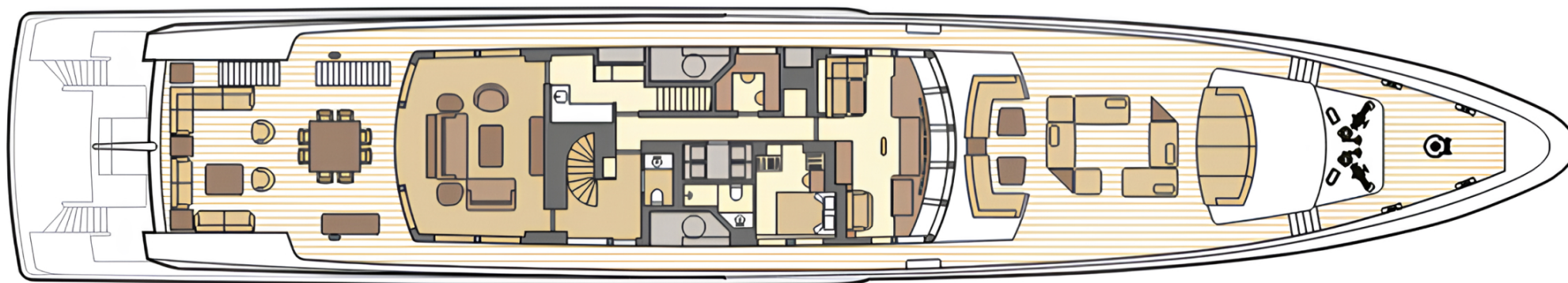

UPPER DECK

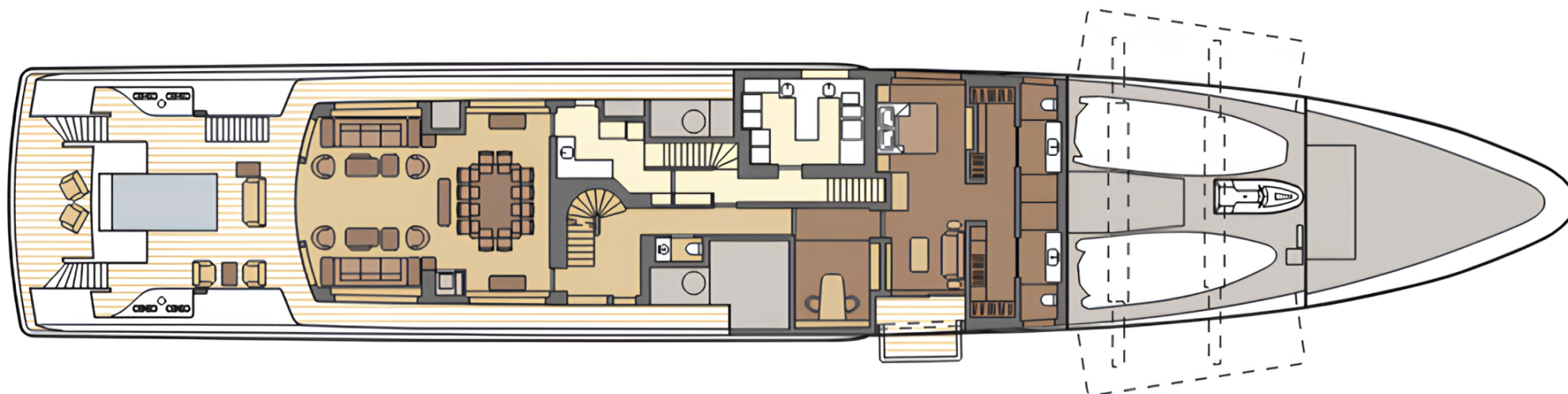

MAIN DECK



LOWER DECK



KIRILL KUATOV

+377 607 93 15 20

+39 333 576 44 44

 [Send e-mail](#)

 WhatsApp

 Telegram

[More information about M/Y SOMNIUM at www.nauyachts.com](http://www.nauyachts.com)

[Watch video](#)