



Brokerage

NAU
YACHTS

VISION

MOTOR YACHT BENETTI 60M 2011

€29,500,000
FLAG - CAYMAN ISLAND

MOTOR YACHT

VISION

VISION is a 60-meter motor yacht built by **Benetti**, featuring an exterior by Stefano Natucci and interiors by Pierre-Yves Rochon. Launched in 2011 and refitted in 2021, she is in excellent condition and ready for immediate use. Her striking blue hull and light-colored superstructure create a modern, elegant profile, while her robust technical specifications and transoceanic range make her ideal for extended voyages worldwide.

Accommodation is provided for 12 guests in 6 cabins, including a two-level full-beam master suite on the main deck, with four guest cabins located on the lower deck, all with en-suite facilities.

Spacious exterior decks include a large sundeck, beach club, multiple lounges and dining areas, as well as a touch-and-go helipad.

Powered by two MTU 12V 4000 M60 engines (1,770 hp each) with zero-speed stabilizers, **VISION** cruises at 13.5 knots, reaches a maximum speed of 16.5 knots, and offers a range of 8,430 nautical miles at economical speed. She is perfectly equipped for long-range cruising, combining expansive outdoor spaces, a comfortable layout, and a reliable technical platform.



[see more information about M/Y VISION at www.nauyachts.com](http://www.nauyachts.com)

SPECIFICATION

SHIPYARD, MODEL	Benetti 60M
BUILT	2011
LENGTH	60 m
WATERLINE LENGTH	50.6 m
HULL CONFIGURATION	SEMI-DISPLACEMENT
BEAM	10.4 m
RANGE	6200
DRAFT	3.4 m
GROSS TONNAGE	1008 GT
YACHT CLASS	LLOYD'S
CABINS	6+8
MASTER CABIN	MAIN DECK
GUESTS	12
BERTHS	12+15
CREW	15
HEADS	8+8

EXTERIOR DESIGN	STEFANO NATUCCI
INTERIOR DESIGN	PIERRE-YVES ROCHON
HULL	STEEL
SUPERSTRUCTURE	ALUMINIUM
ENGINES	2 x MTU 12V 4000 M60 1770 h.p.
TYPE OF DRIVE	SHAFT LINE
ENGINE HOURS	7307 h
MAXIMUM SPEED	16.5 kn
CRUISING SPEED	13.5 kn
FUEL CONSUMPTION AT ECONOMICAL SPEED	~ 283 l/h
FUEL	130000 l
GREY WATER	N/A
BLACK WATER	N/A
FRESH WATER	20000 l
DISPLACEMENT	826

[see more information about M/Y VISION at www.nauyachts.com](http://www.nauyachts.com)



EXTERIOR BENETTI 60M 2011 MY VISION

M/Y VISION



EXTERIOR BENETTI 60M 2011 MY VISION

M/Y VISION



EXTERIOR BENETTI 60M 2011 MY VISION

M/Y VISION



EXTERIOR BENETTI 60M 2011 MY VISION

M/Y VISION



EXTERIOR BENETTI 60M 2011 MY VISION

M/Y VISION



EXTERIOR BENETTI 60M 2011 MY VISION

M/Y VISION



EXTERIOR BENETTI 60M 2011 MY VISION

M/Y VISION



EXTERIOR BENETTI 60M 2011 MY VISION

M/Y VISION



STARBOARD

M/Y VISION



SUNDECK LOUNGE AREA

M/Y VISION



SUNDECK JACUZZI

M/Y VISION



SUNDECK LOUNGE AREA

M/Y VISION



SUNDECK LOUNGE AREA

M/Y VISION



AFT UPPER DECK LOUNGE AREA

M/Y VISION



AFT UPPER DECK LOUNGE AREA

M/Y VISION



AFT UPPER DECK LOUNGE AREA

M/Y VISION



AFT MAIN DECK LOUNGE AREA

M/Y VISION



AFT MAIN DECK LOUNGE AREA

M/Y VISION



BEACH CLUB

M/Y VISION



BEACH CLUB

M/Y VISION



MAIN SALON LOUNGE AREA

M/Y VISION



MAIN SALON LOUNGE AREA

M/Y VISION



MAIN SALON LOUNGE AREA

M/Y VISION



MAIN SALON DINING AREA

M/Y VISION



MAIN SALON DINING AREA

M/Y VISION



MASTER CABIN LOUNGE AREA

M/Y VISION



OFFICE IN THE MASTER CABIN

M/Y VISION



MASTER CABIN

M/Y VISION



MASTER BATHROOM

M/Y VISION



MASTER BATHROOM

M/Y VISION



MASTER BATHROOM

M/Y VISION



VIP CABIN

M/Y VISION



VIP CABIN

M/Y VISION



VIP CABIN

M/Y VISION



VIP BATHROOM

M/Y VISION



VIP BATHROOM

M/Y VISION



GUEST CABIN

M/Y VISION



UPPER DECK SALOON

M/Y VISION



UPPER DECK SALOON

M/Y VISION



UPPER DECK SALOON

M/Y VISION



UPPER DECK SALOON

M/Y VISION



MAIN HELM STATION

M/Y VISION



MASSAGE ROOM

M/Y VISION



MASSAGE ROOM

M/Y VISION

General Arrangement

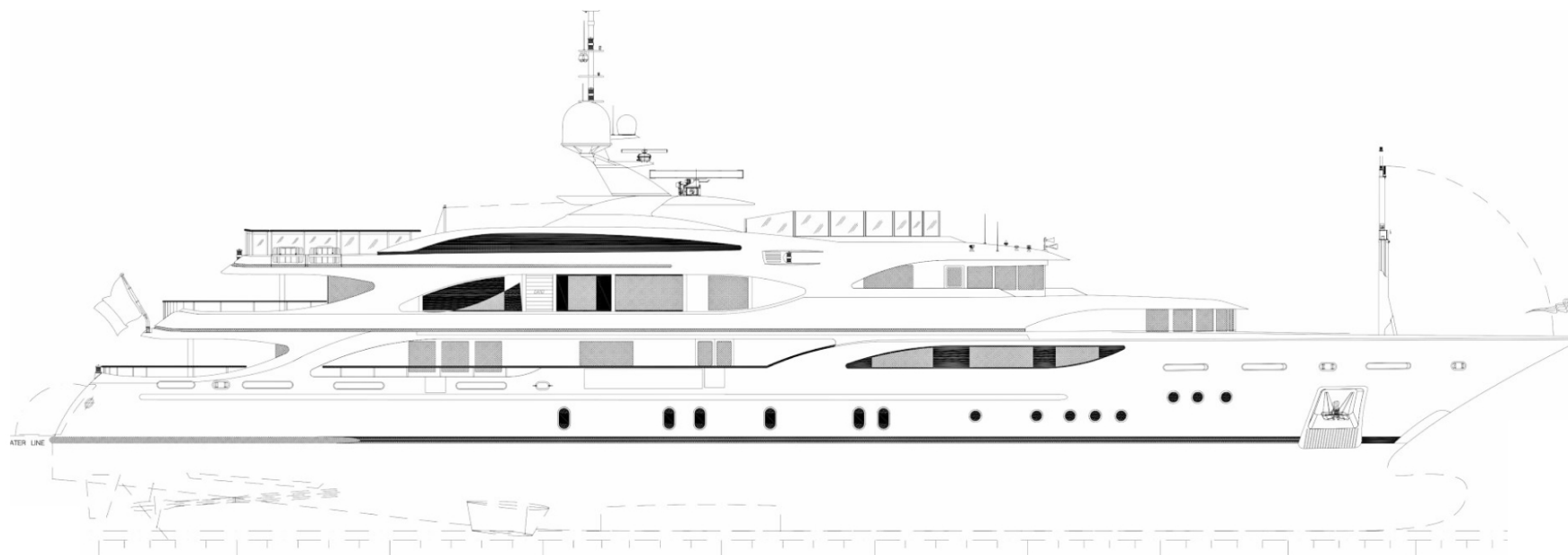

PROFILE

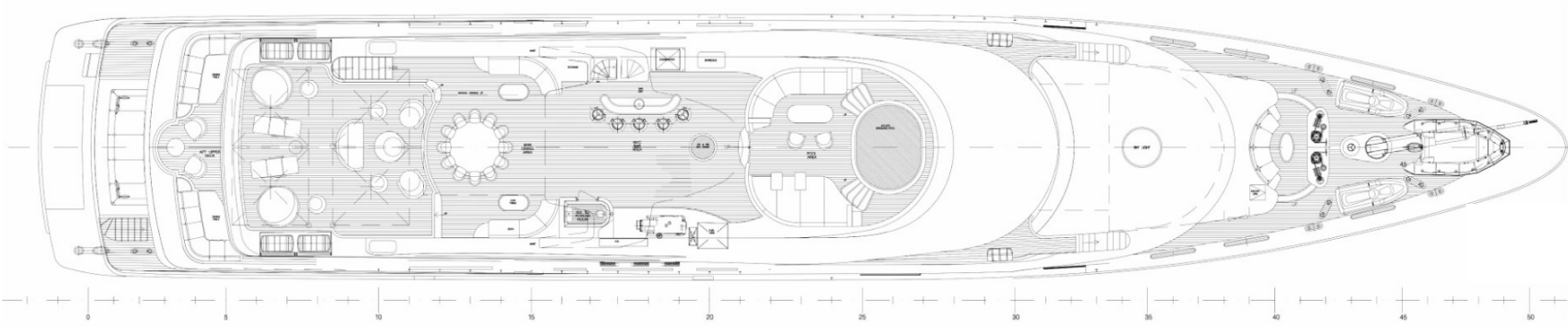

SUNDECK

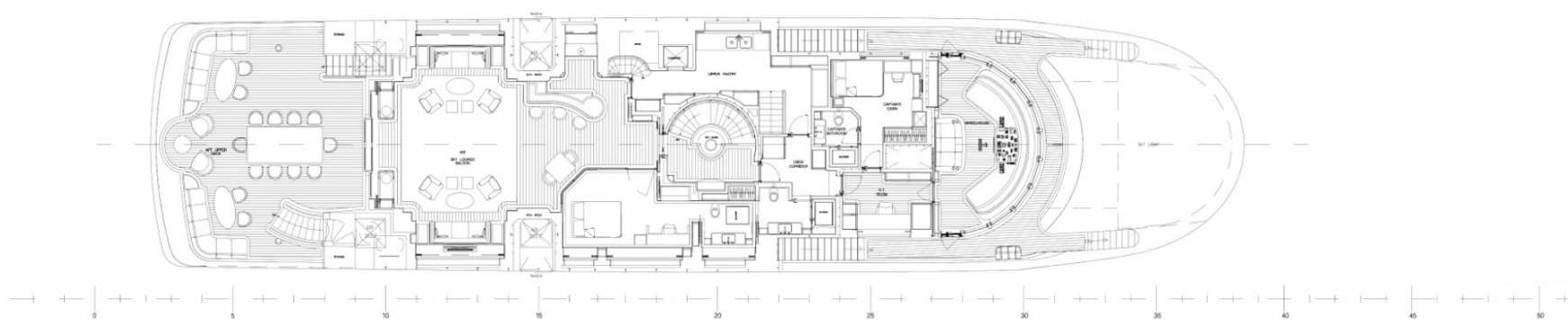

UPPER DECK

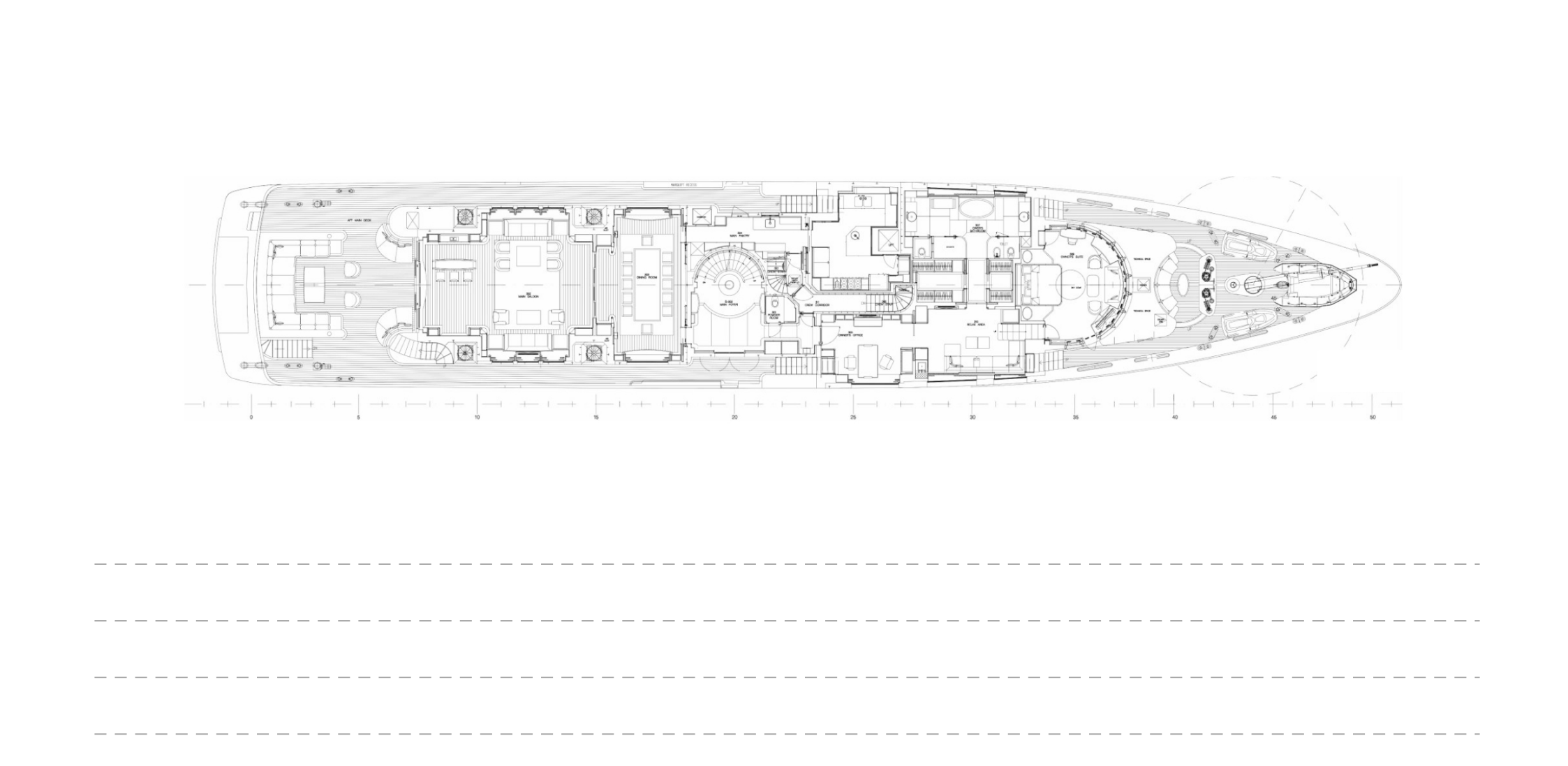

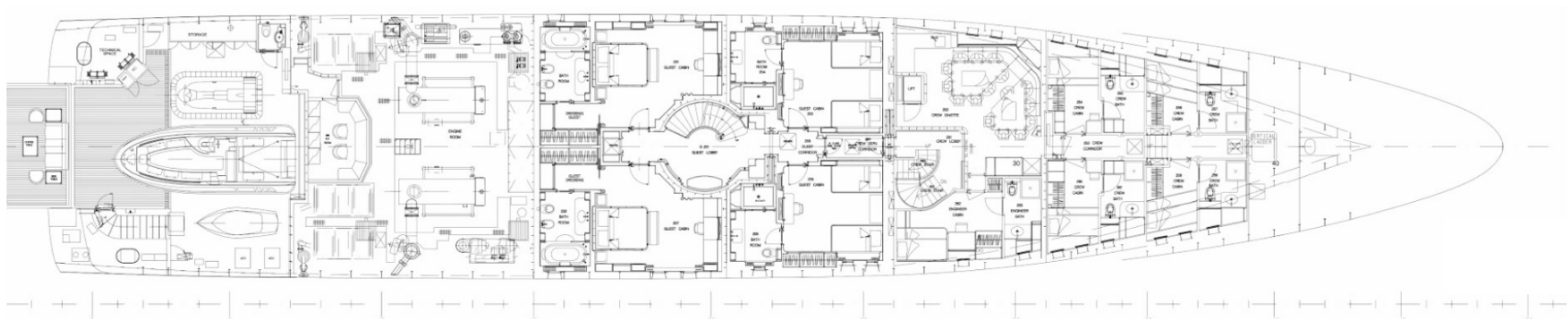

LOWER DECK



KIRILL KUATOV

+377 607 93 15 20

+39 333 576 44 44

 [Send e-mail](#)

 WhatsApp

 Telegram