



Brokerage

NAU  
YACHTS

FLORENTIA

MOTOR YACHT ROSSINAVI 52M 2020

€41,000,000  
FLAG - CAYMAN ISLANDS

MOTOR YACHT

# FLORENTIA



**FLORENTIA** is a 52-meter full displacement motor yacht built by **Rossinavi** in 2020. The yacht is in excellent condition and combines Italian craftsmanship, modern technology, and functional design. The exterior and interior are designed with an emphasis on comfort and convenience for owners and guests.

The yacht accommodates up to 12 guests in six cabins, including a master cabin on the main deck with a private balcony and two walk-in closets, a VIP cabin on the sundeck, and two double cabins on the lower deck. There are 11 berths for the crew in six cabins, ensuring comfortable service.

The interior by Carlo Colombo is decorated using natural forms and materials, while large windows and high ceilings create a feeling of space and light. The height of the main deck saloon and master cabin is 2.35 m, while the sky lounge and VIP cabin are 2.2 and 2.15 m high, respectively.

The yacht is equipped with two CAT 3512C engines, each with 1,500 hp, and has a maximum speed of 17 knots and a cruising speed of 13.5 knots, with a range of 3,500 nautical miles at 12 knots. Dual DUALIS bow and stern thrusters, STABILIS LR200 stabilizers, and a modern navigation system ensure stable and safe sailing. The package includes two Castoldi tenders and two Sea-Doo GTX 500 jet skis. Classified by Lloyd's Register and compliant with MCA standards, **FLORENTIA** is ready for long cruises and transoceanic voyages.

[see more information about M/Y FLORENTIA at www.nauyachts.com](http://www.nauyachts.com)

# SPECIFICATION

SHIPYARD, MODEL	Rossinavi 52M
BUILT	2020
LENGTH	52 m
WATERLINE LENGTH	48.73 m
HULL CONFIGURATION	DISPLACEMENT
BEAM	10.35 m
RANGE	3500
DRAFT	2.7 m
GROSS TONNAGE	810 GT
YACHT CLASS	LLOYD'S
CABINS	6+5
MASTER CABIN	MAIN DECK
GUESTS	12
BERTHS	12+10
CREW	10
HEADS	7+5

EXTERIOR DESIGN	STUDIO VAFADIS
INTERIOR DESIGN	A++ CARLO COLOMBO
HULL	STEEL
SUPERSTRUCTURE	ALUMINIUM
ENGINES	2 x CAT 3512C 1500 h.p.
TYPE OF DRIVE	SHAFT LINE
ENGINE HOURS	1160 h
MAXIMUM SPEED	17.5 kn
CRUSING SPEED	13.5 kn
FUEL CONSUMPTION AT ECONOMICAL SPEED	N/A
FUEL	100740 l
GREY WATER	1900 l
BLACK WATER	9000 l
FRESH WATER	12000 l
DISPLACEMENT	729

[see more information about M/Y FLORENTIA at www.nauyachts.com](http://www.nauyachts.com)





EXTERIOR ROSSINAVI 52M 2020 MY  
FLORENTIA

M/Y FLORENTIA





SUNDECK JACUZZI

M/Y FLORENTIA





SUNDECK JACUZZI

M/Y FLORENTIA





AFT UPPER DECK DINING AREA

M/Y FLORENTIA





AFT UPPER DECK LOUNGE AREA

M/Y FLORENTIA





BOW LOUNGE AREA

M/Y FLORENTIA





AFT MAIN DECK LOUNGE AREA

M/Y FLORENTIA





AFT AREA

M/Y FLORENTIA





GARAGE

M/Y FLORENTIA





UPPER DECK SALOON

M/Y FLORENTIA





UPPER DECK SALOON

M/Y FLORENTIA





MAIN SALON LOUNGE AREA

M/Y FLORENTIA





MAIN SALON LOUNGE AREA

M/Y FLORENTIA





MAIN SALON DINING AREA

M/Y FLORENTIA





MAIN SALON LOBBY

M/Y FLORENTIA





MASTER CABIN

M/Y FLORENTIA





MASTER CABIN

M/Y FLORENTIA





MAKE-UP TABLE IN MASTER CABIN

M/Y FLORENTIA





VIP CABIN

M/Y FLORENTIA





VIP CABIN

M/Y FLORENTIA





GUEST CABIN

M/Y FLORENTIA





GUEST CABIN

M/Y FLORENTIA



# General Arrangement





PROFILE



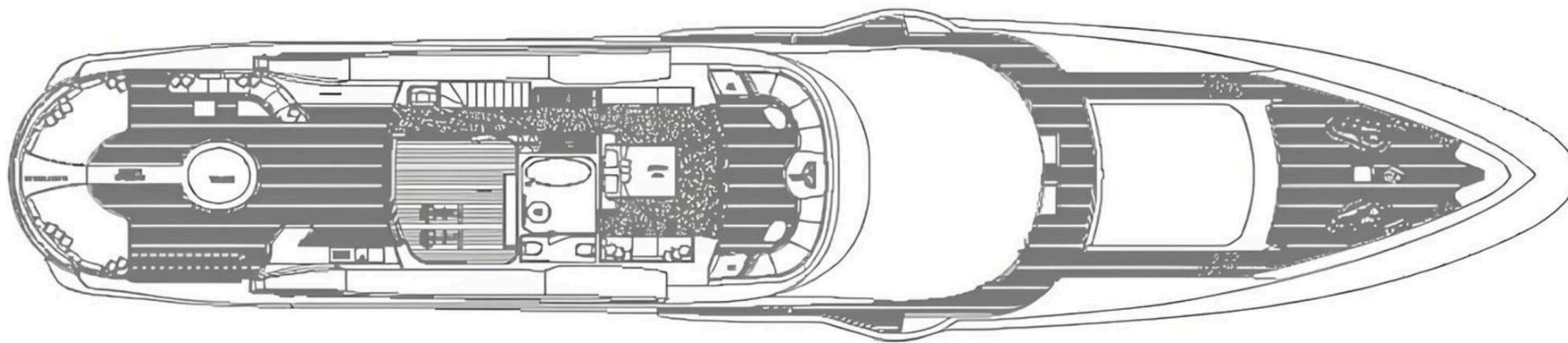

SUNDECK



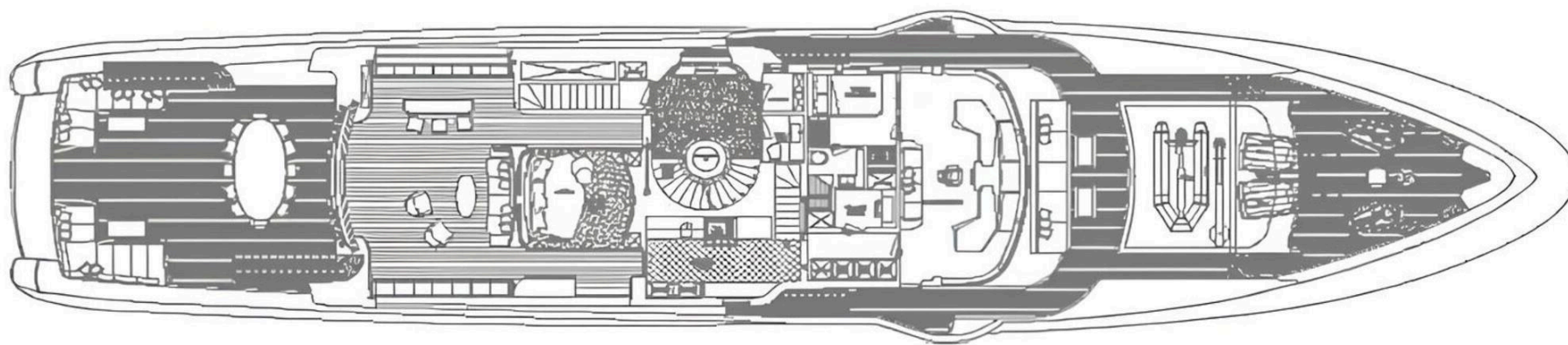

UPPER DECK



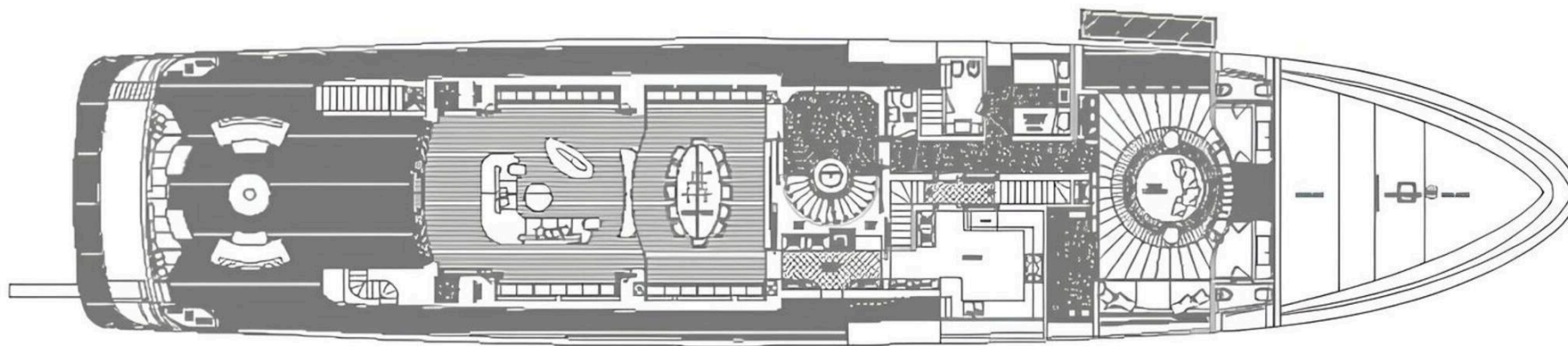

MAIN DECK



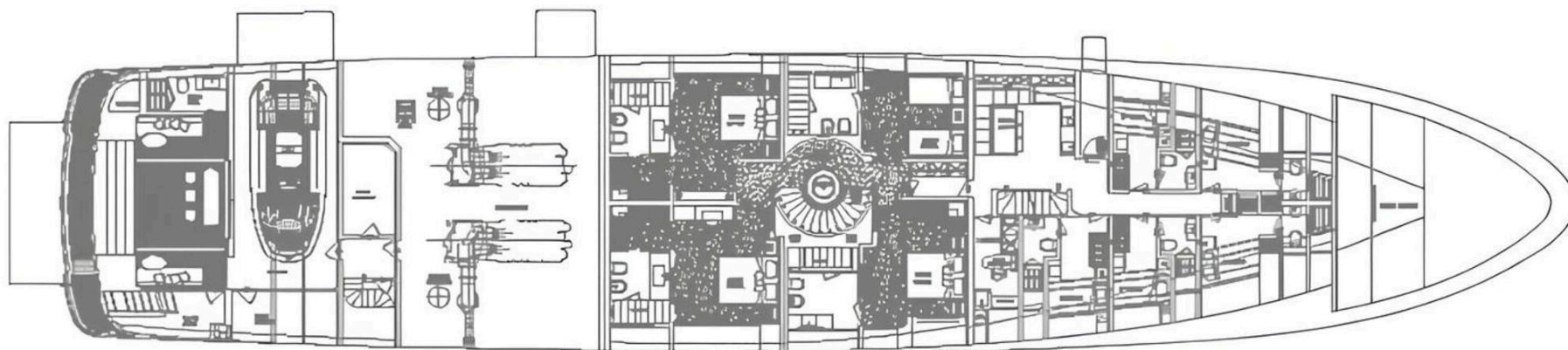

LOWER DECK





## KIRILL KUATOV

+377 607 93 15 20

+39 333 576 44 44

 [Send e-mail](#)

 WhatsApp

 Telegram

[More information about M/Y FLORENTIA at www.nauyachts.com](http://www.nauyachts.com)

[Watch video](#)