



Brokerage

NAU  
YACHTS

LYDIA

MOTOR YACHT    SANLORENZO 26.7M    2020

€5,500,000 (VAT paid)  
FLAG - CYPRUS

MOTOR YACHT

## LYDIA

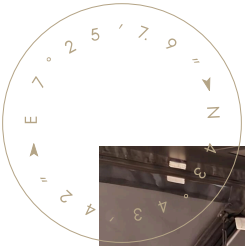

**Sanlorenzo SX88 LYDIA**, delivered to her owner in 2020, represents one of the most functionally advanced configurations within the **SX** line. The superstructure is positioned forward, allowing for an expansive open aft deck - a defining architectural feature that integrates tender stowage, launching operations and a generous lounge area into one cohesive space.

The main deck is conceived as a fully open environment, where the salon, dining area and forward lounge connect seamlessly without changes in level. The primary helm station has been moved to the flybridge, dedicating the entire main deck exclusively to guest living. Constructed in GRP, both the hull and superstructure benefit from a deep-V hull form combined with triple Volvo Penta IPS engines, offering efficient performance, responsive handling and speeds of up to 23 knots with a comfortable 20-knot cruise.

The lower deck accommodates eight guests in four cabins: a full-beam master, a VIP and two guest cabins. Crew quarters for three are located aft with a private entrance, ensuring complete separation between service and guest areas. **LYDIA's** interior has been customised extensively: a redesigned galley layout, expanded storage volumes, upgraded domestic appliances, integrated blackout systems, reinforced finishing materials, enhanced sound insulation, and improved furniture engineering. Several cabins also feature lift-up bed mechanisms.

Technical equipment includes zero-speed stabilisers, an upgraded Raymarine navigation suite with monitoring and CCTV, two generators, an Idromar watermaker, a lithium-ion battery bank for auxiliary power, and a Gold-level integrated AV network. Additional features comprise enhanced lighting, expanded electrical capacity, an updated Wi-Fi architecture, pre-installation for name lighting and an extended set of media options.

The water-toys inventory includes a Williams SportJet 435 tender, a Sea-Doo RXT-X 300 jetski, and two Seabob F5S units with charging stations and dedicated storage mounts.

**SX88 LYDIA** is designed for active use and extended stays on board. Her optimised architecture, refined ergonomics, comprehensive technical specification and bespoke interior configuration position her as one of the strongest offerings in the **SX88** segment.

[see more information about M/Y LYDIA at www.nauyachts.com](http://www.nauyachts.com)

# SPECIFICATION

SHIPYARD, MODEL	Sanlorenzo SX88
BUILT	2020
LENGTH	26.7 m
WATERLINE LENGTH	23.4 m
HULL CONFIGURATION	SEMI-DISPLACEMENT
BEAM	7.2 m
RANGE	1200
DRAFT	1.7 m
GROSS TONNAGE	116 GT
YACHT CLASS	N/A
CABINS	4+1
MASTER CABIN	LOWER DECK
GUESTS	8
BERTHS	8+3
CREW	3
HEADS	4+1

EXTERIOR DESIGN	OFFICINA ITALIANA DESIGN
INTERIOR DESIGN	OFFICINA ITALIANA DESIGN
HULL	GRP
SUPERSTRUCTURE	GRP
ENGINES	3 x Volvo Penta IPS 800 h.p.
TYPE OF DRIVE	VOLVO PENTA IPS
ENGINE HOURS	299 h
MAXIMUM SPEED	23 kn
CRUISING SPEED	20 kn
FUEL CONSUMPTION AT ECONOMICAL SPEED	~ 120 l/h
FUEL	9300 l
GREY WATER	550 l
BLACK WATER	550 l
FRESH WATER	2000 l
DISPLACEMENT	82

[see more information about M/Y LYDIA at www.nauyachts.com](http://www.nauyachts.com)





EXTERIOR SANLORENZO SX88 2020 M/Y LYDIA

M/Y LYDIA





EXTERIOR SANLORENZO SX88 2020 M/Y LYDIA

M/Y LYDIA





AFT AREA

M/Y LYDIA





AFT AREA

M/Y LYDIA





SWIMMING PLATFORM AND WATER TOYS

M/Y LYDIA





FLYBRIDGE LOUNGE AREA

M/Y LYDIA





FLYBRIDGE GRILL

M/Y LYDIA





FLYBRIDGE GRILL

M/Y LYDIA





MAIN SALON LOUNGE AREA

M/Y LYDIA





MAIN SALON LOUNGE AREA

M/Y LYDIA





STAIRS FROM MD TO LD

M/Y LYDIA





MASTER BATHROOM

M/Y LYDIA





MASTER BATHROOM

M/Y LYDIA





MASTER BATHROOM

M/Y LYDIA





MASTER BATHROOM

M/Y LYDIA





VIP BATHROOM

M/Y LYDIA





VIP BATHROOM

M/Y LYDIA



# General Arrangement





## PROFILE



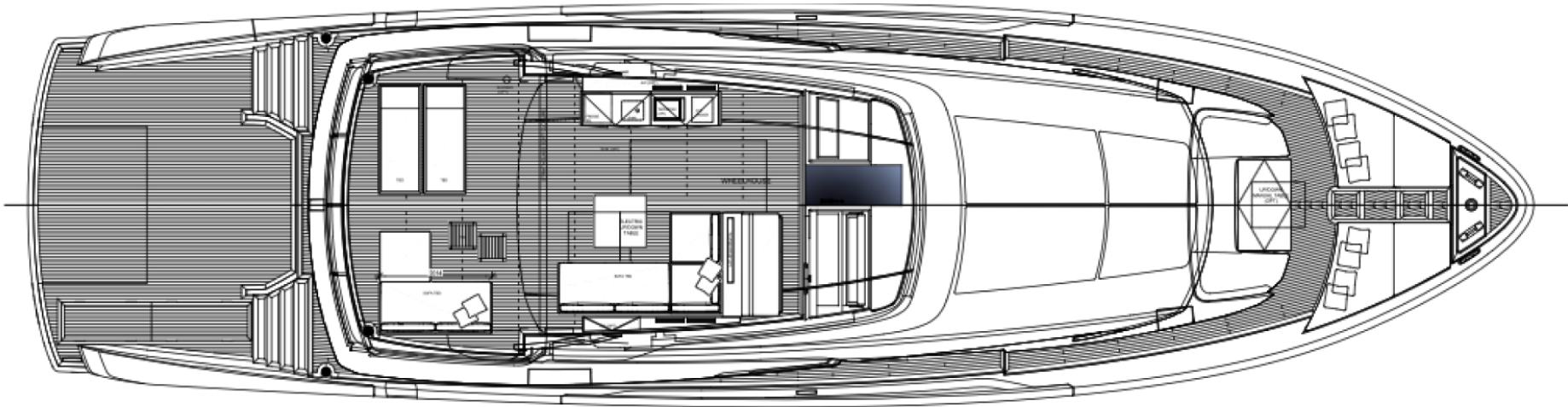

# FLYBRIDGE



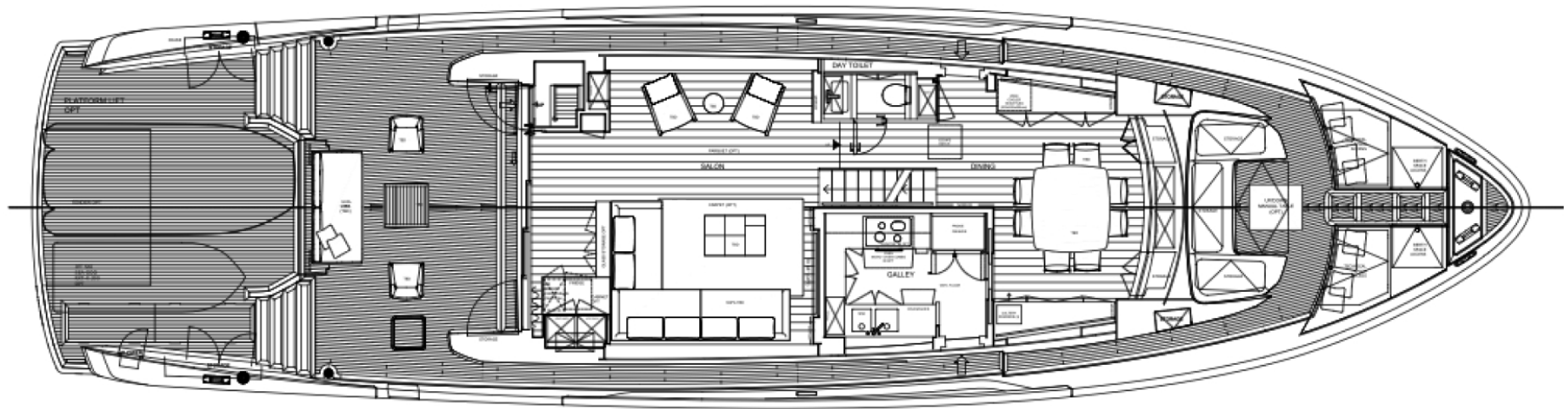

## MAIN DECK



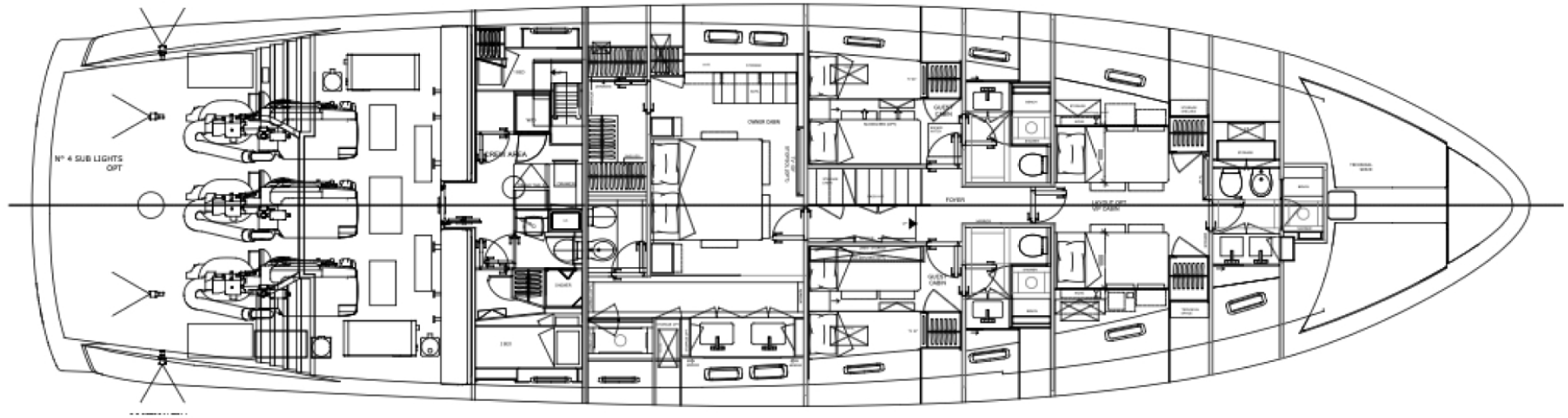

---

---

---

## LOWER DECK



# EQUIPMENT

GENERAL	EXTERIOR	INTERIOR	ELECTRONICS AND NAVIGATION	OTHER
<ul style="list-style-type: none"> <li>• Joystick VOLVO for engines IPS transmissions - second aft cockpit station</li> <li>• Electric stabilizers (at anchor and under navigation) - incl. Upgrade generator 35kW</li> <li>• Water maker Idromar 180 l/h</li> <li>• Boiler 150 liters - diff from 100 liters STD</li> <li>• Upgrade second generator 28kW (diff.from STD 20,5 kW)</li> </ul>	<ul style="list-style-type: none"> <li>• External column shower on fly bridge</li> <li>• Electric blades opening roof for Hard Top</li> <li>• Sun awning for the stern area of the fly behind the Hard top</li> <li>• Bow bimini canvas</li> <li>• Teak deck for flybridge - BLACK caulking</li> <li>• Air conditioning on fly bridge (incl. teak cabinet modification)</li> <li>• no.4 Underwater lights led 7000 lumen (no.2 on aft transom + no.2 on sides close to the aft)</li> <li>• Lifting system for swimming platform</li> <li>• Backlit boat name letters predisposition</li> <li>• Dimmer package for exteriors</li> <li>• ...</li> </ul>	<ul style="list-style-type: none"> <li>• Veneer wood floorboard in Salon (diff.from STD carpet) , dining area, steps to LD and steps to fly (diff.from standard wood)</li> <li>• Rug in salon Super Tuft Santushti.</li> <li>• Custom layout LISSONI for owner's bathroom on the side with fixed glass (diff. From standard)</li> <li>• Air conditioning ceilings in salon in Rimex (diff. From standard)</li> <li>• TV behind stopsol mirror in owner's cabin</li> <li>• Dimmer package for interiors</li> <li>• No.1 pullman beds in both port and stbd guest cabins</li> <li>• Sliding bed in port guest cabin</li> <li>• Ceiling with fabric Z&amp;R FOCUS 951 in all cabins (owner, vip and ...</li> </ul>	<ul style="list-style-type: none"> <li>• CCTV IP Raymarine: 1 fixed in cockpit, 1 fixed in engine room</li> <li>• Predisposition for additional touch screen monitor 12" Raymarine (ship monitoring system with Empirbus) - crew mess</li> <li>• Raymarine Integrated dashboard system (ship monitoring) incl. 3rd additional Raymarine monitor</li> <li>• Raymarine DIAMOND navigation package (diff.from STD SILVER)</li> <li>• Battery charger 12V 25A for generator batteries</li> <li>• N.3 Additional waterproof socket 220V - n.1 on bar fly cabinet + n.1 into beach area front storages + n.1 USB on helm station</li> <li>• TV-Sat Antenna KVVH TV6</li> <li>• KVVH ...</li> </ul>	<ul style="list-style-type: none"> <li>• Tender Williams Sportjet 435 120hp - incl. Removable cradles - color and options to be decided by the Client</li> <li>• Seadoo RXT-X 300 with cradles and hardware fittings</li> <li>• no.2 Seabob F5S (no.1 yellow + no.1 red) - incl. Bag and fast batterycharger</li> </ul>





KIRILL KUATOV

+377 607 93 15 20

+39 333 576 44 44

 [Send e-mail](#)

 WhatsApp

 Telegram