



Brokerage

NAU
YACHTS

HBC

MOTOR YACHT

ABEKING & RASMUSSEN 85.65M

2009

€117,000,000

FLAG - UK

MOTOR YACHT

HBC

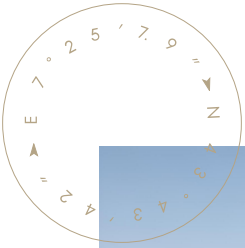

Built by **Abeking & Rasmussen** in 2009 and subsequently lengthened and extensively upgraded - with major refits in 2019 and 2025 - **HBC** is an 85.70-metre superyacht of 2,150 GT, engineered for global cruising and high-end charter operations. A steel hull, three-deck aluminium superstructure, stabilisers underway and at zero speed, a lift serving all decks, and a comprehensive climate-control system form the foundation for long periods of autonomous living on board.

Her accommodation layout is designed for up to 30 guests across 15 suites. The owner's deck is a private full-level retreat, featuring a dedicated terrace, his-and-hers bathrooms and floor-to-ceiling panoramic glazing. A large VIP suite occupies the main deck, while the remaining guest cabins are distributed across multiple levels and include a mix of king- and queen-bed configurations, allowing flexible use of space and efficient accommodation planning. The yacht carries a crew of 35, including a full-time spa therapist.

A defining feature of **HBC** is the 7 x 3-metre pool on the aft main deck, fitted with a glass bottom that illuminates the beach club below. The beach club itself is enhanced by fold-out sea-level terraces on both sides, creating a bright and expansive waterside lounge. The upper deck and bridge deck provide outdoor dining and relaxation areas, while the sun deck is equipped with a Jacuzzi and multiple viewing platforms. An 85" open-air cinema is positioned aft for evening entertainment.

The upper deck houses a full gym and a dedicated spa complex for treatments and wellness routines. Interior guest spaces - including the main salon, sky lounge and several private rooms - are designed to adapt seamlessly to formal entertaining, family cruising or charter use.

With 160,000 litres of fuel, **HBC** offers exceptional self-sufficiency. At an economical speed of 12 knots she consumes approximately 425 l/h, while her 13.5-knot cruising speed averages around 485 l/h. Fresh-water capacity totals 35,000 litres, and dual watermakers produce up to 25 tonnes per day. Advanced noise and vibration-reduction engineering ensures a smooth, quiet experience throughout.

HBC combines scale, technical resilience and a wide operational envelope - delivering the capability, comfort and flexibility required for true world cruising and top-tier commercial deployment.

see more information about M/Y HBC at www.nauyachts.com

SPECIFICATION

SHIPYARD, MODEL	Abeking & Rasmussen 85M
BUILT	2009
LENGTH	85.65 m
WATERLINE LENGTH	72.5 m
HULL CONFIGURATION	DISPLACEMENT
BEAM	12.4 m
RANGE	6475
DRAFT	3.45 m
GROSS TONNAGE	2150 GT
YACHT CLASS	LLOYD'S
CABINS	15+17
MASTER CABIN	UPPER DECK
GUESTS	30
BERTHS	30+35
CREW	35
HEADS	19+17

EXTERIOR DESIGN	MARK BERRYMAN
INTERIOR DESIGN	REYMOND LANGTON, BRIAN CALLAHAN, WINCH DESIGN
HULL	STEEL
SUPERSTRUCTURE	ALUMINIUM
ENGINES	2 x Caterpillar 3516B DITA 2000 h.p.
TYPE OF DRIVE	SHAFT LINE
ENGINE HOURS	N/A
MAXIMUM SPEED	16.5 kn
CRUISING SPEED	13.5 kn
FUEL CONSUMPTION AT ECONOMICAL SPEED	~ 528 l/h
FUEL	225000 l
GREY WATER	N/A
BLACK WATER	N/A
FRESH WATER	62000 l
DISPLACEMENT	N/A

[see more information about M/Y HBC at www.nauyachts.com](http://www.nauyachts.com)



EXTERIOR ABEKING & RASMUSSEN 85M 2009
MY HBC

M/Y HBC



BOW LOUNGE ARE

M/Y HBC



AFT MAIN DECK LOUNGE AREA

M/Y HBC



AFT MAIN DECK SWIMMING POOL

M/Y HBC



AFT MAIN DECK LOUNGE AREA

M/Y HBC



AFT UPPER DECK DINING AREA

M/Y HBC



BRIDGE DECK DINING AREA

M/Y HBC



SUNDECK LOUNGE AREA

M/Y HBC



SUNDECK JACUZZI

M/Y HBC



SUNDECK LOUNGE AREA

M/Y HBC



MAIN SALON LOUNGE AREA

M/Y HBC



MAIN SALON LOUNGE AREA

M/Y HBC



MAIN SALON LOBBY

M/Y HBC



VIP CABIN

M/Y HBC



GUEST BATHROOM

M/Y HBC



VIP CABIN

M/Y HBC



VIP CABIN

M/Y HBC



GUEST BATHROOM

M/Y HBC



VIP CABIN

M/Y HBC



VIP CABIN

M/Y HBC



GUEST BATHROOM

M/Y HBC



VIP CABIN

M/Y HBC



VIP CABIN

M/Y HBC



VIP CABIN

M/Y HBC



VIP CABIN

M/Y HBC



VIP CABIN

M/Y HBC



VIP BATHROOM

M/Y HBC



MASTER CABIN

M/Y HBC



MASTER CABIN

M/Y HBC



MASTER CABIN

M/Y HBC



OFFICE IN THE MASTER CAB

M/Y HBC



OFFICE IN THE MASTER CAB

M/Y HBC



GYM IN THE MASTER CAB

M/Y HBC



UPPER DECK SALOON DINING AREA

M/Y HBC



UPPER DECK SALOON

M/Y HBC



UPPER DECK SALOON

M/Y HBC



UPPER DECK SALON BAR

M/Y HBC



MAIN HELM STATION

M/Y HBC



BEACH CLUB

M/Y HBC



BEACH CLUB

M/Y HBC



BEACH CLUB

M/Y HBC

General Arrangement

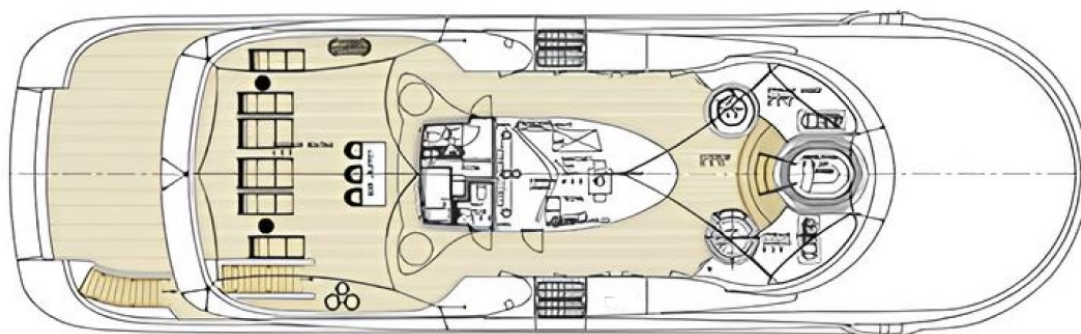

SUNDECK

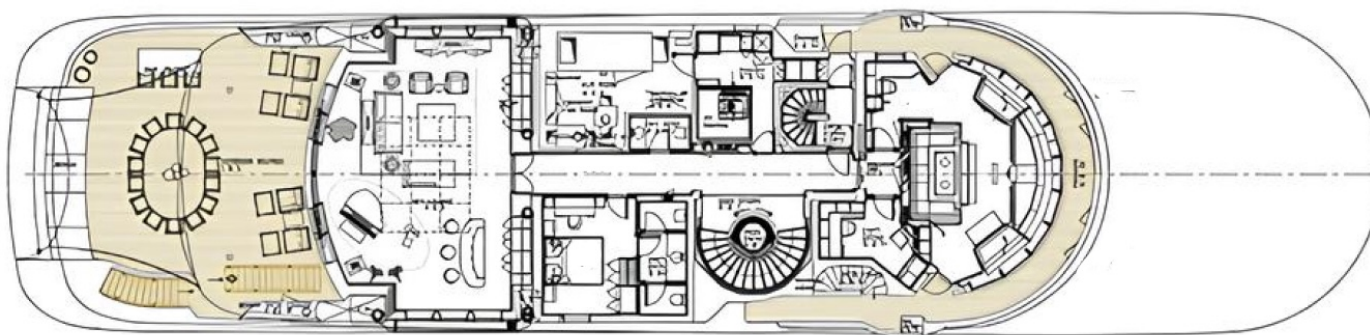

BRIDGE DECK

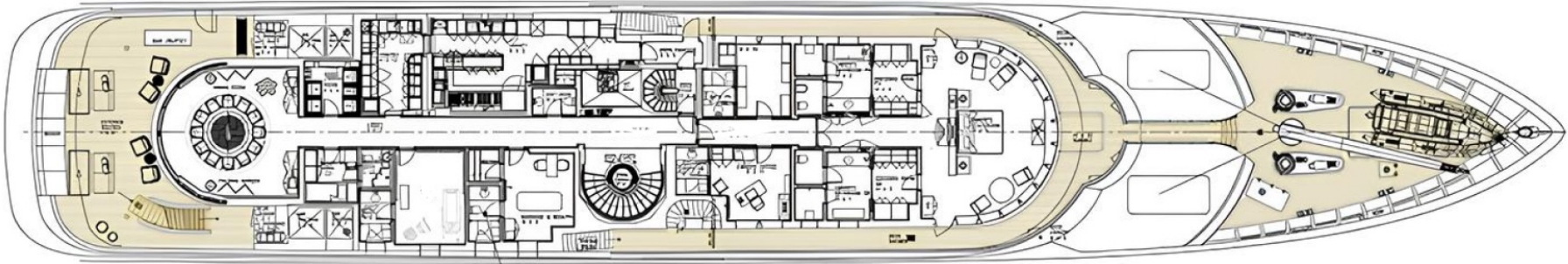

UPPER DECK

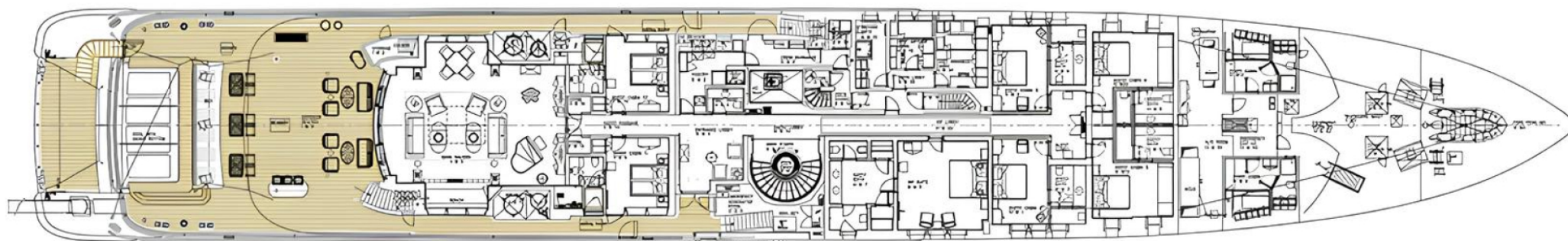

MAIN DECK

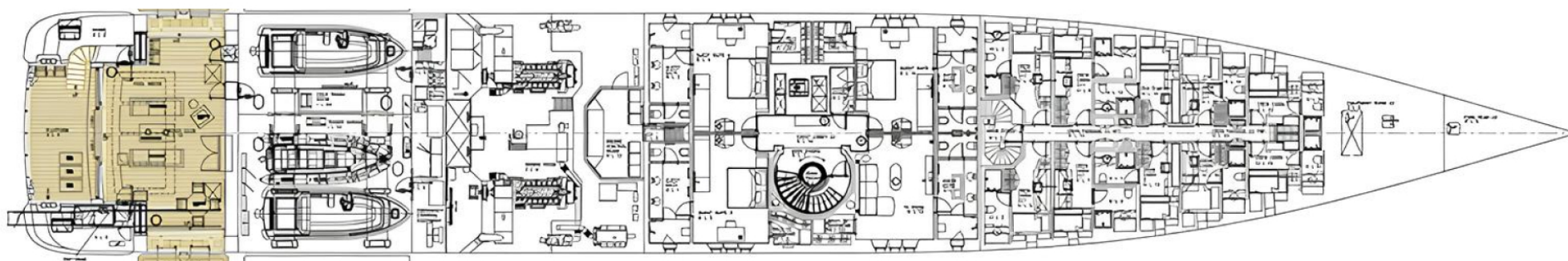

LOWER DECK



KIRILL KUATOV

+377 607 93 15 20

+39 333 576 44 44

 [Send e-mail](#)

 WhatsApp

 Telegram