



Brokerage

NAU  
YACHTS

# SILVER MISSILE

MOTOR YACHT    PERSHING 18.94M    2023

€1,950,000  
FLAG - UK



MOTOR YACHT

## SILVER MISSILE



**SILVER MISSILE**, a **Pershing 6X** from the Pershing Anniversary Special Edition series, is a high-performance 18.94-metre sports yacht distinguished by its signature silver hull and superstructure, contemporary Fulvio De Simoni design, and an upgraded technical specification. The yacht has exceptionally low engine hours and is presented in immaculate, "as-new" condition.

The lower-deck layout features two cabins - a mid-ship master and a forward VIP - each with its own en-suite bathroom. The main-deck salon can be converted into an additional cabin, bringing total guest capacity to six. A separate crew cabin for one ensures private and efficient service on board.

Powered by twin 1,550 hp MAN engines, **SILVER MISSILE** reaches a cruising speed of 40 knots and an impressive maximum speed of up to 48 knots. A Seakeeper gyro stabiliser guarantees comfort both underway and at anchor. The yacht is equipped with an upgraded generator, tropical-spec air conditioning, a watermaker and a full suite of navigation systems. A brand-new Williams tender is included and has never been used.

Currently based on the French Riviera and fully ready for immediate use, **SILVER MISSILE** stands out as a rare offering in its segment - combining exceptional speed, a contemporary specification and pristine, near-new condition.

[see more information about M/Y SILVER MISSILE at www.nauyachts.com](http://www.nauyachts.com)

# SPECIFICATION

SHIPYARD, MODEL	Pershing 6X
BUILT	2023
LENGTH	18.94 m
WATERLINE LENGTH	16.21 m
HULL CONFIGURATION	PLANING
BEAM	5 m
RANGE	280
DRAFT	1.45 m
GROSS TONNAGE	40 GT
YACHT CLASS	RINA
CABINS	2+1
MASTER CABIN	LOWER DECK
GUESTS	6
BERTHS	6+1
CREW	1
HEADS	2+1

EXTERIOR DESIGN	FULVIO DE SIMONI
INTERIOR DESIGN	PERSHING YACHTS
HULL	GRP
SUPERSTRUCTURE	GRP
ENGINES	2 x MAN V12 1550 h.p.
TYPE OF DRIVE	SHAFT LINE
ENGINE HOURS	183 h
MAXIMUM SPEED	48 kn
CRUISING SPEED	40 kn
FUEL CONSUMPTION AT ECONOMICAL SPEED	~ 550 l/h
FUEL	3200 l
GREY WATER	328 l
BLACK WATER	328 l
FRESH WATER	740 l
DISPLACEMENT	40

[see more information about M/Y SILVER MISSILE at www.nauyachts.com](http://www.nauyachts.com)





EXTERIOR PERSHING 6X 2023 MY SILVER  
MISSILE

M/Y SILVER MISSILE





EXTERIOR PERSHING 6X 2023 MY SILVER  
MISSILE

M/Y SILVER MISSILE





EXTERIOR PERSHING 6X 2023 MY SILVER  
MISSILE

M/Y SILVER MISSILE





EXTERIOR PERSHING 6X 2023 MY SILVER  
MISSILE

M/Y SILVER MISSILE





EXTERIOR PERSHING 6X 2023 MY SILVER  
MISSILE

M/Y SILVER MISSILE





EXTERIOR PERSHING 6X 2023 MY SILVER  
MISSILE

M/Y SILVER MISSILE





EXTERIOR PERSHING 6X 2023 MY SILVER  
MISSILE

M/Y SILVER MISSILE





EXTERIOR PERSHING 6X 2023 MY SILVER  
MISSILE

M/Y SILVER MISSILE





EXTERIOR PERSHING 6X 2023 MY SILVER  
MISSILE

M/Y SILVER MISSILE





EXTERIOR PERSHING 6X 2023 MY SILVER  
MISSILE

M/Y SILVER MISSILE





GARAGE

M/Y SILVER MISSILE





COCKPIT SEATING AREA

M/Y SILVER MISSILE





COCKPIT SEATING AREA

M/Y SILVER MISSILE





MAIN SALON DINING AREA

M/Y SILVER MISSILE





MAIN SALON DINING AREA

M/Y SILVER MISSILE





MAIN HELM STATION

M/Y SILVER MISSILE





MAIN HELM STATION

M/Y SILVER MISSILE





STAIRS FROM MD TO LD

M/Y SILVER MISSILE





LOWER DECK LOBBY

M/Y SILVER MISSILE





GUEST CABIN

M/Y SILVER MISSILE





GUEST CABIN

M/Y SILVER MISSILE





GUEST BATHROOM

M/Y SILVER MISSILE





VIP CABIN

M/Y SILVER MISSILE





VIP BATHROOM

M/Y SILVER MISSILE





MASTER CABIN

M/Y SILVER MISSILE





MASTER CABIN

M/Y SILVER MISSILE



# General Arrangement





PROFILE





TOP VIEW



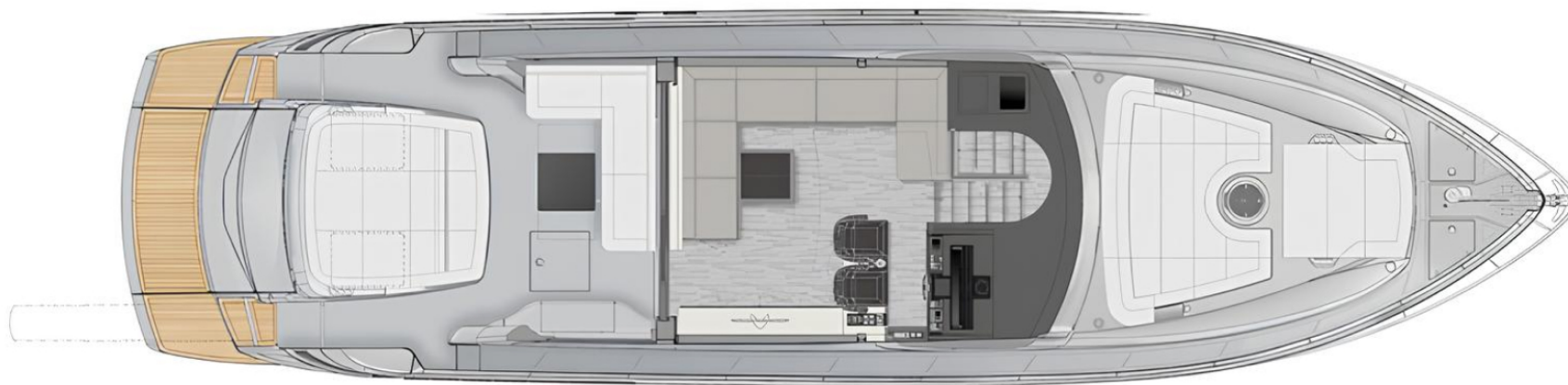

MAIN DECK



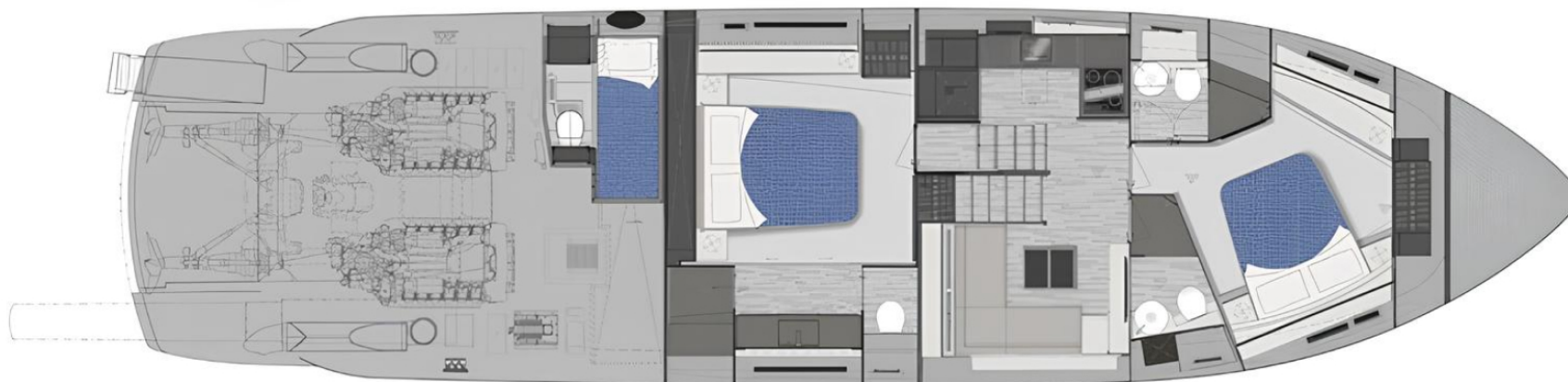

LOWER DECK





KIRILL KUATOV

+377 607 93 15 20

+39 333 576 44 44

 [Send e-mail](#)

 WhatsApp

 Telegram