



New Build

NAU
YACHTS

6X

MOTOR YACHT

PERSHING 18.94M

2028

FLAG -

MOTOR YACHT

6X



Pershing 6X is a **Generation X** sport motor yacht where high performance is combined with advanced technology and a rational, well-balanced interior layout. The 18.94-metre hull incorporates extensive use of carbon fibre, reducing weight and enhancing dynamic performance, while the signature Pershing side “wings” improve aerodynamics and flood the interiors with natural light.

Twin MAN V12 engines producing 1,550 hp each propel the yacht to a top speed of up to 48 knots, with a comfortable cruising speed of around 40 knots. Surface drives and integrated control systems deliver precise handling and full confidence even at high speeds.

Accommodation is arranged for six guests in three cabins, complemented by a separate crew cabin. The full-beam master cabin is located amidships, while the two guest cabins are also en suite. Interiors reflect Pershing’s signature style, with a combination of wood finishes, lacquered surfaces and parquet flooring.

On the main deck, the cockpit features a transformable table, a lounge area and direct access to the foredeck sunbathing area. A large sliding sunroof above the helm further enhances the open, airy feel on board.

Pershing 6X is an ideal choice for owners seeking speed, cutting-edge engineering and compact yet fully realised comfort for dynamic outings and short-range cruising.

[see more information about M/Y 6X at www.nauyachts.com](http://www.nauyachts.com)

SPECIFICATION

SHIPYARD, MODEL	Pershing 6X
DELIVERY AT THE SHIPYARD	2028
LENGTH	18.94 m
WATERLINE LENGTH	14.63 m
HULL CONFIGURATION	PLANING
BEAM	4.8 m
RANGE	280
DRAFT	1.45 m
GROSS TONNAGE	40 GT
YACHT CLASS	RINA
CABINS	3+1
MASTER CABIN	MAIN DECK
GUESTS	6
BERTHS	6+1
CREW	1
HEADS	3+1

EXTERIOR DESIGN	PERSHING YACHTS
INTERIOR DESIGN	PERSHING YACHTS
HULL	CARBON FIBRE
SUPERSTRUCTURE	CARBON FIBRE
ENGINES	2 x MAN V12 1550 h.p.
TYPE OF DRIVE	SURFACE DRIVE
ENGINE HOURS	N/A
MAXIMUM SPEED	48 kn
CRUISING SPEED	40 kn
FUEL CONSUMPTION AT ECONOMICAL SPEED	~ 550 l/h
FUEL	3200 l
GREY WATER	N/A
BLACK WATER	N/A
FRESH WATER	740 l
DISPLACEMENT	40

[see more information about M/Y 6X at www.nauyachts.com](http://www.nauyachts.com)



EXTERIOR PERSHING 6X

M/Y 6X



EXTERIOR PERSHING 6X

M/Y 6X



EXTERIOR PERSHING 6X

M/Y 6X



EXTERIOR PERSHING 6X

M/Y 6X



EXTERIOR PERSHING 6X

M/Y 6X



EXTERIOR PERSHING 6X

M/Y 6X



EXTERIOR PERSHING 6X

M/Y 6X



EXTERIOR PERSHING 6X

M/Y 6X



EXTERIOR PERSHING 6X

M/Y 6X



EXTERIOR PERSHING 6X

M/Y 6X



BOW SUNBATHING AREA

M/Y 6X



BOW SUNBATHING AREA

M/Y 6X



BOW SUNBATHING AREA

M/Y 6X



PORT SIDE

M/Y 6X



MAIN DECK LOUNGE AREA

M/Y 6X



MAIN DECK LOUNGE AREA

M/Y 6X



MAIN DECK LOUNGE AREA

M/Y 6X



MAIN SALON LOUNGE AREA

M/Y 6X



MAIN SALON LOUNGE AREA

M/Y 6X



GALLEY

M/Y 6X



MASTER CABIN

M/Y 6X



MASTER CABIN

M/Y 6X



MASTER CABIN

M/Y 6X



MASTER BATHROOM

M/Y 6X



MASTER BATHROOM

M/Y 6X





VIP CABIN

M/Y 6X



VIP BATHROOM

M/Y 6X



GUEST CABIN

M/Y 6X



MAIN HELM STATION

M/Y 6X

General Arrangement



PROFILE

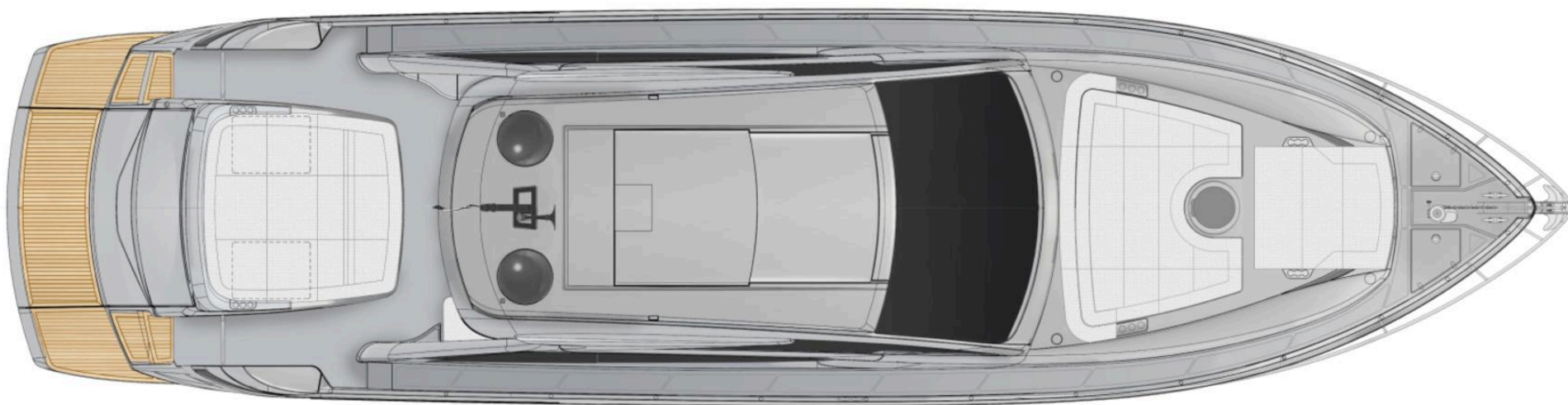

TOP VIEW



MAIN DECK

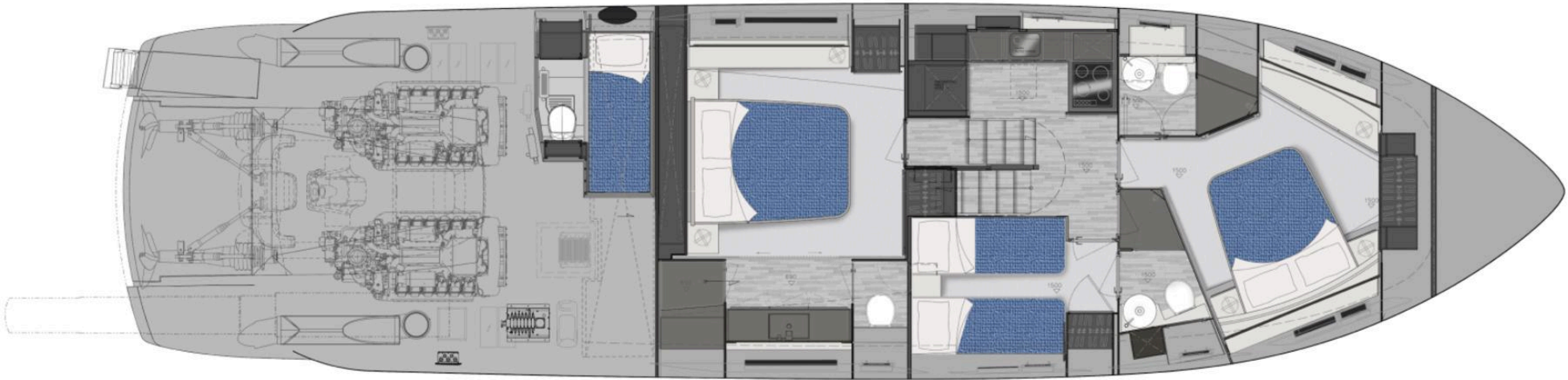

LOWER DECK



KIRILL KUATOV

+377 607 93 15 20

+39 333 576 44 44

 [Send e-mail](#)

 WhatsApp

 Telegram

[More information about M/Y 6X at www.nauyachts.com](http://www.nauyachts.com)

[Watch video](#)