



New Build

NAU
YACHTS

5X

MOTOR YACHT PERSHING 16.51M 2027

FLAG -

MOTOR YACHT

5X

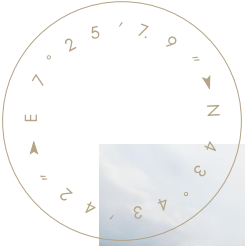

Pershing 5X is the most compact model in the **X Generation** - a 16.5-metre motor yacht designed for dynamic coastal cruising and precise handling. Powered by twin Volvo D11 engines with IPS drives, she reaches speeds of up to 36 knots and maintains a confident cruising speed of around 31 knots, with joystick control and the Easy Dock system simplifying manoeuvring in marinas.

The exterior follows **Pershing's** signature sporty architecture, with sliding doors that seamlessly connect the saloon and cockpit into a single open living space. A semi-submersible swim platform facilitates easy access to the water and tender operations, enhancing everyday practicality.

The lower deck accommodates four guests in two cabins: a full-beam master cabin amidships and a forward guest cabin, both with en-suite bathrooms. An optional crew cabin with bathroom can be specified. Interiors are finished in the distinctive **Pershing** style, with a focus on functionality, light-filled spaces, and high-quality materials.

[see more information about M/Y 5X at www.nauyachts.com](http://www.nauyachts.com)

SPECIFICATION

| | |
|--------------------------|-------------|
| SHIPYARD, MODEL | Pershing 5X |
| DELIVERY AT THE SHIPYARD | 2027 |
| LENGTH | 16.51 m |
| WATERLINE LENGTH | 12.93 m |
| HULL CONFIGURATION | PLANING |
| BEAM | 4.38 m |
| RANGE | 300 |
| DRAFT | 1.35 m |
| GROSS TONNAGE | N/A |
| YACHT CLASS | N/A |
| CABINS | 2+1 |
| MASTER CABIN | LOWER DECK |
| GUESTS | 4 |
| BERTHS | 4+1 |
| CREW | 1 |
| HEADS | 2+1 |

| | |
|--------------------------------------|----------------------------------|
| EXTERIOR DESIGN | PERSHING YACHTS |
| INTERIOR DESIGN | PERSHING YACHTS |
| HULL | GRP |
| SUPERSTRUCTURE | GRP |
| ENGINES | 2 x Volvo Penta IPS D11 725 h.p. |
| TYPE OF DRIVE | VOLVO PENTA IPS |
| ENGINE HOURS | N/A |
| MAXIMUM SPEED | 36 kn |
| CRUISING SPEED | 31 kn |
| FUEL CONSUMPTION AT ECONOMICAL SPEED | N/A |
| FUEL | 2200 l |
| GREY WATER | N/A |
| BLACK WATER | N/A |
| FRESH WATER | 416 l |
| DISPLACEMENT | 25 |

[see more information about M/Y 5X at www.nauyachts.com](http://www.nauyachts.com)



EXTERIOR PERSHING 5X

M/Y 5X



EXTERIOR PERSHING 5X

M/Y 5X



EXTERIOR PERSHING 5X

M/Y 5X



EXTERIOR PERSHING 5X

M/Y 5X



EXTERIOR PERSHING 5X

M/Y 5X



EXTERIOR PERSHING 5X

M/Y 5X



EXTERIOR PERSHING 5X

M/Y 5X



AFT AREA PERSHING 5X

M/Y 5X



AFT AREA PERSHING 5X

M/Y 5X



AFT AREA PERSHING 5X

M/Y 5X



GARAGE

M/Y 5X



COCKPIT SEATING AREA

M/Y 5X



COCKPIT SEATING AREA

M/Y 5X



MAIN SALON LOUNGE AREA

M/Y 5X



MAIN SALON LOUNGE AREA

M/Y 5X



MAIN SALON LOUNGE AREA

M/Y 5X



MAIN SALON LOUNGE AREA

M/Y 5X



MAIN HELM STATION

M/Y 5X



LOWER DECK LOBBY

M/Y 5X



LOWER DECK LOBBY

M/Y 5X



GALLEY

M/Y 5X



MASTER CABIN

M/Y 5X



MASTER CABIN

M/Y 5X



MASTER BATHROOM

M/Y 5X



VIP CABIN

M/Y 5X



VIP CABIN

M/Y 5X



VIP BATHROOM

M/Y 5X

General Arrangement



PROFILE

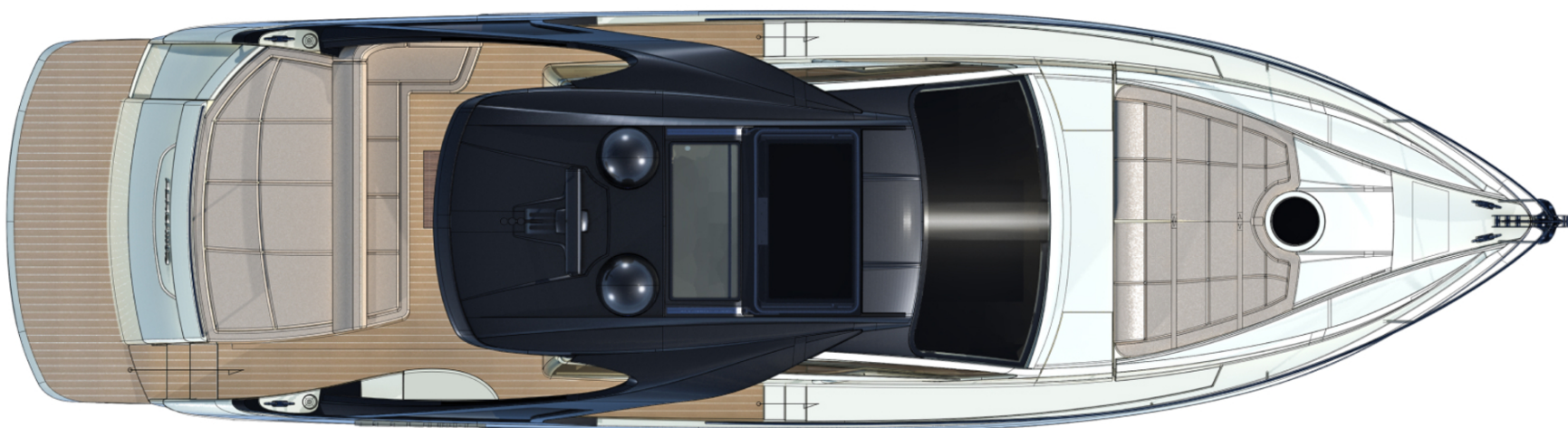

TOP VIEW

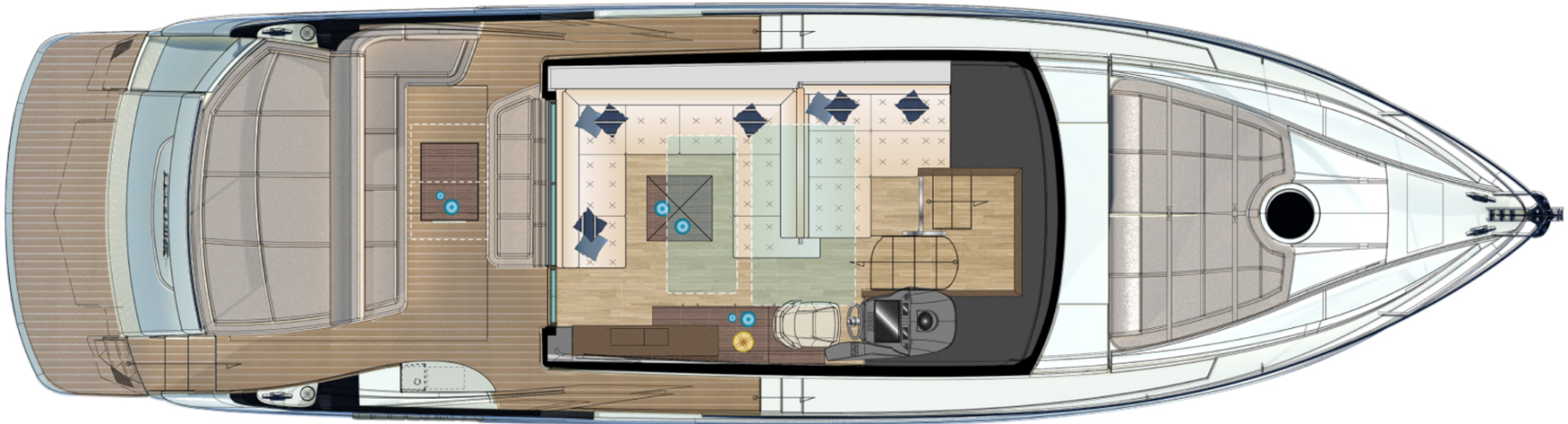

MAIN DECK

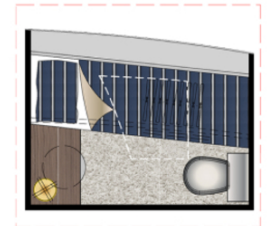
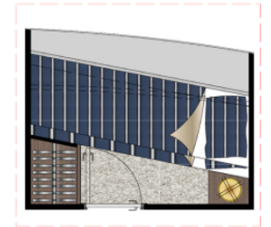
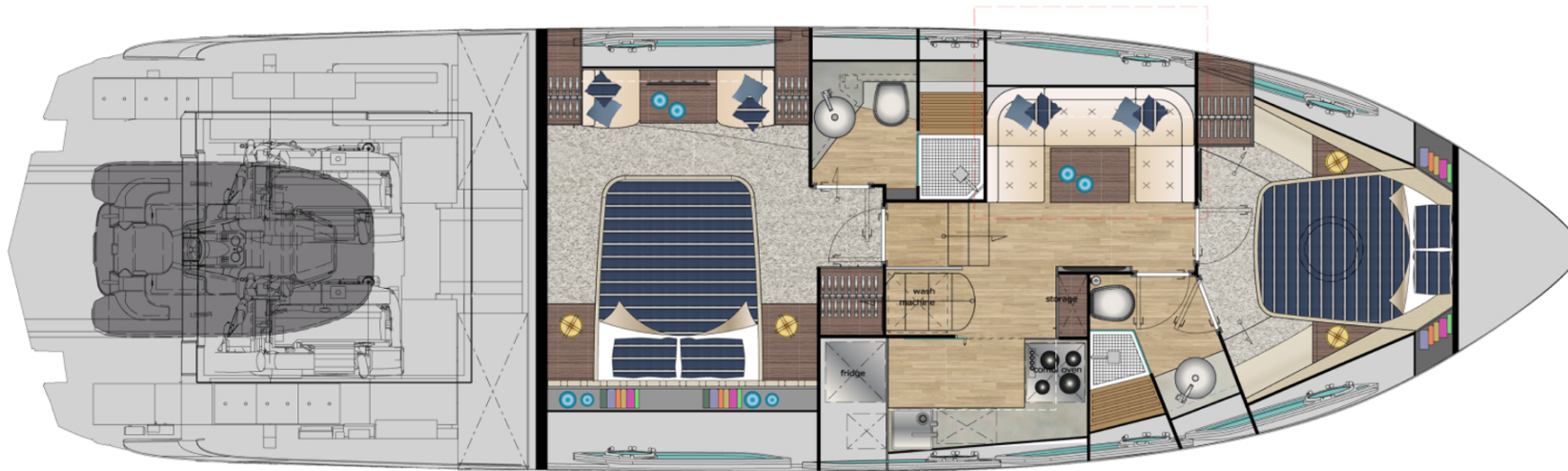

LOWER DECK



KIRILL KUATOV

+377 607 93 15 20

+39 333 576 44 44

 [Send e-mail](#)

 WhatsApp

 Telegram

[More information about M/Y 5X at www.nauyachts.com](#)

[Watch video](#)