



New Build

NAU
YACHTS

SEADECK 9

MOTOR YACHT AZIMUT 25.6M 2027

FLAG -

MOTOR YACHT

SEADECK 9

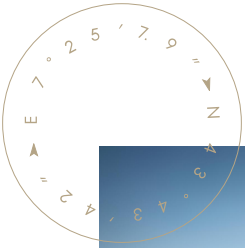

Azimut Seadeck 9 is a contemporary 25.6-metre motor yacht built using a combination of GRP and carbon fibre, designed for efficient cruising and an active lifestyle close to the water. Her well-balanced hull architecture delivers generous interior volumes while maintaining a shallow draft of just 1.15 metres. Powered by three Volvo D13 IPS 1200 engines producing 900 hp each (with IPS 1350 available as an option), **Seadeck 9** reaches speeds of up to 35 knots and offers a range of approximately 350 nautical miles. A Seakeeper 26 stabiliser enhances comfort both underway and at anchor, while 6,000-litre fuel tanks and increased freshwater capacity highlight the yacht's practical, owner-focused specification. The layout accommodates between eight and ten guests in four or five cabins, each with an en-suite bathroom, complemented by separate quarters for a crew of two. Interiors by Matteo Thun & Antonio Rodriguez feature natural materials such as Almond Oak and stone, creating a refined yet relaxed atmosphere. The exterior styling, developed by Alberto Mancini, places strong emphasis on open-air living. The aft area features a transformable Pop-Out platform that creates a true beach club at water level, with options including a heated spa pool and a dedicated mechanism for launching a jet ski. The flybridge is arranged with a lounge, dining table, barbecue and a secondary helm station, while the foredeck provides a comfortable sunbathing area. Combining strong performance, contemporary design and an extensive specification, the **Azimut Seadeck 9** is a versatile yacht for owners who value dynamics, comfort and a thoughtfully organised onboard experience.

[see more information about M/Y SEADECK 9 at www.nauyachts.com](http://www.nauyachts.com)

SPECIFICATION

SHIPYARD, MODEL	Azimut Seadeck 9
DELIVERY AT THE SHIPYARD	2027
LENGTH	25.6 m
WATERLINE LENGTH	22.15 m
HULL CONFIGURATION	PLANING
BEAM	7.7 m
RANGE	350
DRAFT	1.15 m
GROSS TONNAGE	N/A
YACHT CLASS	CE CLASS A
CABINS	4+2
MASTER CABIN	LOWER DECK
GUESTS	8
BERTHS	8+4
CREW	4
HEADS	5+1

EXTERIOR DESIGN	ALBERTO MANCINI
INTERIOR DESIGN	MATTEO THUN & ANTONIO RODRIGUEZ
HULL	GRP
SUPERSTRUCTURE	CARBON FIBRE
ENGINES	3 x Volvo Penta IPS 1200 900 h.p.
TYPE OF DRIVE	HYBRID
ENGINE HOURS	N/A
MAXIMUM SPEED	27 kn
CRUISING SPEED	21 kn
FUEL CONSUMPTION AT ECONOMICAL SPEED	N/A
FUEL	6000 l
GREY WATER	610 l
BLACK WATER	610 l
FRESH WATER	1500 l
DISPLACEMENT	73.6

[see more information about M/Y SEADECK 9 at www.nauyachts.com](http://www.nauyachts.com)



EXTERIOR AZIMUT SEADECK 9

M/Y SEADECK 9



EXTERIOR AZIMUT SEADECK 9

M/Y SEADECK 9



EXTERIOR AZIMUT SEADECK 9

M/Y SEADECK 9



EXTERIOR AZIMUT SEADECK 9

M/Y SEADECK 9



AFT MAIN DECK LOUNGE AREA

M/Y SEADECK 9



AFT MAIN DECK LOUNGE AREA

M/Y SEADECK 9



AFT MAIN DECK LOUNGE AREA

M/Y SEADECK 9



AFT MAIN DECK LOUNGE AREA

M/Y SEADECK 9



MAIN SALON LOUNGE AREA

M/Y SEADECK 9



MAIN SALON LOUNGE AREA

M/Y SEADECK 9



MAIN SALON LOUNGE AREA

M/Y SEADECK 9



MAIN SALON LOUNGE AREA

M/Y SEADECK 9



MASTER CABIN

M/Y SEADECK 9



MASTER CABIN

M/Y SEADECK 9



MASTER CABIN

M/Y SEADECK 9

General Arrangement



PROFILE

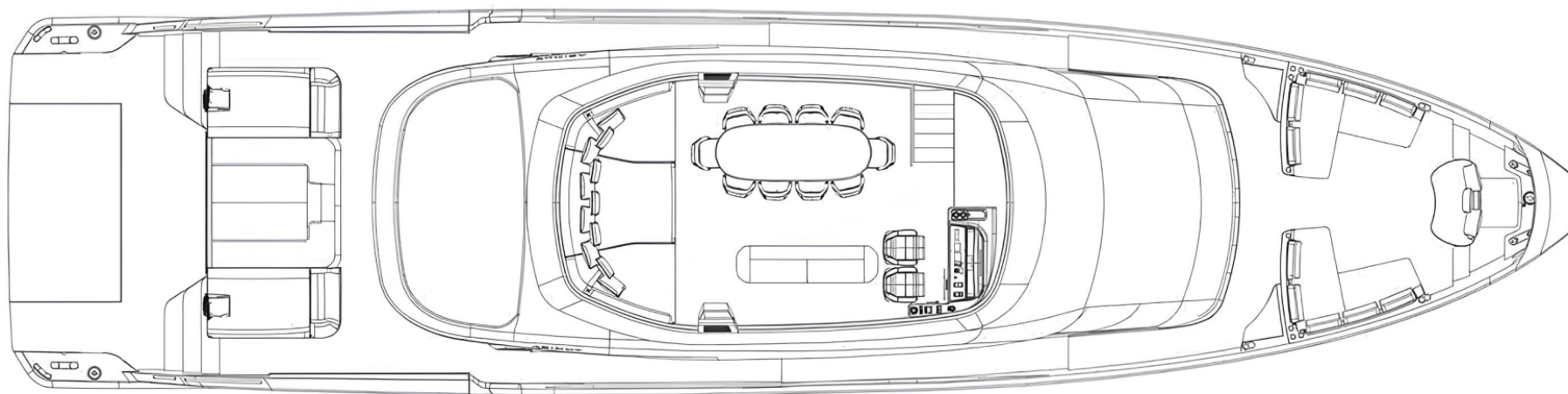

FLYBRIDGE

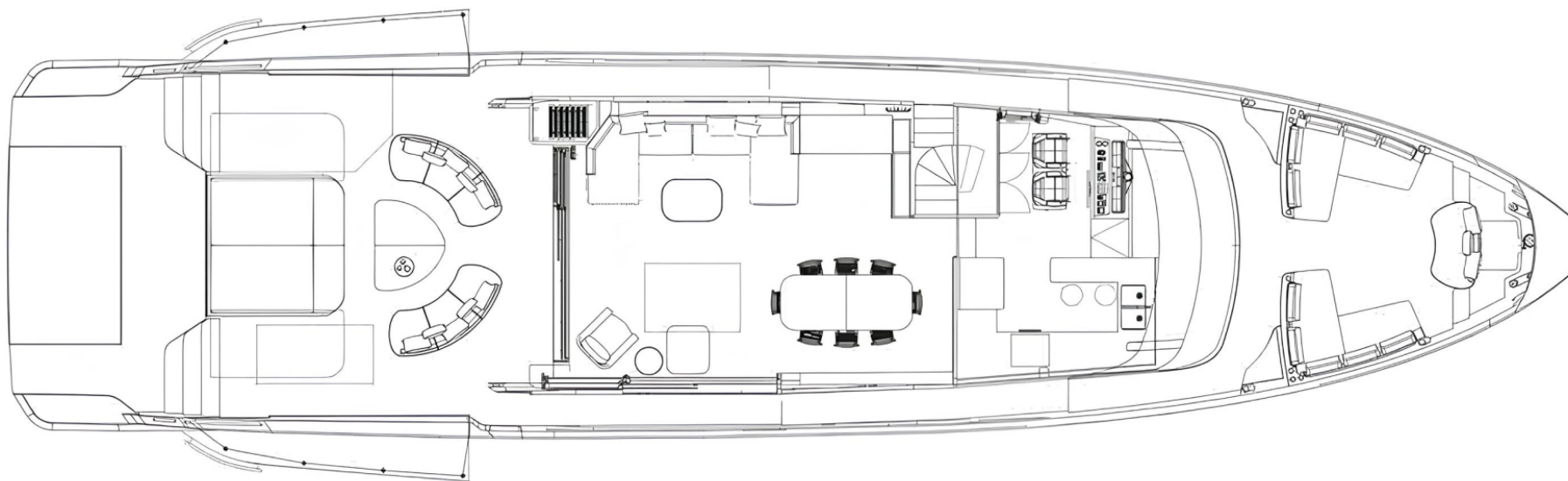

MAIN DECK

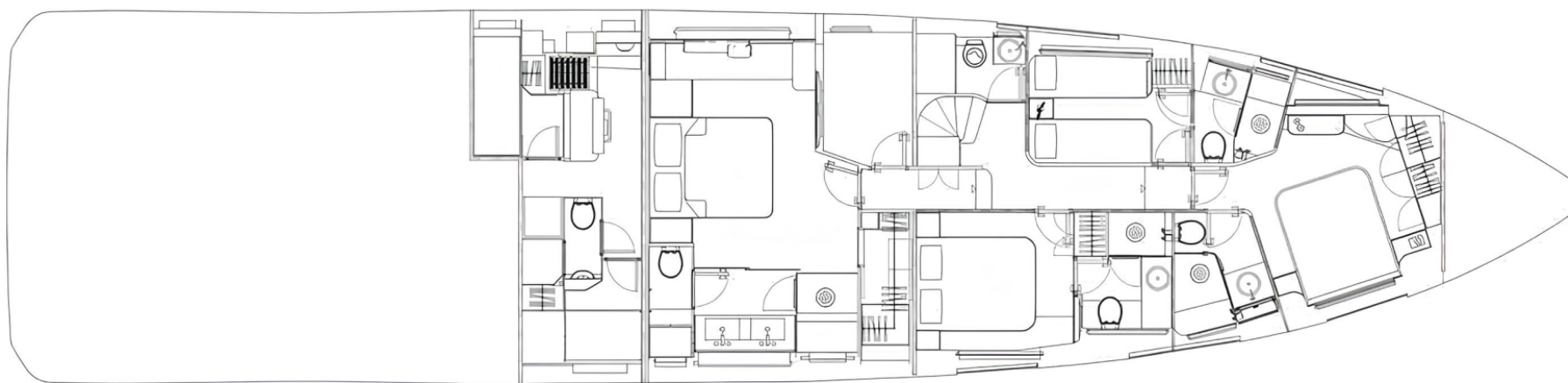

LOWER DECK



KIRILL KUATOV

+377 607 93 15 20

+39 333 576 44 44

 [Send e-mail](#)

 WhatsApp

 Telegram

[More information about M/Y SEADECK 9 at www.nauyachts.com](#)

[Watch video](#)