



New Build

NAU  
YACHTS

FLY 82

MOTOR YACHT    AZIMUT 24.79M    2028

FLAG -

MOTOR YACHT

## FLY 82



**Azimut Fly 82** is a 24.79-metre motor yacht designed for extended cruising, with a clear separation of living areas and a high level of onboard privacy. The exterior styling by Alberto Mancini preserves the dynamic proportions of the **Fly** series, conveying a sense of motion even at anchor. The GRP hull, incorporating carbon fibre elements, optimises structural weight and enhances overall efficiency. A key architectural feature is **Azimut's Deck2Deck™** system, which transforms the aft section into an open waterside terrace. The lifting transom increases the usable cockpit area and creates a direct connection to the sea, significantly expanding the functionality of the aft zone for relaxation and swimming. The interior, designed by Fabio Fantolino, is defined by a refined balance of textures and tones, with an emphasis on practicality and visual harmony. The main saloon is conceived as a dedicated space for socialising and entertaining, with well-defined zones that preserve a strong sense of volume. The layout accommodates up to eight guests in four cabins, all with en-suite bathrooms. Crew quarters are arranged separately, ensuring discreet service and enhanced comfort for guests. The flybridge features sunbathing areas, an outdoor dining space and a helm station. Propulsion is provided by three Volvo Penta IPS 1200 engines rated at 900 hp each, with an option to upgrade to IPS 1350, delivering a top speed of up to 32 knots and a cruising speed of around 25 knots. CE Category A certification confirms the yacht's capability for operation in open-sea conditions.

[see more information about M/Y FLY 82 at www.nauyachts.com](http://www.nauyachts.com)

# SPECIFICATION

SHIPYARD, MODEL	Azimut Fly 82
DELIVERY AT THE SHIPYARD	2028
LENGTH	24.79 m
WATERLINE LENGTH	21.87 m
HULL CONFIGURATION	PLANING
BEAM	5.87 m
RANGE	1500
DRAFT	1.7 m
GROSS TONNAGE	N/A
YACHT CLASS	CE CLASS A
CABINS	4+2
MASTER CABIN	LOWER DECK
GUESTS	8
BERTHS	8+3
CREW	3
HEADS	5+1

EXTERIOR DESIGN	ALBERTO MANCINI
INTERIOR DESIGN	FABIO FANTOLINO
HULL	GRP
SUPERSTRUCTURE	GRP
ENGINES	3 x Volvo Penta IPS 900 h.p.
TYPE OF DRIVE	VOLVO PENTA IPS
ENGINE HOURS	N/A
MAXIMUM SPEED	32 kn
CRUISING SPEED	25 kn
FUEL CONSUMPTION AT ECONOMICAL SPEED	~ 360 l/h
FUEL	5700 l
GREY WATER	425 l
BLACK WATER	425 l
FRESH WATER	1100 l
DISPLACEMENT	63.2

[see more information about M/Y FLY 82 at www.nauyachts.com](http://www.nauyachts.com)





EXTERIOR AZIMUT FLY 82

M/Y FLY 82





EXTERIOR AZIMUT FLY 82

M/Y FLY 82





EXTERIOR AZIMUT FLY 82

M/Y FLY 82





COCKPIT SEATING AREA

M/Y FLY 82





COCKPIT SEATING AREA

M/Y FLY 82





COCKPIT SEATING AREA

M/Y FLY 82





COCKPIT SEATING AREA

M/Y FLY 82





BOW LOUNGE AREA

M/Y FLY 82





BOW LOUNGE AREA

M/Y FLY 82





FLYBRIDGE LOUNGE AREA

M/Y FLY 82





FLYBRIDGE LOUNGE AREA

M/Y FLY 82





SECOND HELM STATION

M/Y FLY 82





FLYBRIDGE DINING AREA

M/Y FLY 82





FLYBRIDGE DINING AREA

M/Y FLY 82





MAIN SALON LOUNGE AREA

M/Y FLY 82





MAIN SALON LOUNGE AREA

M/Y FLY 82





MAIN SALON LOUNGE AREA

M/Y FLY 82





MAIN SALON LOUNGE AREA

M/Y FLY 82





MAIN SALON LOUNGE AREA

M/Y FLY 82





MAIN SALON LOUNGE AREA

M/Y FLY 82





MASTER CABIN

M/Y FLY 82





MASTER CABIN

M/Y FLY 82





MAKE-UP TABLE IN MASTER CABIN

M/Y FLY 82





VIP CABIN

M/Y FLY 82





VIP CABIN

M/Y FLY 82





VIP CABIN

M/Y FLY 82





GUEST CABIN

M/Y FLY 82



# General Arrangement



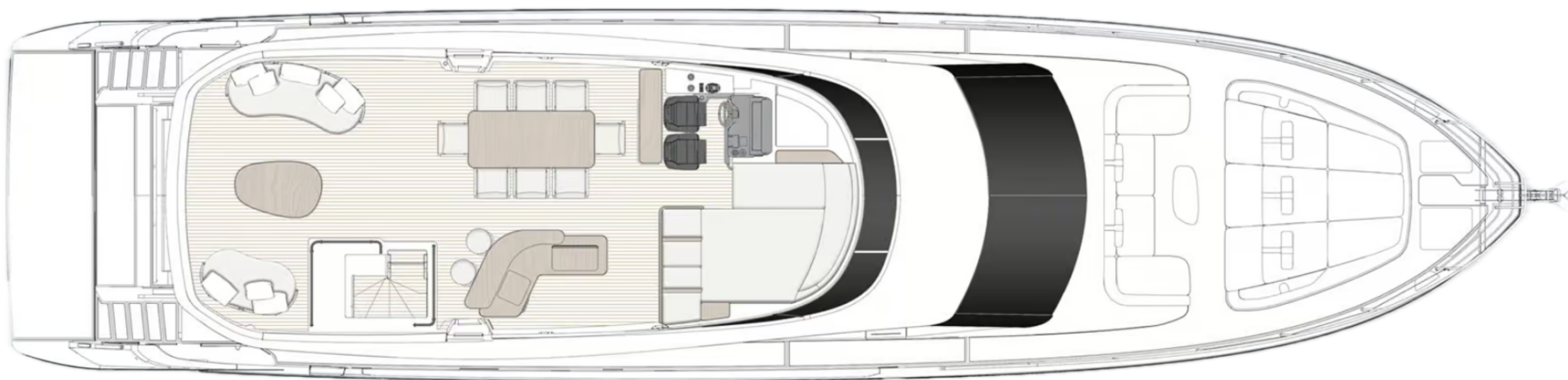

---

---

FLYBRIDGE



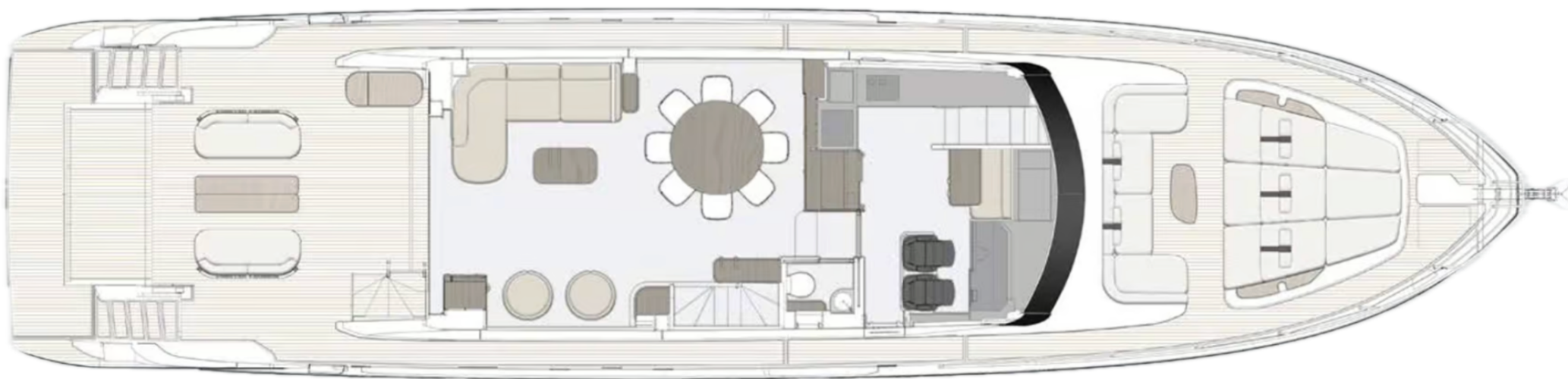

---

---

MAIN DECK





---

---

LOWER DECK





## KIRILL KUATOV

+377 607 93 15 20

+39 333 576 44 44

 [Send e-mail](#)

 WhatsApp

 Telegram

[More information about M/Y FLY 82 at www.nauyachts.com](http://www.nauyachts.com)

[Watch video](#)