



NAU  
YACHTS

96 SANREMO

MOTOR YACHT    AMER 28M    2026

FLAG -

MOTOR YACHT

## 96 SANREMO



**Amer 96 Sanremo** is a new 29-metre motor yacht by **Amer Yachts**, combining contemporary design, high cruising performance and a practical, well-balanced layout. The GRP hull with an aluminium superstructure and teak decks delivers a lightweight construction with confident, stable behaviour underway.

Powered by three Volvo Penta IPS engines, the yacht offers excellent manoeuvrability, easy docking and efficient fuel consumption. Fuel capacity of approximately 5,400 litres supports extended cruising, while a shallow draft of around 1.05 metres allows access to bays and anchorages that are off-limits to deeper-draft yachts.

The layout accommodates up to eight guests in four cabins, with two additional crew cabins ensuring discreet and professional service. The bright main-deck salon is visually connected to the exterior and flows seamlessly into the aft cockpit with an open-air dining area. Forward sun pads and a spacious flybridge with sun loungers, dining space and a helm station create comfortable outdoor areas for relaxation throughout the day.

**Amer 96 Sanremo** is a practical and well-balanced yacht designed for private ownership, offering a refined blend of comfort, performance and ease of use for dynamic and enjoyable cruising.

[see more information about M/Y 96 SANREMO at www.nauyachts.com](http://www.nauyachts.com)

# SPECIFICATION

SHIPYARD, MODEL	Amer 96 Sanremo
BUILT	2026
LENGTH	28 m
WATERLINE LENGTH	N/A
HULL CONFIGURATION	PLANING
BEAM	6.8 m
RANGE	N/A
DRAFT	1.05 m
GROSS TONNAGE	N/A
YACHT CLASS	CE CLASS A
CABINS	4+2
MASTER CABIN	LOWER DECK
GUESTS	8
BERTHS	8+3
CREW	3
HEADS	4+1

EXTERIOR DESIGN	ANTONIO LUXARDO
INTERIOR DESIGN	AMER YACHTS
HULL	GRP
SUPERSTRUCTURE	ALUMINIUM
ENGINES	2 x Volvo Penta IPS 1350 h.p.
TYPE OF DRIVE	VOLVO PENTA IPS
ENGINE HOURS	N/A
MAXIMUM SPEED	N/A
CRUISING SPEED	N/A
FUEL CONSUMPTION AT ECONOMICAL SPEED	N/A
FUEL	5400 l
GREY WATER	N/A
BLACK WATER	N/A
FRESH WATER	1900 l
DISPLACEMENT	N/A

[see more information about M/Y 96 SANREMO at www.nauyachts.com](http://www.nauyachts.com)





EXTERIOR AMER 96 SANREMO

M/Y 96 SANREMO





EXTERIOR AMER 96 SANREMO

M/Y 96 SANREMO





EXTERIOR AMER 96 SANREMO

M/Y 96 SANREMO





EXTERIOR AMER 96 SANREMO

M/Y 96 SANREMO





EXTERIOR AMER 96 SANREMO

M/Y 96 SANREMO





COCKPIT SEATING AREA

M/Y 96 SANREMO





COCKPIT DINING AREA

M/Y 96 SANREMO





BOW LOUNGE AREA

M/Y 96 SANREMO





FLYBRIDGE LOUNGE AREA

M/Y 96 SANREMO





MAIN SALON LOUNGE AREA

M/Y 96 SANREMO





MAIN SALON LOUNGE AREA

M/Y 96 SANREMO





MAIN SALON LOUNGE AREA

M/Y 96 SANREMO





MAIN SALON LOUNGE AREA

M/Y 96 SANREMO





MAIN SALON LOUNGE AREA

M/Y 96 SANREMO





MAIN SALON DINING AREA

M/Y 96 SANREMO





MAIN SALON DINING AREA

M/Y 96 SANREMO



# General Arrangement



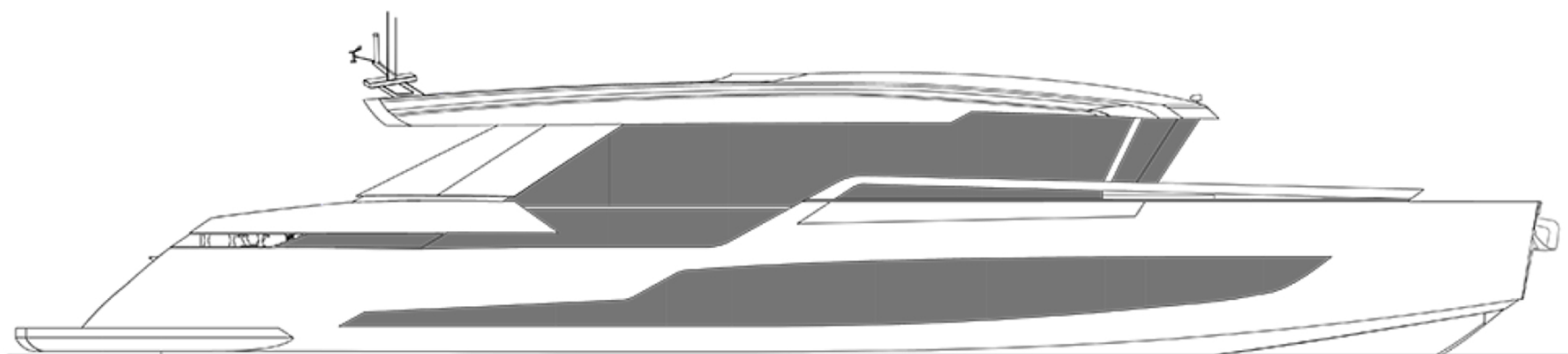

PROFILE



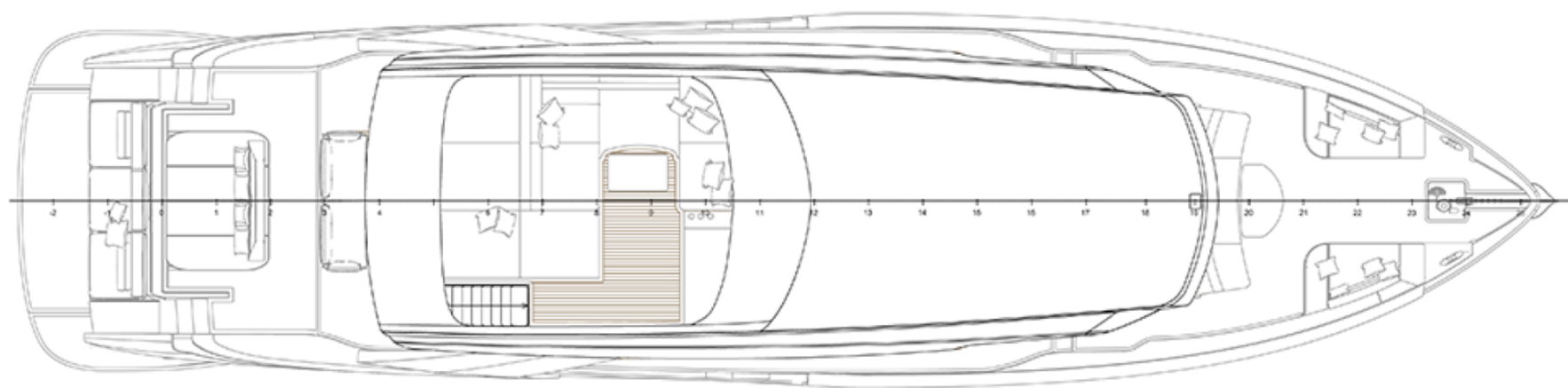

FLYBRIDGE



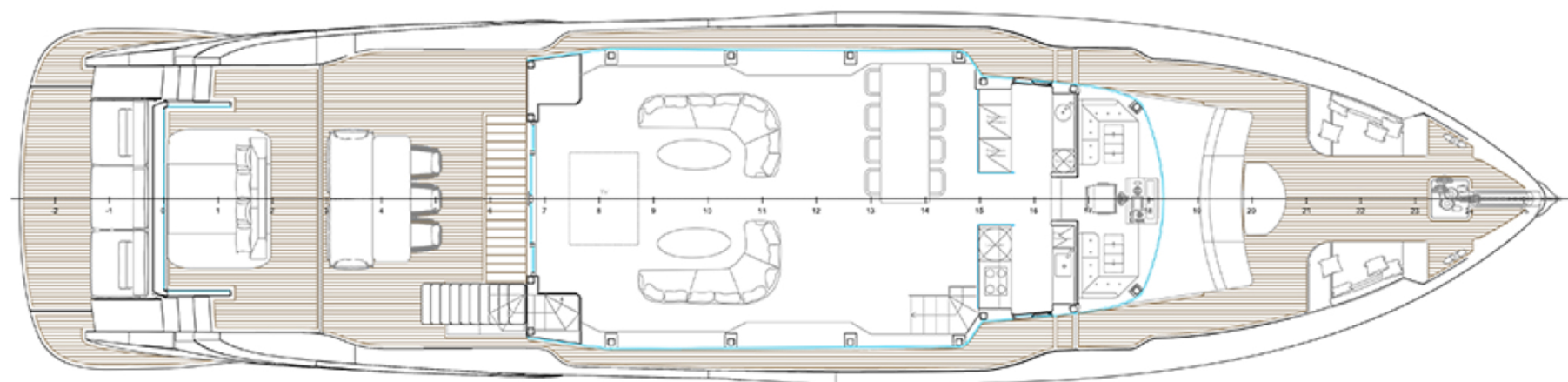

MAIN DECK



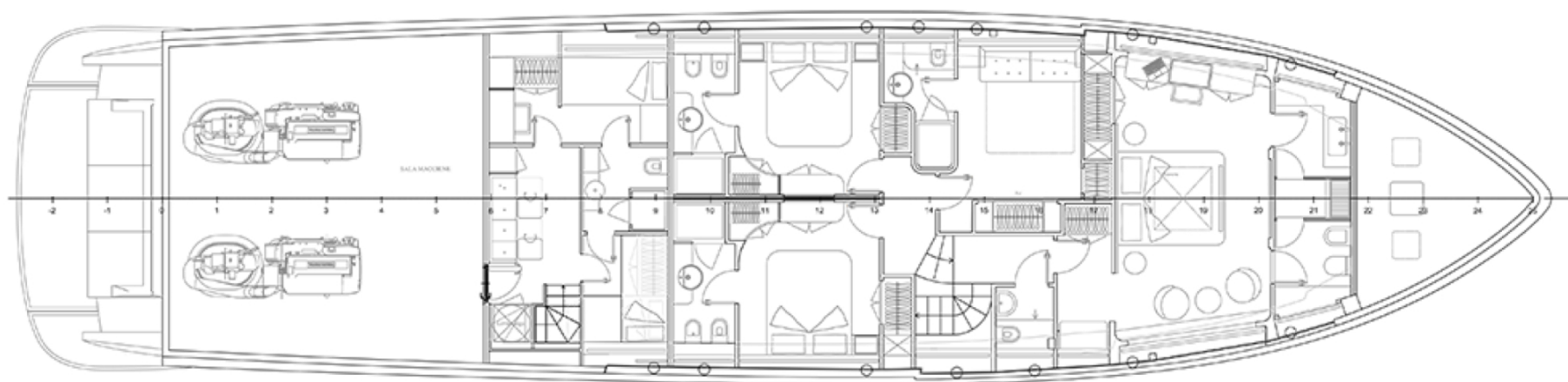

---

---

---

## LOWER DECK





KIRILL KUATOV

+377 607 93 15 20

+39 333 576 44 44

 [Send e-mail](#)

 WhatsApp

 Telegram