



Brokerage

NAU
YACHTS

MILOS AT SEA

SAILING YACHT CODECASA 35M 2000

€3,500,000
FLAG - GREECE

SAILING YACHT

MILOS AT SEA

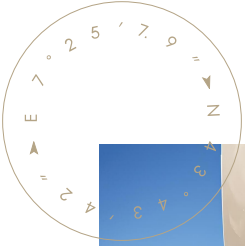

MILOS AT SEA is a 35-metre **Codecasa** motor yacht built in 2000 and refitted in 2022. Designed with a classic full-displacement hull and steel construction, she offers a smooth, stable and comfortable ride, particularly well suited to longer passages. A cruising speed of around 13 knots makes her ideal for relaxed cruising with efficient fuel consumption.

The yacht accommodates up to 10 guests in four en-suite cabins. The layout comprises two double cabins and two twin cabins with additional pullman berths, allowing flexible arrangements for different guest groups. All cabins feature private bathrooms. The main salon and the master cabin are located on the main deck and benefit from large windows that provide excellent natural light.

A professional crew of seven delivers a high level of service on board. The spacious flybridge serves as the main outdoor living area, offering sofas, sun loungers and an al fresco dining space with an open galley and barbecue - ideal for socialising and entertaining.

MILOS AT SEA is a well-balanced classic yacht, equally suitable for relaxed family cruising or more active holidays, with a proven technical platform and a practical layout for both charter and private use.

[see more information about S/Y MILOS AT SEA at www.nauyachts.com](http://www.nauyachts.com)

SPECIFICATION

SHIPYARD, MODEL	Codecasa 115
BUILT	2000
LENGTH	35 m
WATERLINE LENGTH	31.2 m
HULL CONFIGURATION	DISPLACEMENT
BEAM	7.3 m
RANGE	4100
DRAFT	2.2 m
GROSS TONNAGE	222 GT
YACHT CLASS	LLOYD'S
CABINS	4+3
MASTER CABIN	MAIN DECK
GUESTS	10
BERTHS	10+6
CREW	6
HEADS	4+3

EXTERIOR DESIGN	CODECASA
INTERIOR DESIGN	CODECASA
HULL	STEEL
SUPERSTRUCTURE	ALUMINIUM
ENGINES	3 x Caterpillar 3412C 1100 h.p.
TYPE OF DRIVE	SHAFT LINE
ENGINE HOURS	8364 h
MAXIMUM SPEED	15 kn
CRUISING SPEED	13 kn
FUEL CONSUMPTION AT ECONOMICAL SPEED	~ 200 l/h
FUEL	52000 l
GREY WATER	N/A
BLACK WATER	N/A
FRESH WATER	10000 l
DISPLACEMENT	198

[see more information about S/Y MILOS AT SEA at www.nauyachts.com](http://www.nauyachts.com)



EXTERIOR CODECASA 115 2000 MY MILOS AT
SEA

S/Y MILOS AT SEA



EXTERIOR CODECASA 115 2000 MY MILOS AT
SEA

S/Y MILOS AT SEA



EXTERIOR CODECASA 115 2000 MY MILOS AT
SEA

S/Y MILOS AT SEA



EXTERIOR CODECASA 115 2000 MY MILOS AT
SEA

S/Y MILOS AT SEA



EXTERIOR CODECASA 115 2000 MY MILOS AT
SEA

S/Y MILOS AT SEA



EXTERIOR CODECASA 115 2000 MY MILOS AT
SEA

S/Y MILOS AT SEA



EXTERIOR CODECASA 115 2000 MY MILOS AT
SEA

S/Y MILOS AT SEA



MASTER CABIN

S/Y MILOS AT SEA



FLYBRIDGE DINING AREA

S/Y MILOS AT SEA



FLYBRIDGE GRILL

S/Y MILOS AT SEA



FLYBRIDGE DINING AREA

S/Y MILOS AT SEA



BOW SUNBATHING AREA

S/Y MILOS AT SEA



BOW AREA

S/Y MILOS AT SEA



COCKPIT DINING AREA

S/Y MILOS AT SEA



COCKPIT DINING AREA

S/Y MILOS AT SEA



ENTRANCE TO THE MAIN SALON

S/Y MILOS AT SEA



MAIN SALON LOUNGE AREA

S/Y MILOS AT SEA



MAIN SALON

S/Y MILOS AT SEA



MAIN SALON DINING AREA

S/Y MILOS AT SEA



MASTER CABIN

S/Y MILOS AT SEA



MASTER BATHROOM

S/Y MILOS AT SEA



VIP CABIN

S/Y MILOS AT SEA



VIP BATHROOM

S/Y MILOS AT SEA



GUEST CABIN

S/Y MILOS AT SEA



GUEST CABIN

S/Y MILOS AT SEA



GUEST BATHROOM

S/Y MILOS AT SEA



GALLEY

S/Y MILOS AT SEA

General Arrangement

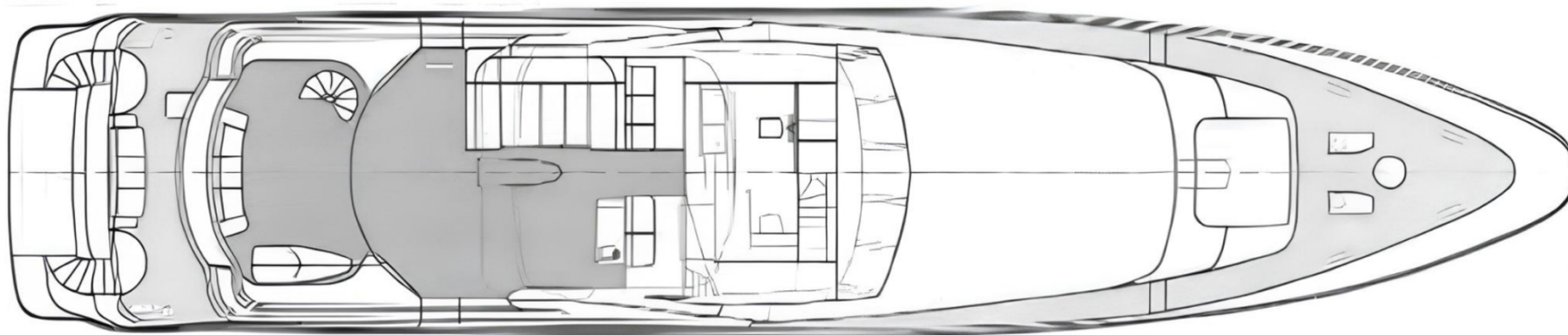

FLYBRIDGE

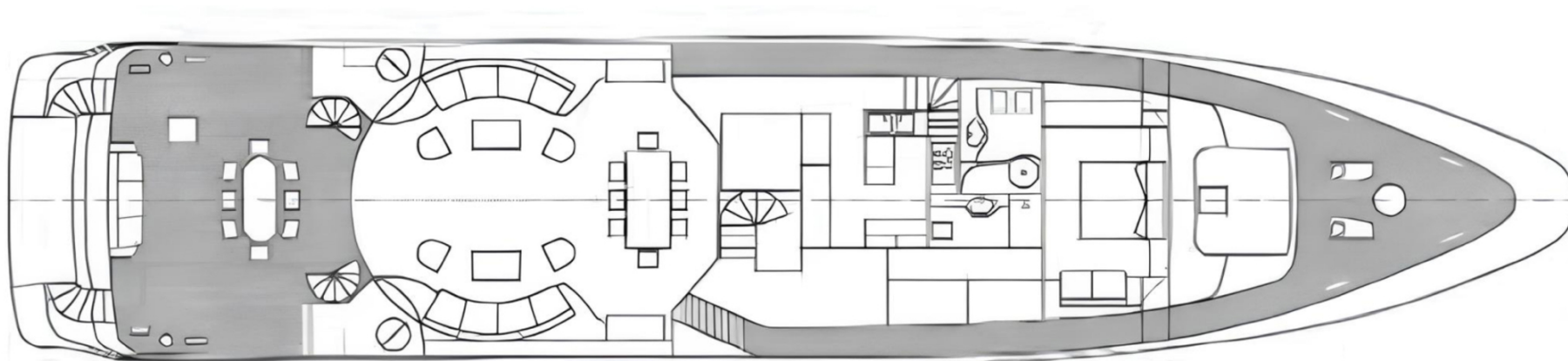

MAIN DECK

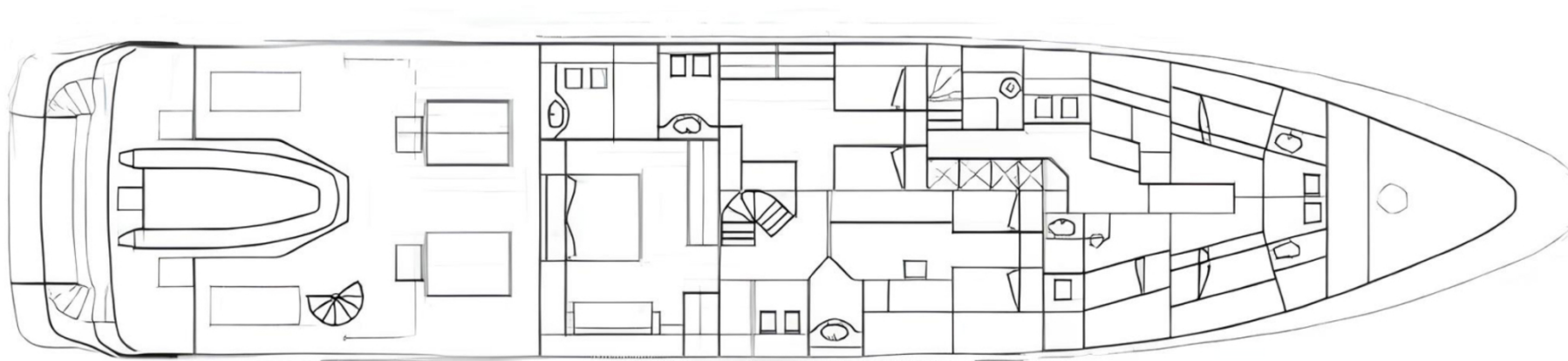

LOWER DECK



KIRILL KUATOV

+377 607 93 15 20

+39 333 576 44 44

 [Send e-mail](#)

 WhatsApp

 Telegram