



Brokerage

NAU  
YACHTS

MYTHOS G

MOTOR YACHT POSILLIPO 25.91M 2009

€1,350,000 (VAT paid)  
FLAG - MALTA

MOTOR YACHT

## MYTHOS G

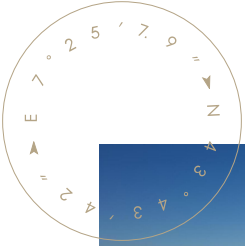

**MYTHOS G** is a 26-metre **Posillipo** motor yacht, consistently maintained to a high technical standard. In 2025, both main generators were replaced, further enhancing onboard reliability and operational efficiency. Her planing hull and twin MTU engines rated at 1,830 hp each deliver a comfortable cruising speed of 23 knots and a top speed of up to 29 knots, making her well suited for fast island-hopping and efficient coastal cruising.

She accommodates up to 10 guests in four cabins, including a full-beam Master suite, a VIP cabin, and two guest cabins with Pullman berths, offering flexible sleeping arrangements for families or mixed groups. All cabins feature en-suite bathrooms and have been refreshed as part of the recent refit.

The main salon, filled with natural light through panoramic windows, combines a lounge and dining area in a single, open space. Outside, the yacht offers several inviting deck areas, with sun pads on the foredeck, an alfresco dining area in the cockpit, and a flybridge with 360-degree views, a dining table, sun loungers, and a grill for relaxed open-air entertaining.

For water sports and fun on the water, **MYTHOS G** comes fully equipped with a 4.3-metre Zar tender, a Sea-Doo, two Seabob F5 units, SUP boards, inflatable toys, and snorkelling and fishing gear.

With commercial Maltese registration, low engine hours, and a professional crew of four, **MYTHOS G** represents a turnkey opportunity for both charter operations and private ownership, combining strong performance with a freshly updated, guest-friendly layout.

[see more information about M/Y MYTHOS G at www.nauyachts.com](http://www.nauyachts.com)



# SPECIFICATION

|                    |               |
|--------------------|---------------|
| SHIPYARD, MODEL    | Posillipo 85' |
| BUILT              | 2009          |
| LENGTH             | 25.91 m       |
| WATERLINE LENGTH   | 21.79 m       |
| HULL CONFIGURATION | PLANING       |
| BEAM               | 6.4 m         |
| RANGE              | 600           |
| DRAFT              | 2.44 m        |
| GROSS TONNAGE      | 65 GT         |
| YACHT CLASS        | CE            |
| CABINS             | 4+2           |
| MASTER CABIN       | LOWER DECK    |
| GUESTS             | 10            |
| BERTHS             | 10+4          |
| CREW               | 4             |
| HEADS              | 5+2           |

|                                      |                                |
|--------------------------------------|--------------------------------|
| EXTERIOR DESIGN                      | POSILLIPO YACHTS               |
| INTERIOR DESIGN                      | POSILLIPO YACHTS               |
| HULL                                 | GRP                            |
| SUPERSTRUCTURE                       | GRP                            |
| ENGINES                              | 2 x MTU 16V 2000 M91 2000 h.p. |
| TYPE OF DRIVE                        | SHAFT LINE                     |
| ENGINE HOURS                         | 1700 h                         |
| MAXIMUM SPEED                        | 29 kn                          |
| CRUSING SPEED                        | 23 kn                          |
| FUEL CONSUMPTION AT ECONOMICAL SPEED | ~ 130 l/h                      |
| FUEL                                 | 9960 l                         |
| GREY WATER                           | 420 l                          |
| BLACK WATER                          | 500 l                          |
| FRESH WATER                          | 1500 l                         |
| DISPLACEMENT                         | N/A                            |

[see more information about M/Y MYTHOS G at www.nauyachts.com](http://www.nauyachts.com)



### 1. COMMERCIAL MALTESE REGISTRATION

Fully charter-compliant with a proven charter track record and strong market demand, allowing the next owner to place the yacht into charter immediately and generate income from day one.



### 2. EU VAT PAID

The yacht is EU VAT paid, ensuring smooth ownership transfer and unrestricted use within EU waters.



### 3. LOW ENGINE HOURS

Only 1,700 engine hours for her year, well below market average, reflecting careful operation and strong technical condition.





EXTERIOR POSILLIPO 85 2009 MY MYTHOS G

M/Y MYTHOS G





EXTERIOR POSILLIPO 85 2009 MY MYTHOS G

M/Y MYTHOS G





EXTERIOR POSILLIPO 85 2009 MY MYTHOS G

M/Y MYTHOS G





EXTERIOR POSILLIPO 85 2009 MY MYTHOS G

M/Y MYTHOS G





EXTERIOR POSILLIPO 85 2009 MY MYTHOS G

M/Y MYTHOS G





AFT AREA

M/Y MYTHOS G





SWIMMING PLATFORM

M/Y MYTHOS G





COCKPIT DINING AREA

M/Y MYTHOS G





FLYBRIDGE LOUNGE AREA

M/Y MYTHOS G





FLYBRIDGE LOUNGE AREA

M/Y MYTHOS G





FLYBRIDGE LOUNGE AREA

M/Y MYTHOS G





FLYBRIDGE DINING AREA

M/Y MYTHOS G





BOW AREA

M/Y MYTHOS G





BOW SUNBATHING AREA

M/Y MYTHOS G





MAIN SALON LOUNGE AREA

M/Y MYTHOS G





MAIN SALON DINING AREA

M/Y MYTHOS G





MAIN SALON DINING AREA

M/Y MYTHOS G





MAIN SALON DINING AREA

M/Y MYTHOS G





MAIN SALON DINING AREA

M/Y MYTHOS G





MAIN SALON DINING AREA

M/Y MYTHOS G





MAIN SALON

M/Y MYTHOS G





MAIN HELM STATION

M/Y MYTHOS G





MASTER CABIN

M/Y MYTHOS G





MASTER CABIN

M/Y MYTHOS G





MASTER CABIN

M/Y MYTHOS G





MASTER CABIN

M/Y MYTHOS G





MASTER CABIN

M/Y MYTHOS G





MASTER CABIN

M/Y MYTHOS G





MASTER CABIN LOUNGE AREA

M/Y MYTHOS G





MASTER BATHROOM

M/Y MYTHOS G





MASTER BATHROOM

M/Y MYTHOS G





MASTER BATHROOM

M/Y MYTHOS G





VIP CABIN

M/Y MYTHOS G





VIP CABIN

M/Y MYTHOS G





VIP CABIN

M/Y MYTHOS G





VIP CABIN

M/Y MYTHOS G







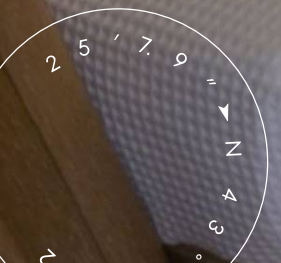

GUEST CABIN

M/Y MYTHOS G





GUEST CABIN

M/Y MYTHOS G





GUEST BATHROOM

M/Y MYTHOS G





GUEST CABIN

M/Y MYTHOS G





GUEST CABIN

M/Y MYTHOS G





GUEST CABIN

M/Y MYTHOS G





GUEST BATHROOM

M/Y MYTHOS G





GALLEY

M/Y MYTHOS G



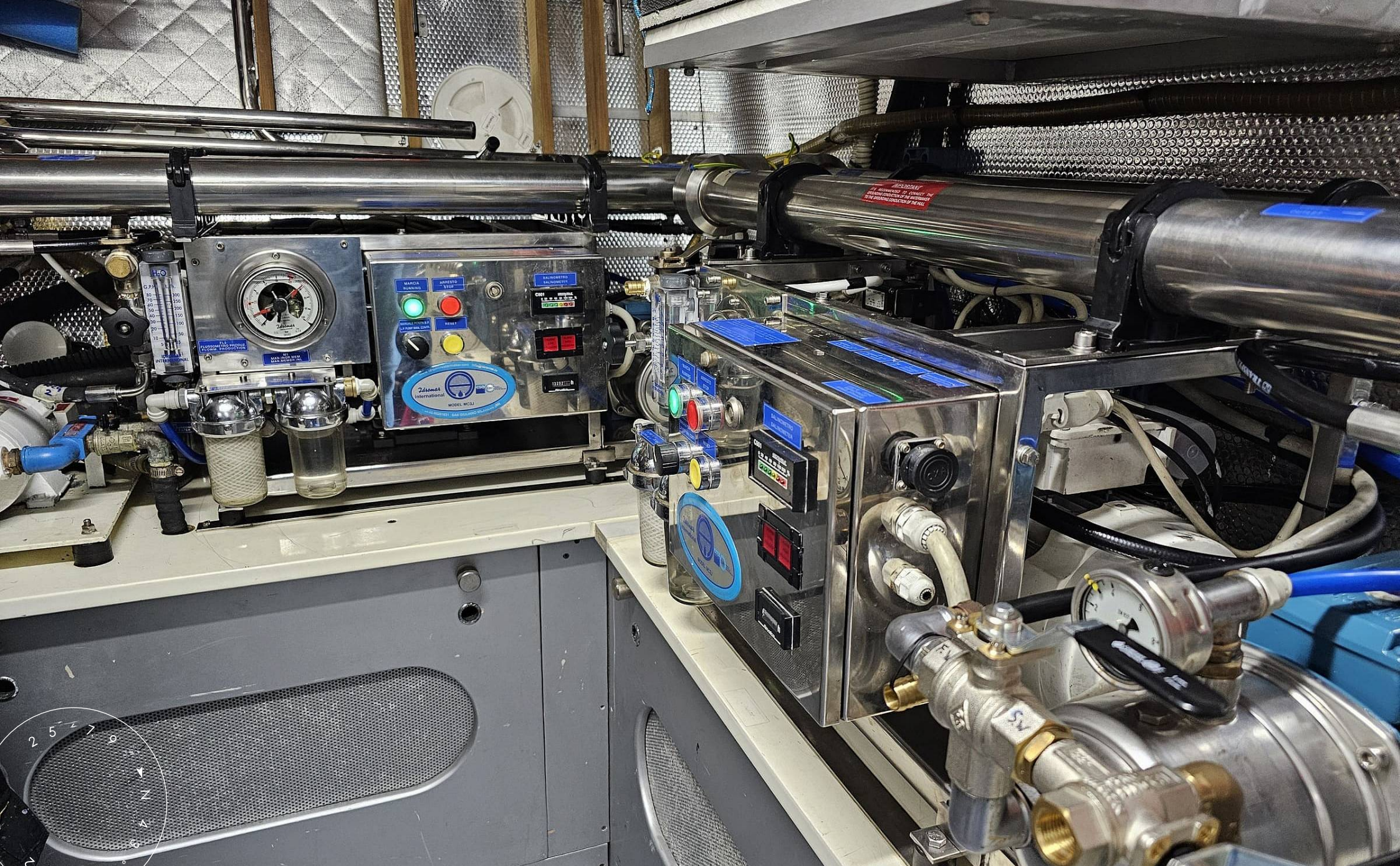

ENGINE ROOM

M/Y MYTHOS G





ENGINE ROOM

M/Y MYTHOS G



# General Arrangement



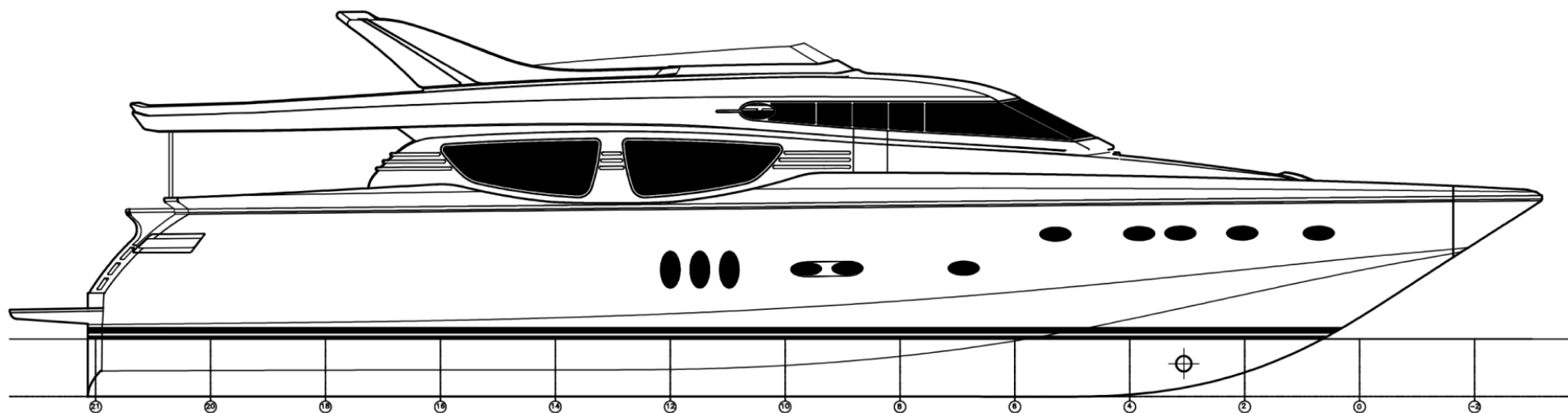

PROFILE



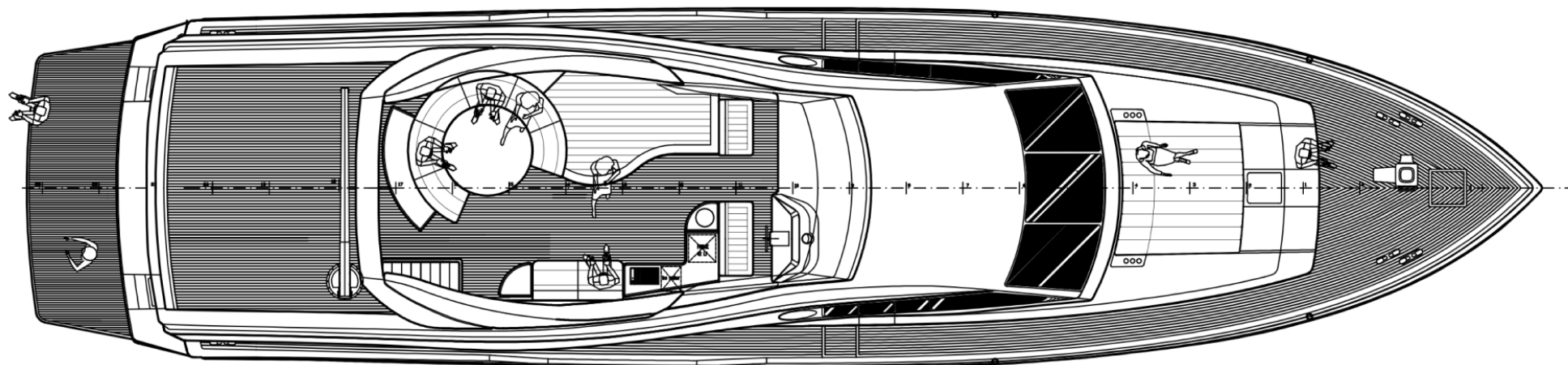

FLYBRIDGE



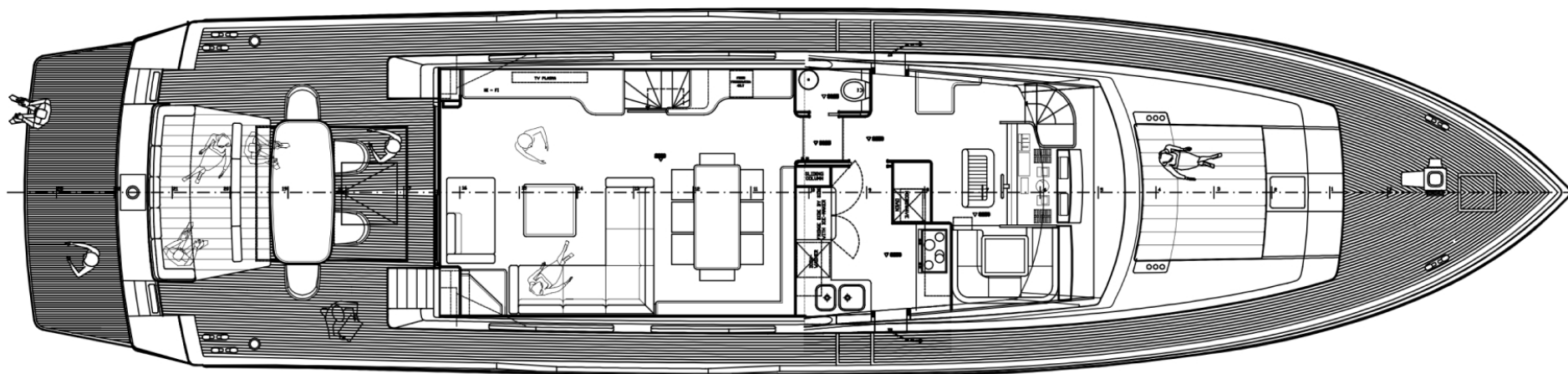

MAIN DECK



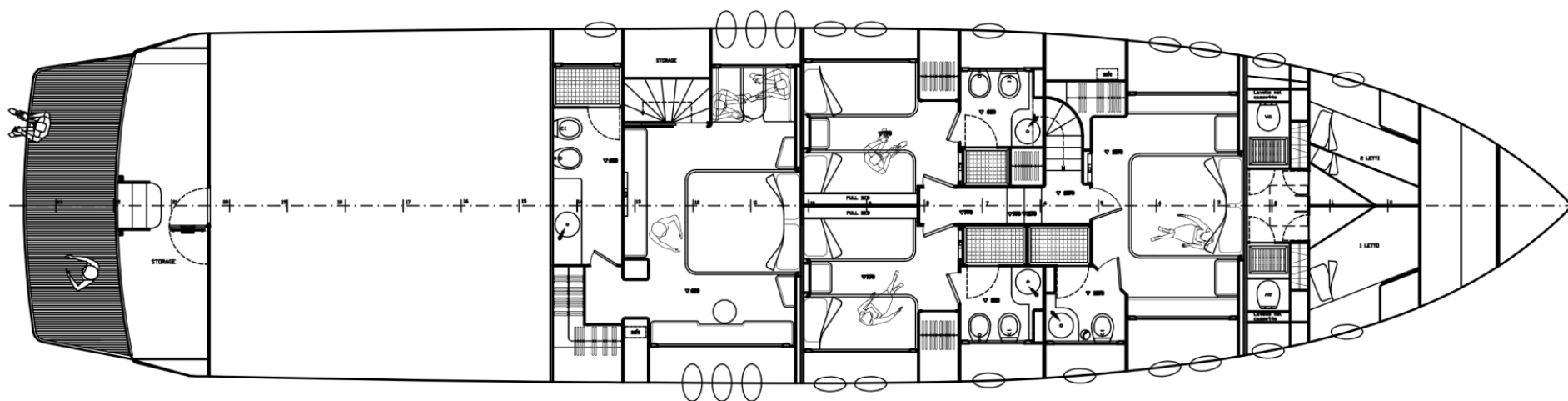

LOWER DECK



# EQUIPMENT

| GENERAL  | EXTERIOR   | INTERIOR  | ELECTRONICS AND NAVIGATION  | OTHER  |
|--|--|---|---|--|
| <ul style="list-style-type: none"><li>• Refits: 2021–2025 • Regular annual MTU service • Diesel generator service every 250 running hours • Complete cleaning of all MTU coolers • Replacement of MTU sea water pumps with new units • Turbocharger overhaul: – complete replacement of one turbocharger – repair of three turbocharger housings, including rectification of minor cracks • Service of MTU starters and alternators • Replacement of MTU crankcase gaskets • Replacement of all hoses and valve position indicator wiring • Engine room air duct service (4 lines) • Inspection and sea trials carried out by an authorized MTU service center • Main engines service (Bilialis, 2025) • Replacement ...</li></ul> | <ul style="list-style-type: none"><li>• Refits: 2021–2025 • Fabrication and installation of bimini on the flybridge (full cover) • Repair and reinforcement of wooden structures on the flybridge • Bow deck repair with structural reinforcement and anti-wrinkle protection • Replacement of teak joints from black to grey on the main deck and platform • Replacement of rubber seals on main deck windows • Yacht logo renewal • Addition of 25 meters of anchor chain • Crane maintenance • Gangway maintenance (removal and reinstallation) • Replacement of all sofa seats in the salon and on exterior decks • Full hull polishing (performed in multiple stages)</li></ul> | <ul style="list-style-type: none"><li>• Refits: 2021–2025 • Installation of 5 new Smart TVs • Complete Wi-Fi system upgrade throughout the yacht • Replacement of carpets, curtains, and blinds in all areas • New bed linen throughout • Full replacement of all kitchen utensils • Installation of new appliances: – Electric stove and hob – Refrigerator – Washer-dryer • Replacement of mattresses in guest cabins • New ice maker installed • Installation of new dishwasher and freezer • Two new SUPs purchased</li></ul> | <ul style="list-style-type: none"><li>• Refits: 2021–2025 • Installation of CCTV recorder • Satellite system repair • Installation of new amplifier • New GPS plotter on the flybridge • Replacement of 5 underwater lights • Installation of new bow thruster • Stern thruster maintenance • Installation of new battery charger • Full replacement of all batteries (36 units) • Full service of all onboard pumps: – Grey and black water – Bilge – Air-conditioning – Fire – Fresh water (2 lines) – New pumps for desalination • Replacement of water heater • Creation of bypass for pumping grey and black water • Service of all air-conditioning units • Replacement of motor in the ...</li></ul> | <ul style="list-style-type: none"><li>• Yacht hauled out for maintenance (carnagio) in: – April 2021 – April 2022 – February 2024 • Each time: – Complete removal of old antifouling – Application of new antifouling coating – Inspection of shafts and propellers • Replacement of all anodes • Local repairs and painting of gelcoat damage • Repair and painting of tender and engine covers • Teak cleaning and painting • Full replacement of Sikaflex on: – Flybridge – Windshield and side windows – All yacht windows</li></ul> |





KIRILL KUATOV

+377 607 93 15 20

+39 333 576 44 44

 [Send e-mail](#)

 WhatsApp

 Telegram