



Brokerage

NAU
YACHTS

CHAMPAGNE AND CAVIAR

MOTOR YACHT

CUSTOM LINE 34.14M

2003

€3,890,000 (VAT paid)
FLAG - MALTA

MOTOR YACHT

CHAMPAGNE AND CAVIAR

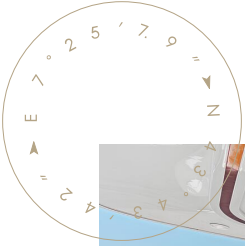

M/Y CHAMPAGNE AND CAVIAR - Custom Line 112 is a 34-meter motor yacht built in 2003 and fully refitted in 2024. She accommodates up to 12 guests in five cabins: a full-beam Owner's suite, two VIP cabins, and two double guest cabins with additional Pullman berths. Seven crew members ensure seamless service, with dedicated crew quarters completely separate from guest areas.

The interiors feature warm American walnut, with the main saloon combining a U-shaped lounge, multimedia system, bar, and glass dining table, creating an inviting space for socializing and formal or informal dining.

Multiple outdoor living areas enhance onboard leisure: the cockpit offers sun loungers and a dining area, the flybridge features a Bimini-covered lounge with bar, and the foredeck is ideal for sunbathing or enjoying cocktails. The yacht is equipped with a swim platform, garage, and an extensive water toy inventory, including a tender Antudo 23, Seabob, jet skis, inflatable platforms, SUPs, and wakeboards, offering a versatile and engaging waterside experience.

CHAMPAGNE AND CAVIAR is powered by twin MTU 16V 2000 M91 engines, achieving a cruising speed of 13 knots and a top speed of 24 knots. Fin stabilizers ensure comfort both underway and at anchor. Thanks to the recent refit, functional layout, and excellent technical condition, she is ready for immediate operation, ideal for both private use and charter.

see more information about M/Y CHAMPAGNE AND CAVIAR at www.nauyachts.com

SPECIFICATION

SHIPYARD, MODEL	Custom Line 112
BUILT	2003
LENGTH	34.14 m
WATERLINE LENGTH	30.23 m
HULL CONFIGURATION	SEMI-DISPLACEMENT
BEAM	6.9 m
RANGE	1800
DRAFT	1.37 m
GROSS TONNAGE	213 GT
YACHT CLASS	RINA
CABINS	5+4
MASTER CABIN	MAIN DECK
GUESTS	12
BERTHS	12+7
CREW	7
HEADS	6+4

EXTERIOR DESIGN	ZUCCON INTERNATIONAL PROJECT
INTERIOR DESIGN	ZUCCON INTERNATIONAL PROJECT
HULL	GRP
SUPERSTRUCTURE	GRP
ENGINES	2 x MTU 16V 2000 M91 1972 h.p.
TYPE OF DRIVE	SHAFT LINE
ENGINE HOURS	5800 h
MAXIMUM SPEED	24 kn
CRUISING SPEED	13 kn
FUEL CONSUMPTION AT ECONOMICAL SPEED	~ 190 l/h
FUEL	19963 l
GREY WATER	N/A
BLACK WATER	N/A
FRESH WATER	3000 l
DISPLACEMENT	109

[see more information about M/Y CHAMPAGNE AND CAVIAR at www.nauyachts.com](http://www.nauyachts.com)



EXTERIOR CUSTOM LINE 112 2003 MY
CHAMPAGNE AND CAVIAR

M/Y CHAMPAGNE AND CAVIAR



EXTERIOR CUSTOM LINE 112 2003 MY
CHAMPAGNE AND CAVIAR

M/Y CHAMPAGNE AND CAVIAR



EXTERIOR CUSTOM LINE 112 2003 MY
CHAMPAGNE AND CAVIAR

M/Y CHAMPAGNE AND CAVIAR



EXTERIOR CUSTOM LINE 112 2003 MY
CHAMPAGNE AND CAVIAR

M/Y CHAMPAGNE AND CAVIAR



EXTERIOR CUSTOM LINE 112 2003 MY
CHAMPAGNE AND CAVIAR

M/Y CHAMPAGNE AND CAVIAR



COCKPIT DINING AREA

M/Y CHAMPAGNE AND CAVIAR



FLYBRIDGE LOUNGE AREA

M/Y CHAMPAGNE AND CAVIAR



FLYBRIDGE LOUNGE AREA

M/Y CHAMPAGNE AND CAVIAR



MAIN SALON LOUNGE AREA

M/Y CHAMPAGNE AND CAVIAR



MAIN SALON DINING AREA

M/Y CHAMPAGNE AND CAVIAR



MAIN HELM STATION

M/Y CHAMPAGNE AND CAVIAR



MASTER CABIN

M/Y CHAMPAGNE AND CAVIAR



MASTER CABIN

M/Y CHAMPAGNE AND CAVIAR



MASTER BATHROOM

M/Y CHAMPAGNE AND CAVIAR



VIP CABIN

M/Y CHAMPAGNE AND CAVIAR



GUEST CABIN

M/Y CHAMPAGNE AND CAVIAR



MASSAGE ROOM

M/Y CHAMPAGNE AND CAVIAR

General Arrangement

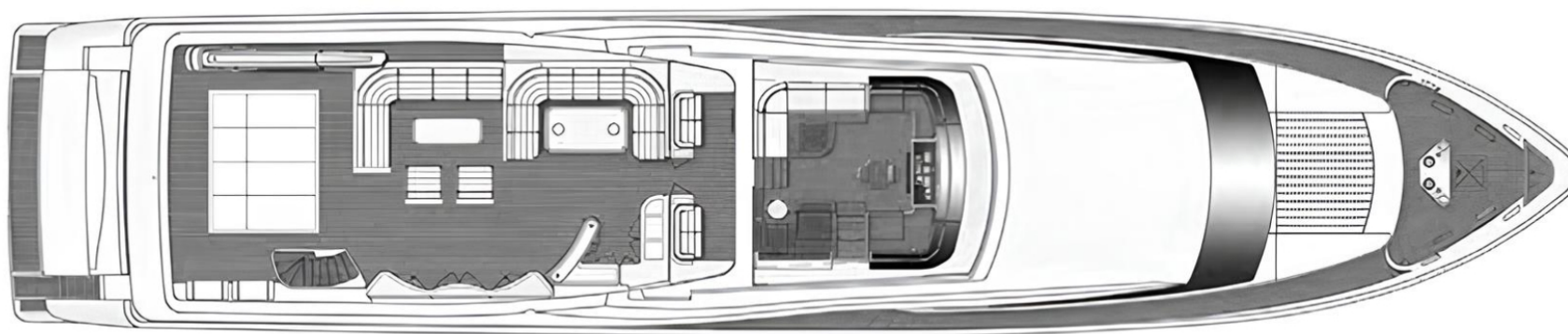

FLYBRIDGE

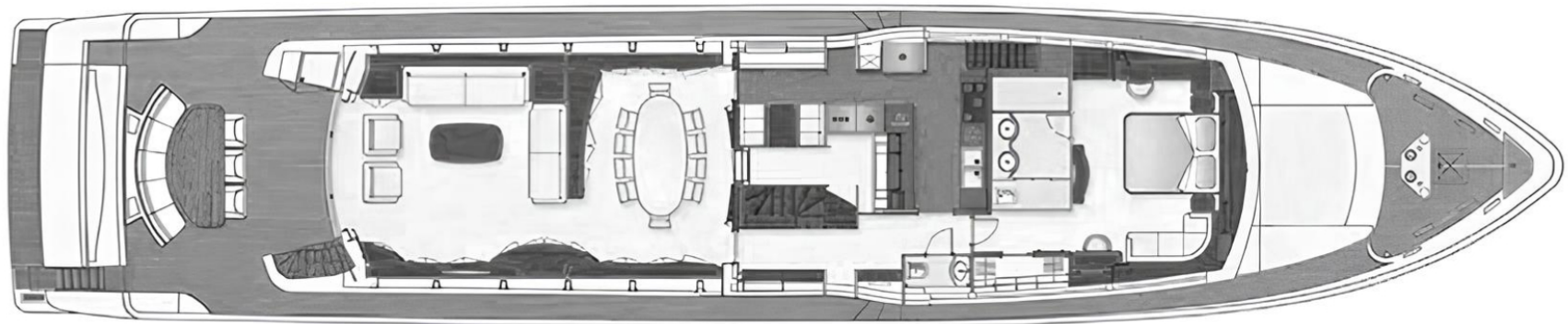

MAIN DECK

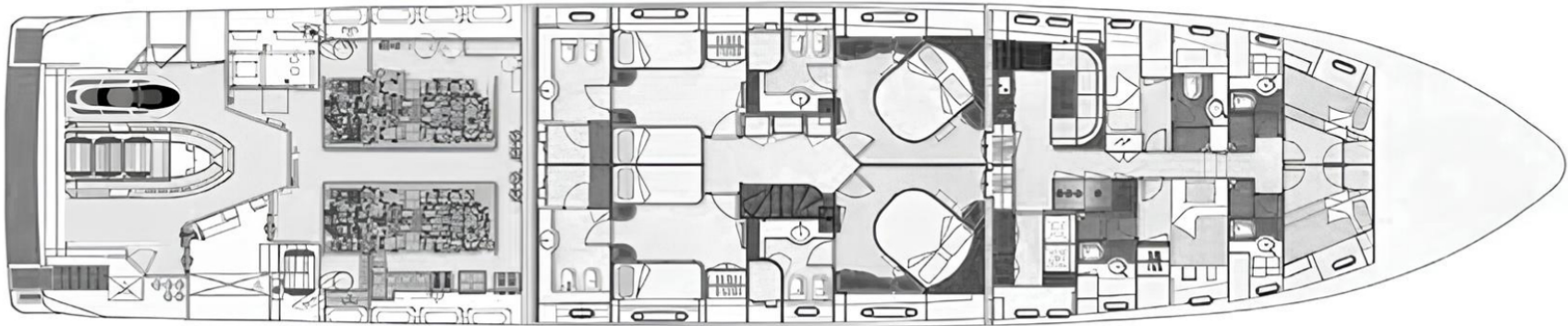

LOWER DECK



KIRILL KUATOV

+377 607 93 15 20

+39 333 576 44 44

 [Send e-mail](#)

 WhatsApp

 Telegram

[More information about M/Y CHAMPAGNE AND CAVIAR at www.nauyachts.com](#)

[Watch video](#)