



New Build

NAU  
YACHTS

WAJER 77

MOTOR YACHT   WAJER 23.45M   2027

FLAG -

MOTOR YACHT

## WAJER 77

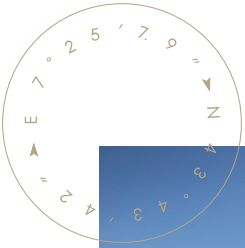

**Wajer 77** is a high-performance motor yacht measuring 16.83 meters in length and 4.65 meters in width, designed for both comfort and speed. It accommodates up to 20 passengers and offers highly functional space.

Equipped with three Volvo Penta IPS 600 D6-440hp engines, the yacht reaches a top speed of 38 knots and a cruising speed of 25 knots. For enhanced performance, Volvo Penta IPS 650 D6-480hp engines can be installed. Fuel consumption is 150 liters per hour at cruising speed (with IPS 650 engines).

The deck features two large tables, sun loungers, and relaxation areas. The cockpit is equipped with Wajer seats, a joystick for maneuvering, and two touchscreens for easy control. The central lounge area includes a bar with a fridge, sink, and grill for outdoor dining. The yacht also comes with a hydraulic platform for easy boarding and optional gyro stabilizers for enhanced comfort at anchor.

Below deck, the yacht has a master cabin with a double bed and a guest cabin with a bunk bed and an en-suite bathroom. The kitchen is equipped with a fridge, coffee machine, and ice maker, while the bathroom includes a shower, sink, and toilet.

[see more information about M/Y WAJER 77 at www.nauyachts.com](http://www.nauyachts.com)

# SPECIFICATION

SHIPYARD, MODEL	Wajer Wajer 77
BUILT	2027
LENGTH	23.45 m
WATERLINE LENGTH	20.68 m
HULL CONFIGURATION	PLANING
BEAM	5.8 m
RANGE	350
DRAFT	1.8 m
GROSS TONNAGE	N/A
YACHT CLASS	CE (B)
CABINS	3
MASTER CABIN	LOWER DECK
GUESTS	20
BERTHS	6
CREW	N/A
HEADS	3

EXTERIOR DESIGN	SINOT YACHT ARCHITECTURE & DESIGN
INTERIOR DESIGN	SINOT YACHT ARCHITECTURE & DESIGN
HULL	GRP
SUPERSTRUCTURE	GRP
ENGINES	3 x Volvo Penta IPS 1200 D13 900 h.p.
TYPE OF DRIVE	VOLVO PENTA IPS
ENGINE HOURS	N/A
MAXIMUM SPEED	37 kn
CRUSING SPEED	25 kn
FUEL CONSUMPTION AT ECONOMICAL SPEED	~ 350 l/h
FUEL	4795 l
GREY WATER	N/A
BLACK WATER	305 l
FRESH WATER	760 l
DISPLACEMENT	51

[see more information about M/Y WAJER 77 at www.nauyachts.com](http://www.nauyachts.com)



EXTERIOR WAJER 77

M/Y WAJER 77



EXTERIOR WAJER 77

M/Y WAJER 77



EXTERIOR WAJER 77

M/Y WAJER 77



EXTERIOR WAJER 77

M/Y WAJER 77



EXTERIOR WAJER 77

M/Y WAJER 77



EXTERIOR WAJER 77

M/Y WAJER 77



EXTERIOR WAJER 77

M/Y WAJER 77



EXTERIOR WAJER 77

M/Y WAJER 77



EXTERIOR WAJER 77

M/Y WAJER 77



BOW LOUNGE AREA

M/Y WAJER 77



COCKPIT SEATING AREA

M/Y WAJER 77



MAIN SALON

M/Y WAJER 77



MAIN HELM STATION

M/Y WAJER 77



MASTER CABIN

M/Y WAJER 77



MASTER CABIN

M/Y WAJER 77

# General Arrangement

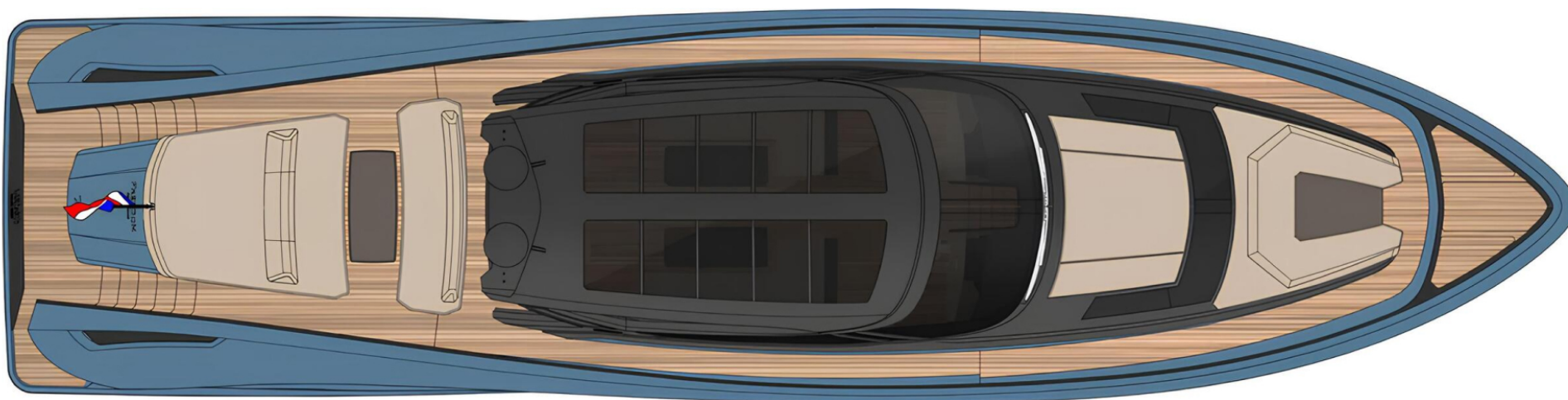

TOP VIEW



MAIN DECK V1



MAIN DECK V2

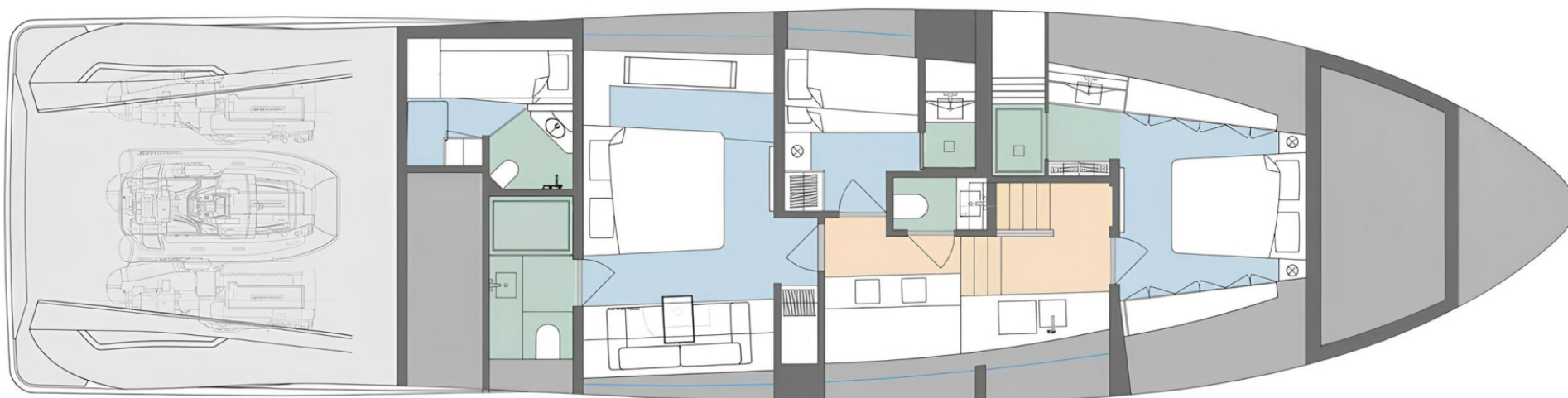

---

---

---

## LOWER DECK



## KIRILL KUATOV

+377 607 93 15 20

+39 333 576 44 44

 [Send e-mail](#)

 WhatsApp

 Telegram

[More information about M/Y WAJER 77 at www.nauyachts.com](#)

[Watch video](#)