



Brokerage

NAU
YACHTS

SEA BEAR

MOTOR YACHT BENETTI 28.5M 2013

€2,650,000

FLAG - UK

MOTOR YACHT

SEA BEAR

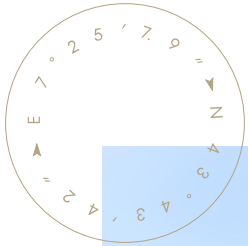

SEA BEAR is a 28.5-meter motor yacht built in 2013 by **Benetti Yachts**, designed by Stefano Righini, who was responsible for both the exterior and naval architecture. The interiors were created by Carlo Galeazzi, reflecting a classic Italian style focused on comfort and functionality.

The layout accommodates up to nine guests across five cabins, each with en-suite facilities. The master suite is located forward on the main deck. The lower deck features two VIP cabins, a twin cabin, and an additional flexible cabin that can be used either as an office or a full guest cabin. Crew quarters consist of three cabins for up to five crew members, including a dedicated captain's cabin.

She is powered by twin MTU 8V 2000 M72 engines, each producing 965 hp with approximately 2,290 running hours. **SEA BEAR** reaches a top speed of 14 knots and cruises comfortably at around 11.5 knots, with a range of up to 1,500 nautical miles. Fuel consumption at cruising speed is approximately 350 l/h. For added comfort, she is equipped with stabilizers by CMC Marine, as well as hydraulic bow and stern thrusters.

The onboard power system includes twin Kohler 33 kW generators, Mastervolt chargers, an inverter, and a modern power distribution system. Climate control is managed by Frigomar air conditioning, while a Idromar watermaker (250 l/h) supports extended cruising autonomy.

The main deck is arranged with an aft lounge area flowing into the main saloon with soft seating, followed by a formal dining area for up to 10 guests. The galley is positioned forward with a separate crew access and is fully equipped with Miele appliances, including a cooktop, oven, microwave, dishwasher, and refrigeration units.

Onboard amenities include multimedia systems with TVs in the saloon and cabins, an audio system, an ice maker, and additional refrigeration.

SEA BEAR has been privately operated and regularly maintained and upgraded, presenting a well-kept example of a proven Benetti platform suited for comfortable long-range cruising.

[see more information about M/Y SEA BEAR at www.nauyachts.com](http://www.nauyachts.com)

SPECIFICATION

SHIPYARD, MODEL	Benetti Delfino 93'
BUILT	2013
LENGTH	28.5 m
WATERLINE LENGTH	3.97 m
HULL CONFIGURATION	DISPLACEMENT
BEAM	7.03 m
RANGE	1500
DRAFT	1.98 m
GROSS TONNAGE	104.95 GT
YACHT CLASS	RINA
CABINS	5+3
MASTER CABIN	MAIN DECK
GUESTS	9
BERTHS	9+5
CREW	5
HEADS	5+2

EXTERIOR DESIGN	STEFANO RIGHINI DESIGN
INTERIOR DESIGN	CARLO GALEAZZI
HULL	GRP
SUPERSTRUCTURE	GRP
ENGINES	2 x MTU 8V 2000 M72 965 h.p.
TYPE OF DRIVE	SHAFT LINE
ENGINE HOURS	2290 h
MAXIMUM SPEED	14 kn
CRUSING SPEED	11.5 kn
FUEL CONSUMPTION AT ECONOMICAL SPEED	~ 350 l/h
FUEL	14000 l
GREY WATER	1200 l
BLACK WATER	1200 l
FRESH WATER	2600 l
DISPLACEMENT	135

[see more information about M/Y SEA BEAR at www.nauyachts.com](http://www.nauyachts.com)



EXTERIOR BENETTI DELFINO 93 2013 MY SEA
BEAR

M/Y SEA BEAR



EXTERIOR BENETTI DELFINO 93 2013 MY SEA
BEAR

M/Y SEA BEAR



EXTERIOR BENETTI DELFINO 93 2013 MY SEA
BEAR

M/Y SEA BEAR



EXTERIOR BENETTI DELFINO 93 2013 MY SEA
BEAR

M/Y SEA BEAR

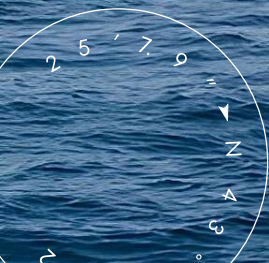

EXTERIOR BENETTI DELFINO 93 2013 MY SEA
BEAR

M/Y SEA BEAR



AFT AREA

M/Y SEA BEAR



AFT MAIN DECK LOUNGE AREA

M/Y SEA BEAR



AFT MAIN DECK DINING AREA

M/Y SEA BEAR



BOW LOUNGE AREA

M/Y SEA BEAR



BOW LOUNGE AREA

M/Y SEA BEAR



FLYBRIDGE LOUNGE AREA

M/Y SEA BEAR



FLYBRIDGE DINING AREA

M/Y SEA BEAR



FLYBRIDGE BAR

M/Y SEA BEAR



FLYBRIDGE BAR

M/Y SEA BEAR



FLYBRIDGE LOUNGE AREA

M/Y SEA BEAR



MAIN SALON LOUNGE AREA

M/Y SEA BEAR



MAIN SALON DINING AREA

M/Y SEA BEAR



MAIN SALON DINING AREA

M/Y SEA BEAR



MAIN HELM STATION

M/Y SEA BEAR



MASTER CABIN

M/Y SEA BEAR



MASTER CABIN

M/Y SEA BEAR



MASTER BATHROOM

M/Y SEA BEAR



STAIRS FROM MD TO LD

M/Y SEA BEAR



VIP CABIN

M/Y SEA BEAR



VIP CABIN

M/Y SEA BEAR



VIP BATHROOM

M/Y SEA BEAR



VIP BATHROOM

M/Y SEA BEAR



VIP CABIN

M/Y SEA BEAR



VIP BATHROOM

M/Y SEA BEAR



GUEST CABIN

M/Y SEA BEAR



GUEST BATHROOM

M/Y SEA BEAR



GALLEY

M/Y SEA BEAR



ENGINE ROOM

M/Y SEA BEAR

General Arrangement



PROFILE

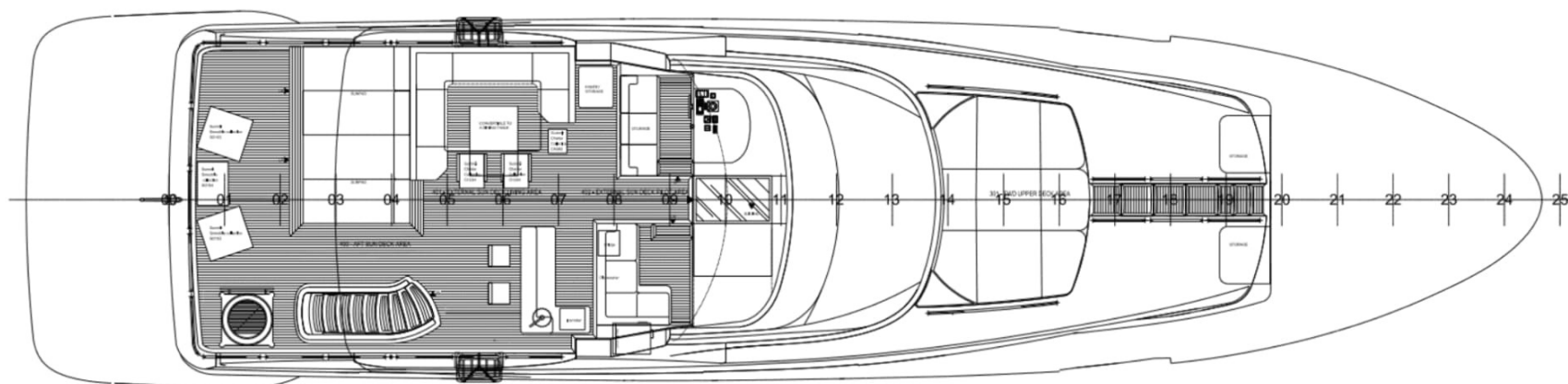

FLYBRIDGE

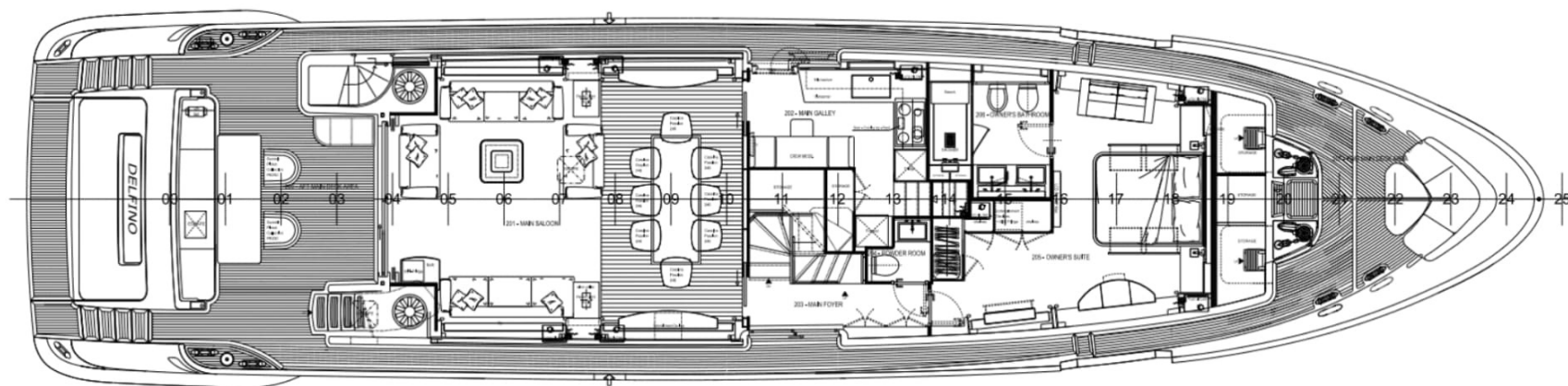

MAIN DECK

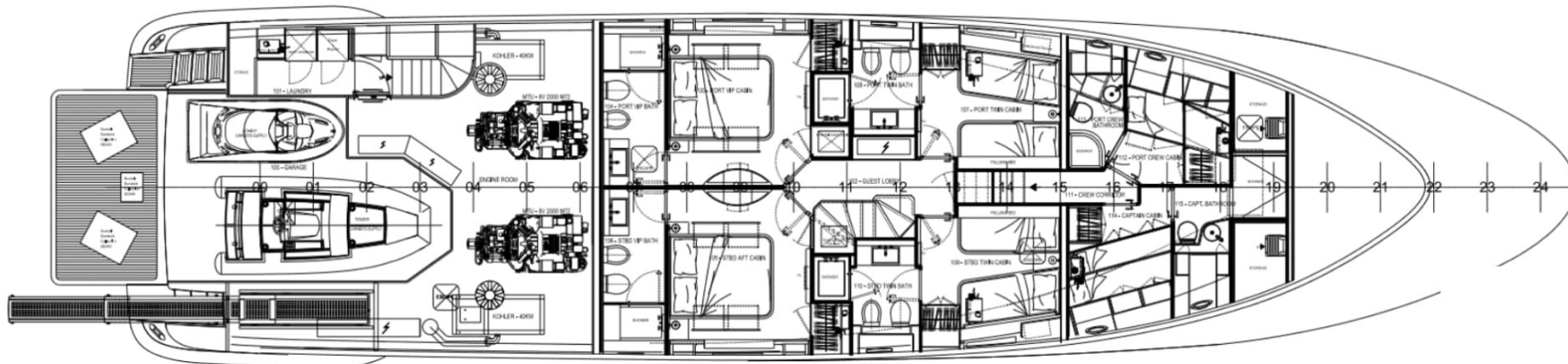

LOWER DECK



KIRILL KUATOV

+377 607 93 15 20

+39 333 576 44 44

[Send e-mail](#)

[WhatsApp](#)

[Telegram](#)