



Brokerage

NAU
YACHTS

MAVIS

MOTOR YACHT PERSHING 27.6M 2019

€5,900,000 (VAT paid)
FLAG - CZECH

MOTOR YACHT

MAVIS

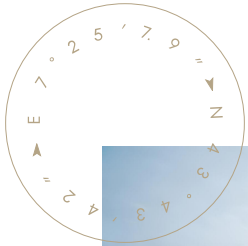

MAVIS is a **Pershing 9X** motor yacht delivered in 2019 by **Pershing Yachts**. Privately used since new, she is offered with VAT paid and presented in excellent technical condition, ready for immediate use. Both hull and superstructure are constructed from advanced composite materials with extensive use of carbon fibre, resulting in reduced weight and outstanding performance. Her exterior, designed by Pershing in collaboration with Fulvio De Simoni, features sleek aerodynamic lines, signature side wings, and a striking silver metallic finish.

Accommodation is provided for up to 8 guests across four staterooms, including a full-beam master suite, a VIP cabin, and two guest cabins. Each stateroom is equipped with its own en-suite bathroom. Crew quarters for three are arranged across two cabins, ensuring professional service while maintaining guest privacy. Powered by twin MTU 16V 2000 M96L diesel engines (approx. 1,033 hours each), **MAVIS** delivers exhilarating performance, with a cruising speed of around 36 knots and a top speed of up to 41 knots - ideal for fast and efficient cruising between destinations. Navigation and control systems are fully integrated, providing precise handling and complete command of onboard systems. The yacht is built in accordance with RINA classification standards.

Outdoor spaces are designed to complement her sporty character, offering well-configured areas for relaxation and helm operations, as well as smooth and efficient movement throughout the yacht.

Combining high speed, advanced technology, and lightweight composite construction, **MAVIS** represents one of the most dynamic and high-performance offerings in the 28-metre sport yacht segment.

[see more information about M/Y MAVIS at www.nauyachts.com](http://www.nauyachts.com)

SPECIFICATION

SHIPYARD, MODEL	Pershing 9X
BUILT	2019
LENGTH	27.6 m
WATERLINE LENGTH	21.04 m
HULL CONFIGURATION	PLANING
BEAM	6.23 m
RANGE	380
DRAFT	1.65 m
GROSS TONNAGE	115 GT
YACHT CLASS	RINA
CABINS	4+2
MASTER CABIN	LOWER DECK
GUESTS	8
BERTHS	8+3
CREW	3
HEADS	4+1

EXTERIOR DESIGN	FULVIO DE SIMONI
INTERIOR DESIGN	PERSHING YACHTS
HULL	GRP
SUPERSTRUCTURE	GRP
ENGINES	2 x MTU 16V 2860 h.p.
TYPE OF DRIVE	SHAFT LINE
ENGINE HOURS	1033 h
MAXIMUM SPEED	41 kn
CRUSING SPEED	36 kn
FUEL CONSUMPTION AT ECONOMICAL SPEED	~ 800 l/h
FUEL	9000 l
GREY WATER	300 l
BLACK WATER	300 l
FRESH WATER	1200 l
DISPLACEMENT	79.4

[see more information about M/Y MAVIS at www.nauyachts.com](http://www.nauyachts.com)



EXTERIOR PERSHING 9X 2019 MY MAVIS

M/Y MAVIS



EXTERIOR PERSHING 9X 2019 MY MAVIS

M/Y MAVIS



EXTERIOR PERSHING 9X 2019 M/Y MAVIS

M/Y MAVIS



EXTERIOR PERSHING 9X 2019 MY MAVIS

M/Y MAVIS



COCKPIT SEATING AREA

M/Y MAVIS



COCKPIT DINING AREA

M/Y MAVIS



COCKPIT DINING AREA

M/Y MAVIS



COCKPIT DINING AREA

M/Y MAVIS



BOW LOUNGE AREA

M/Y MAVIS



BOW LOUNGE AREA

M/Y MAVIS



BOW LOUNGE AREA

M/Y MAVIS



PORT SIDE

M/Y MAVIS



FLYBRIDGE LOUNGE AREA

M/Y MAVIS



SECOND HELM STATION

M/Y MAVIS



SECOND HELM STATION

M/Y MAVIS



SECOND HELM STATION

M/Y MAVIS



MAIN SALON LOUNGE AREA

M/Y MAVIS



MAIN SALON LOUNGE AREA

M/Y MAVIS



MAIN SALON DINING AREA

M/Y MAVIS



MAIN SALON DINING AREA

M/Y MAVIS



MAIN HELM STATION

M/Y MAVIS



MAIN HELM STATION

M/Y MAVIS



MASTER CABIN

M/Y MAVIS



MASTER CABIN

M/Y MAVIS



MASTER CABIN

M/Y MAVIS



MASTER BATHROOM

M/Y MAVIS



GUEST CABIN

M/Y MAVIS



GUEST CABIN

M/Y MAVIS



GUEST BATHROOM



VIP CABIN

M/Y MAVIS



VIP BATHROOM

M/Y MAVIS



VIP CABIN

M/Y MAVIS



VIP CABIN

M/Y MAVIS



VIP BATHROOM

M/Y MAVIS



ENGINE ROOM

M/Y MAVIS

General Arrangement

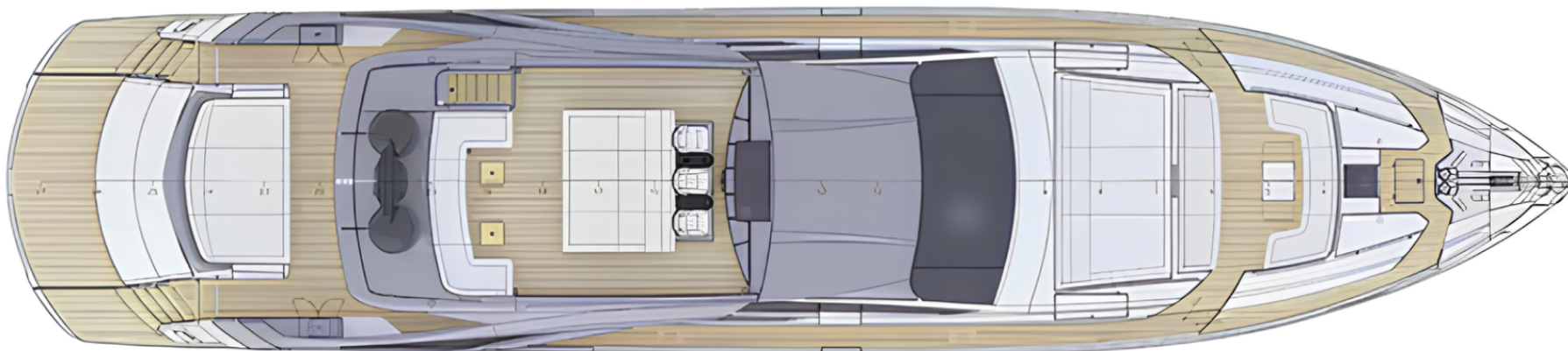

FLYBRIDGE

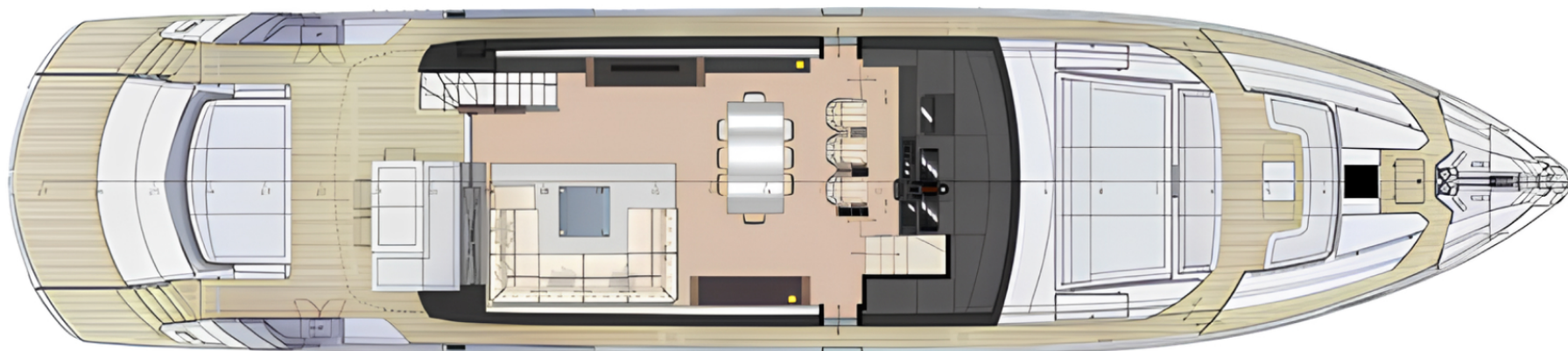

MAIN DECK



LOWER DECK



KIRILL KUATOV

+377 607 93 15 20

+39 333 576 44 44

[Send e-mail](#)

[WhatsApp](#)

[Telegram](#)