



Brokerage

NAU
YACHTS

SUN

MOTOR YACHT ARCADIA YACHTS 35.5M 2012

€5,700,000
FLAG - JERSEY

MOTOR YACHT

SUN



SUN is a 35.5-metre semi-displacement motor yacht delivered in 2012 by **Arcadia Yachts**. Designed with a strong focus on energy efficiency and reduced environmental impact, she stands out for her integration of solar panels into the superstructure, allowing onboard systems to be powered at anchor while minimizing noise and fuel consumption.

Accommodation is arranged for up to 12 guests across five staterooms. The full-beam master suite is located on the main deck and features a workspace, walk-in wardrobe, and an en-suite bathroom with a Jacuzzi. Additional guest accommodation includes two double cabins and two twin cabins. Separate crew quarters for seven ensure a high level of service.

The main saloon combines lounge and dining areas within a bright, open space defined by full-height panoramic glazing, fold-down balconies, and an integrated multimedia system. The flybridge offers a lounge area, bar, and al fresco dining for up to 12 guests, along with an additional panoramic deck saloon. Forward, the yacht features a garage, sunbathing area, and a Jacuzzi.

Power is supplied by twin Kohler generators, with a 380V electrical system and shore power capability. Technical equipment includes air conditioning systems, an Idromar watermaker, Rodriquez stabilizers, a bow thruster, an Alfa Laval fuel filtration system, and a Gianneschi wastewater treatment system.

Configured for extended autonomous cruising, **SUN** offers a high level of onboard comfort while maintaining reduced operational impact and low noise levels.

[see more information about M/Y SUN at www.nauyachts.com](http://www.nauyachts.com)

SPECIFICATION

SHIPYARD, MODEL	Arcadia Yachts A115
BUILT	2012
LENGTH	35.5 m
WATERLINE LENGTH	30.98 m
HULL CONFIGURATION	SEMI-DISPLACEMENT
BEAM	7.33 m
RANGE	1000
DRAFT	2.3 m
GROSS TONNAGE	266 GT
YACHT CLASS	RINA
CABINS	5+4
MASTER CABIN	MAIN DECK
GUESTS	12
BERTHS	12+7
CREW	7
HEADS	6+4

EXTERIOR DESIGN	FRANCESCO GUIDA
INTERIOR DESIGN	ARCADIA YACHTS
HULL	GRP
SUPERSTRUCTURE	GRP
ENGINES	2 x MAN V12 D2842 LE443 1224 h.p.
TYPE OF DRIVE	SHAFT LINE
ENGINE HOURS	4294 h
MAXIMUM SPEED	17 kn
CRUSING SPEED	10 kn
FUEL CONSUMPTION AT ECONOMICAL SPEED	~ 400 l/h
FUEL	23000 l
GREY WATER	1200 l
BLACK WATER	1000 l
FRESH WATER	4000 l
DISPLACEMENT	185

[see more information about M/Y SUN at www.nauyachts.com](http://www.nauyachts.com)



EXTERIOR ARCADIA A115 2012 MY SUN

M/Y SUN



EXTERIOR ARCADIA A115 2012 MY SUN

M/Y SUN



EXTERIOR ARCADIA A115 2012 MY SUN

M/Y SUN



EXTERIOR ARCADIA A115 2012 MY SUN

M/Y SUN



EXTERIOR ARCADIA A115 2012 MY SUN

M/Y SUN



PORT SIDE

M/Y SUN



FOLDING PORTSIDE BALCONY

M/Y SUN



FOLDING STARBOARD BALCONY

M/Y SUN



EXTERIOR ARCADIA A115 2012 MY SUN

M/Y SUN



FLYBRIDGE DINING AREA

M/Y SUN



FLYBRIDGE DINING AREA

M/Y SUN



BOW LOUNGE AREA

M/Y SUN



BOW LOUNGE AREA

M/Y SUN



BOW LOUNGE AREA

M/Y SUN



COCKPIT SEATING AREA

M/Y SUN



COCKPIT SEATING AREA

M/Y SUN



UPPER DECK SALOON

M/Y SUN



UPPER DECK SALOON

M/Y SUN



MAIN SALON LOUNGE AREA

M/Y SUN



MAIN SALON LOUNGE AREA

M/Y SUN



MAIN SALON LOUNGE AREA

M/Y SUN



MAIN SALON LOUNGE AREA

M/Y SUN



MAIN SALON DINING AREA

M/Y SUN



MAIN SALON LOBBY

M/Y SUN



MASTER CABIN

M/Y SUN



MASTER CABIN

M/Y SUN



MASTER BATHROOM

M/Y SUN



MASTER BATHROOM

M/Y SUN



VIP CABIN

M/Y SUN



VIP BATHROOM

M/Y SUN



VIP CABIN

M/Y SUN



VIP CABIN

M/Y SUN



VIP BATHROOM

M/Y SUN

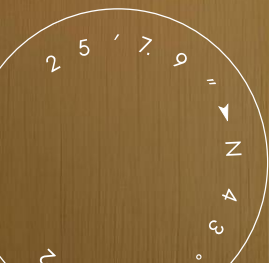

GUEST CABIN

M/Y SUN



GUEST CABIN

M/Y SUN



MAIN HELM STATION

M/Y SUN

General Arrangement

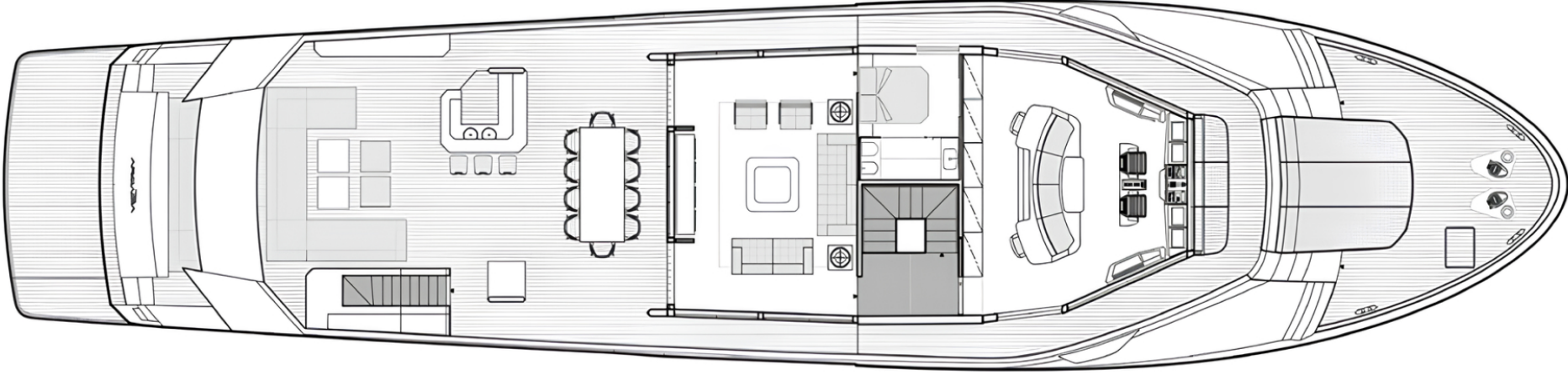

FLYBRIDGE

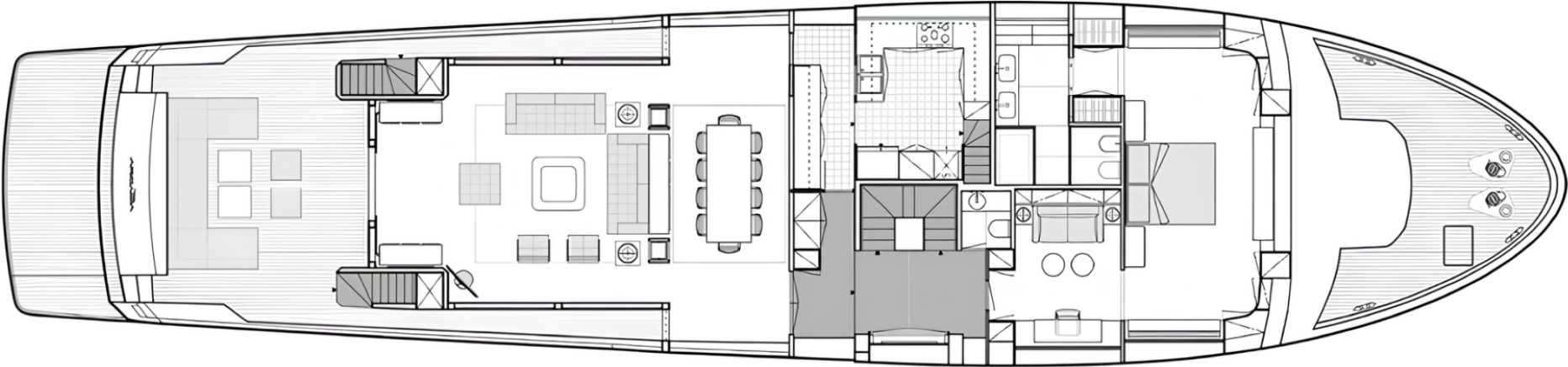

MAIN DECK

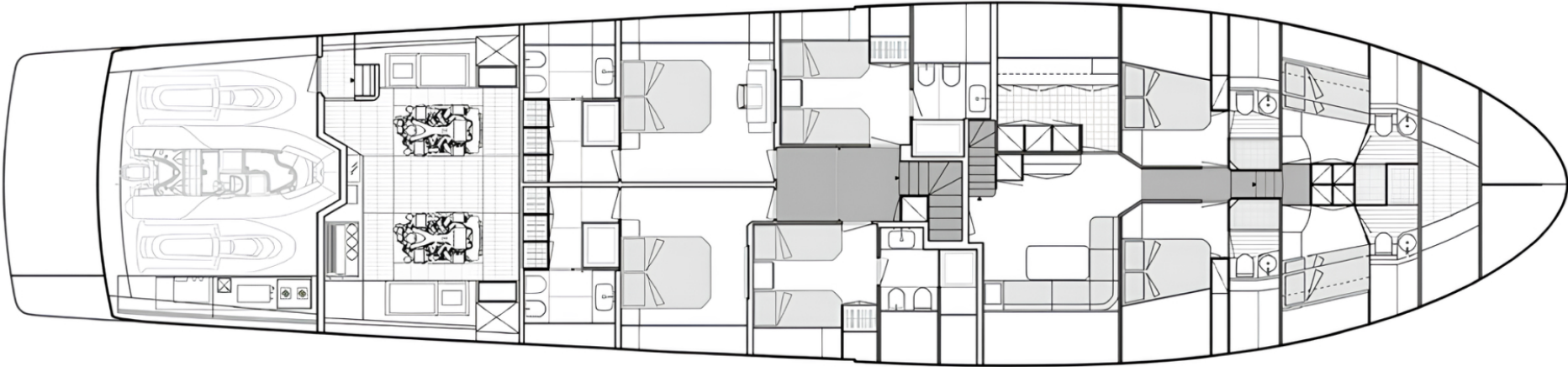

LOWER DECK



KIRILL KUATOV

+377 607 93 15 20

+39 333 576 44 44

[Send e-mail](#)

[WhatsApp](#)

[Telegram](#)

[More information about M/Y SUN at www.nauyachts.com](http://www.nauyachts.com)

[Watch video](#)