



Brokerage

NAU
YACHTS

SUMMER FUN

MOTOR YACHT ADMIRAL 30.86M 2001

€2,450,000 (VAT paid)
FLAG - GREECE

MOTOR YACHT

SUMMER FUN



SUMMER FUN is a 30.86-metre motor yacht delivered in 2001 by **Admiral Yachts**, extensively refitted in 2023 and again in 2026. The upgrades included a full hull repaint, replacement of superstructure windows, and a comprehensive interior modernization, bringing the yacht to an excellent technical and aesthetic standard. Constructed with an aluminum hull and superstructure and finished with teak decks, **SUMMER FUN** features a semi-displacement hull that offers an effective balance between performance and onboard comfort.

Accommodation is arranged for up to 12 guests across six staterooms. The layout includes a master suite on the main deck, a full-beam VIP cabin that can be converted into a playroom, and four twin cabins - two of which can be configured as doubles. All staterooms are en-suite.

Power is supplied by twin Kohler generators (33 kW each), complemented by an additional 23 kW night generator. The yacht is equipped with full air conditioning, as well as modern galley and laundry appliances from Miele, Alpes-Inox, and Liebherr. Additional features include ice makers and wine coolers.

Interior spaces are designed with a focus on practicality and long-stay comfort. The refreshed décor features a neutral palette and benefits from abundant natural light. Well-balanced and recently upgraded, **SUMMER FUN** represents a strong offering in the 30-metre segment, combining a robust aluminum platform, modernized interiors, and versatile cruising capabilities.

[see more information about M/Y SUMMER FUN at www.nauyachts.com](http://www.nauyachts.com)

SPECIFICATION

SHIPYARD, MODEL	Admiral 30M
BUILT	2001
LENGTH	30.86 m
WATERLINE LENGTH	24.79 m
HULL CONFIGURATION	SEMI-DISPLACEMENT
BEAM	7.1 m
RANGE	N/A
DRAFT	2.3 m
GROSS TONNAGE	197 GT
YACHT CLASS	CE
CABINS	6+4
MASTER CABIN	MAIN DECK
GUESTS	12
BERTHS	12+7
CREW	7
HEADS	7+2

EXTERIOR DESIGN	ADMIRAL YACHTS
INTERIOR DESIGN	LUCA DINI DESIGN
HULL	ALUMINUM
SUPERSTRUCTURE	ALUMINIUM
ENGINES	2 x MTU 12V 2000 M90 1350 h.p.
TYPE OF DRIVE	SHAFT LINE
ENGINE HOURS	N/A
MAXIMUM SPEED	29 kn
CRUSING SPEED	23 kn
FUEL CONSUMPTION AT ECONOMICAL SPEED	~ 600 l/h
FUEL	22200 l
GREY WATER	N/A
BLACK WATER	N/A
FRESH WATER	4100 l
DISPLACEMENT	N/A

[see more information about M/Y SUMMER FUN at www.nauyachts.com](http://www.nauyachts.com)



EXTERIOR ADMIRAL 30M 2001 MY SUMMER
FUN

M/Y SUMMER FUN



EXTERIOR ADMIRAL 30M 2001 MY SUMMER
FUN

M/Y SUMMER FUN



EXTERIOR ADMIRAL 30M 2001 MY SUMMER
FUN

M/Y SUMMER FUN



EXTERIOR ADMIRAL 30M 2001 MY SUMMER
FUN

M/Y SUMMER FUN

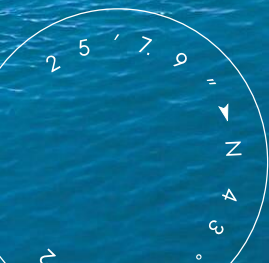

EXTERIOR ADMIRAL 30M 2001 MY SUMMER
FUN

M/Y SUMMER FUN



EXTERIOR ADMIRAL 30M 2001 MY SUMMER
FUN

M/Y SUMMER FUN



EXTERIOR ADMIRAL 30M 2001 MY SUMMER FUN

M/Y SUMMER FUN

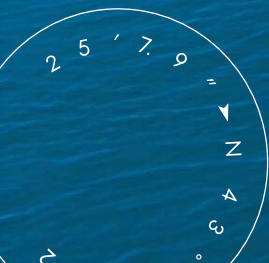

EXTERIOR ADMIRAL 30M 2001 MY SUMMER
FUN

M/Y SUMMER FUN



EXTERIOR ADMIRAL 30M 2001 MY SUMMER
FUN

M/Y SUMMER FUN



AFT MAIN DECK DINING AREA

M/Y SUMMER FUN



BOW LOUNGE AREA

M/Y SUMMER FUN



BOW LOUNGE AREA

M/Y SUMMER FUN



FLYBRIDGE LOUNGE AREA

M/Y SUMMER FUN



FLYBRIDGE DINING AREA

M/Y SUMMER FUN



FLYBRIDGE LOUNGE AREA

M/Y SUMMER FUN



MAIN SALON LOUNGE AREA

M/Y SUMMER FUN



MAIN SALON LOUNGE AREA

M/Y SUMMER FUN



MAIN SALON LOUNGE AREA

M/Y SUMMER FUN



MAIN SALON LOUNGE AREA

M/Y SUMMER FUN



MAIN SALON LOUNGE AREA

M/Y SUMMER FUN



MAIN SALON LOUNGE AREA

M/Y SUMMER FUN



MAIN SALON LOUNGE AREA

M/Y SUMMER FUN



MAIN SALON DINING AREA

M/Y SUMMER FUN



MAIN SALON DINING AREA

M/Y SUMMER FUN



MAIN SALON DINING AREA

M/Y SUMMER FUN



MAIN SALON DINING AREA

M/Y SUMMER FUN



MASTER CABIN

M/Y SUMMER FUN



MASTER CABIN

M/Y SUMMER FUN



MASTER CABIN

M/Y SUMMER FUN



MASTER BATHROOM

M/Y SUMMER FUN



VIP CABIN

M/Y SUMMER FUN



VIP CABIN

M/Y SUMMER FUN



GUEST CABIN

M/Y SUMMER FUN



GUEST CABIN

M/Y SUMMER FUN



GUEST CABIN

M/Y SUMMER FUN



GUEST CABIN

M/Y SUMMER FUN

General Arrangement

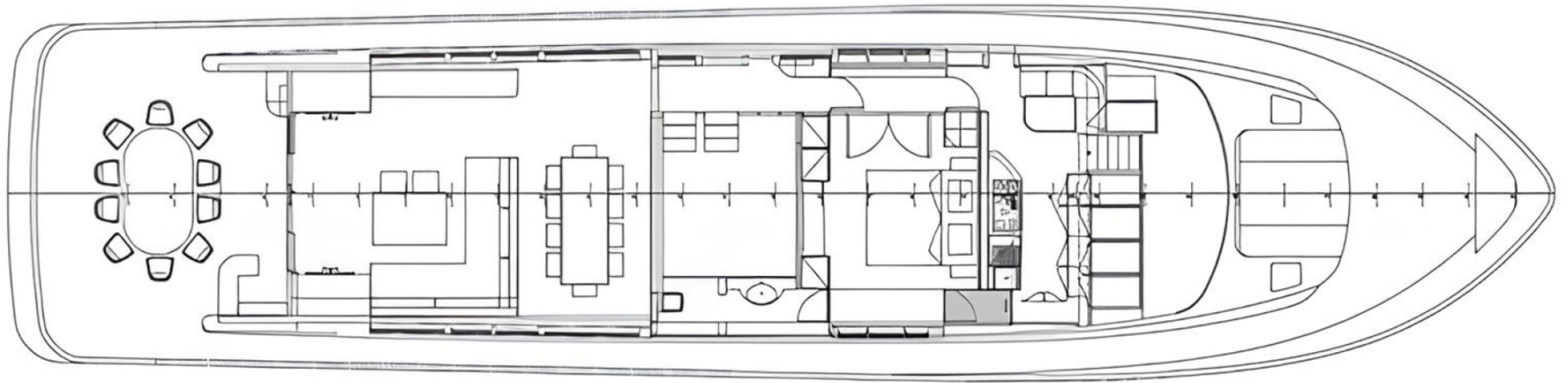

MAIN DECK

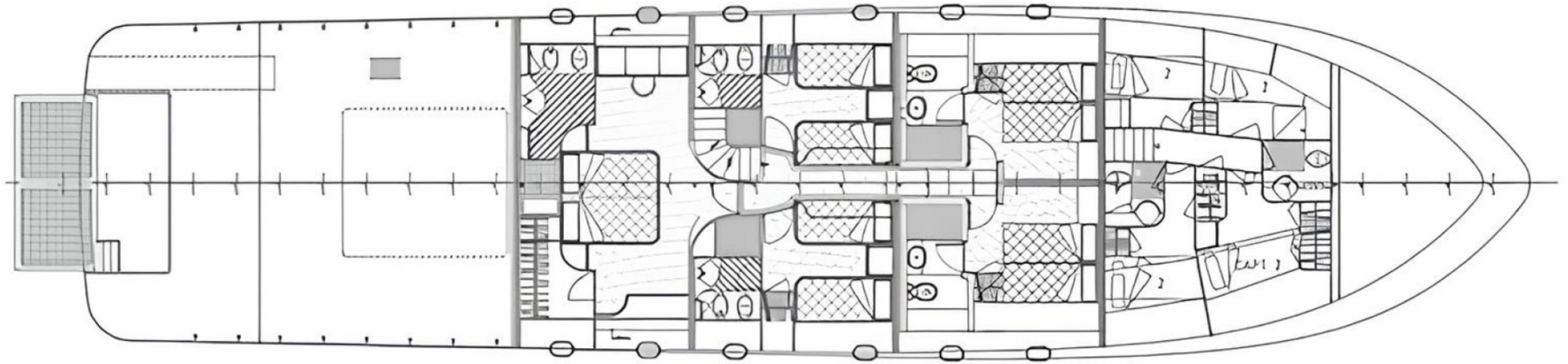

LOWER DECK



KIRILL KUATOV

+377 607 93 15 20

+39 333 576 44 44

[Send e-mail](#)

[WhatsApp](#)

[Telegram](#)