



Brokerage

NAU
YACHTS

DW

MOTOR YACHT ANVERA 17.5M 2025

€2,000,000

FLAG - MARSHALL ISLANDS

MOTOR YACHT

DW

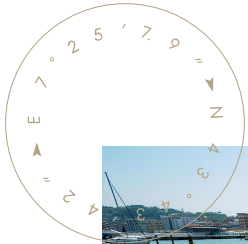

DW is an **Anvera 58**, a 17.5-metre high-performance motor yacht built by **Anvera**. Constructed entirely from carbon fiber, she is engineered for maximum efficiency, reduced weight, and advanced hydrodynamics - delivering exceptional performance, fuel efficiency, and responsive handling.

Her concept is centered around open space and direct interaction with the sea. A defining feature is the fold-down side terraces, which significantly expand deck space and create a beach club-style environment. The layout includes generous sunbathing areas forward and aft, along with a cockpit offering flexible seating and dining configurations.

Powered by twin MAN I6-850 engines, **DW** achieves a cruising speed of approximately 40 knots and a top speed of up to 53 knots. The lightweight carbon construction enables rapid acceleration, precise maneuverability, and stable performance even at high speeds. With a range of around 333 nautical miles, she is equally suited for fast day trips and extended coastal cruising.

Interior accommodation is arranged for up to 4 guests across two cabins. The main cabin features a double bed, overhead glazing, and a lounge area, while the second cabin offers twin berths. A bathroom with a separate shower is also provided. The interior is finished in a light, contemporary style with integrated lighting and efficient use of space.

Onboard equipment includes a Seakeeper 6, air conditioning, a 9 kW Kohler generator, and a comprehensive Garmin navigation suite with radar, AIS, and autopilot. Additional features include Starlink connectivity, a Fusion audio system with JL speakers, a hydraulic swim ladder, gangway, and adaptable shading solutions.

Lightweight, fast, and architecturally distinctive, **DW** delivers a cutting-edge yachting experience - ideal for owners seeking performance, innovation, and a strong connection to the sea.

[see more information about M/Y DW at www.nauyachts.com](http://www.nauyachts.com)

SPECIFICATION

SHIPYARD, MODEL	Anvera 58
BUILT	2025
LENGTH	17.5 m
WATERLINE LENGTH	N/A
HULL CONFIGURATION	PLANING
BEAM	5.12 m
RANGE	333
DRAFT	1.2 m
GROSS TONNAGE	25 GT
YACHT CLASS	CE
CABINS	2
MASTER CABIN	LOWER DECK
GUESTS	16
BERTHS	4
CREW	N/A
HEADS	1

EXTERIOR DESIGN	ANVERA
INTERIOR DESIGN	ANVERA
HULL	CARBON FIBRE
SUPERSTRUCTURE	CARBON FIBRE
ENGINES	2 x MAN I6-850 h.p.
TYPE OF DRIVE	JET
ENGINE HOURS	N/A
MAXIMUM SPEED	53 kn
CRUISING SPEED	40 kn
FUEL CONSUMPTION AT ECONOMICAL SPEED	~ 6 l/h
FUEL	1600 l
GREY WATER	40 l
BLACK WATER	40 l
FRESH WATER	400 l
DISPLACEMENT	17

[see more information about M/Y DW at www.nauyachts.com](http://www.nauyachts.com)



EXTERIOR ANVERA 58 2025 MY DW

M/Y DW



EXTERIOR ANVERA 58 2025 MY DW

M/Y DW



EXTERIOR ANVERA 58 2025 MY DW

M/Y DW



EXTERIOR ANVERA 58 2025 MY DW

M/Y DW



COCKPIT SEATING AREA

M/Y DW



COCKPIT SEATING AREA

M/Y DW



COCKPIT SEATING AREA

M/Y DW



COCKPIT DINING AREA

M/Y DW



COCKPIT DINING AREA

M/Y DW



MAIN HELM STATION

M/Y DW



MAIN HELM STATION

M/Y DW



EXTERIOR ANVERA 58 2025 MY DW

M/Y DW



VIP CABIN

M/Y DW

General Arrangement

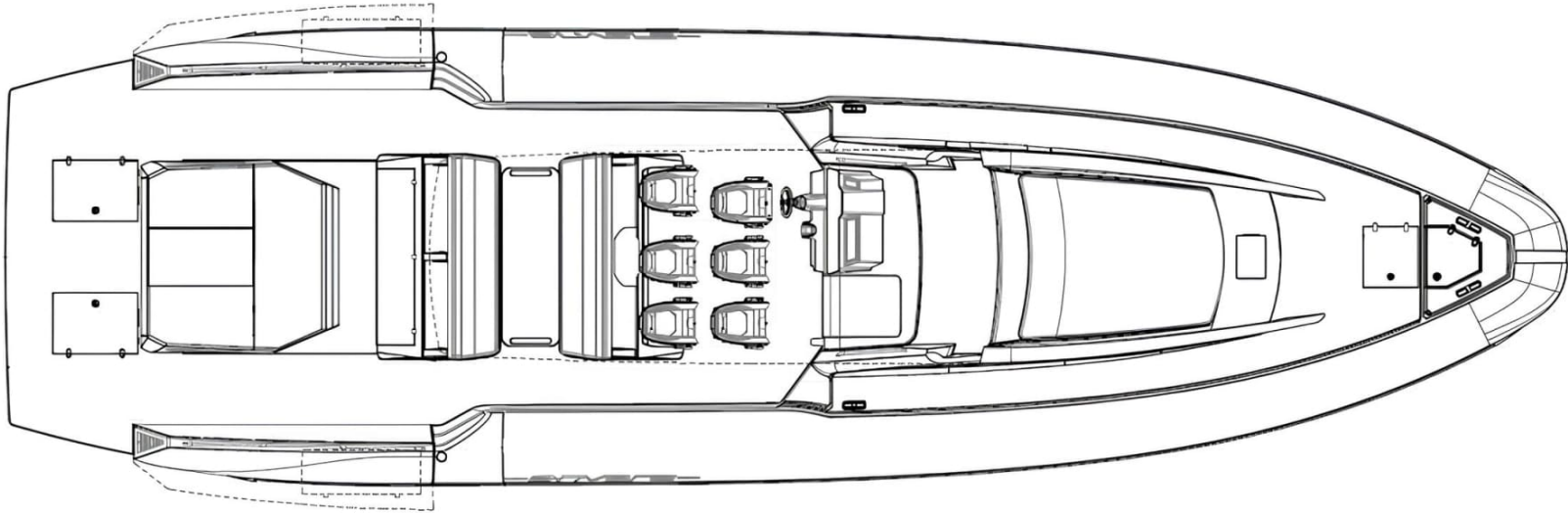

MAIN DECK

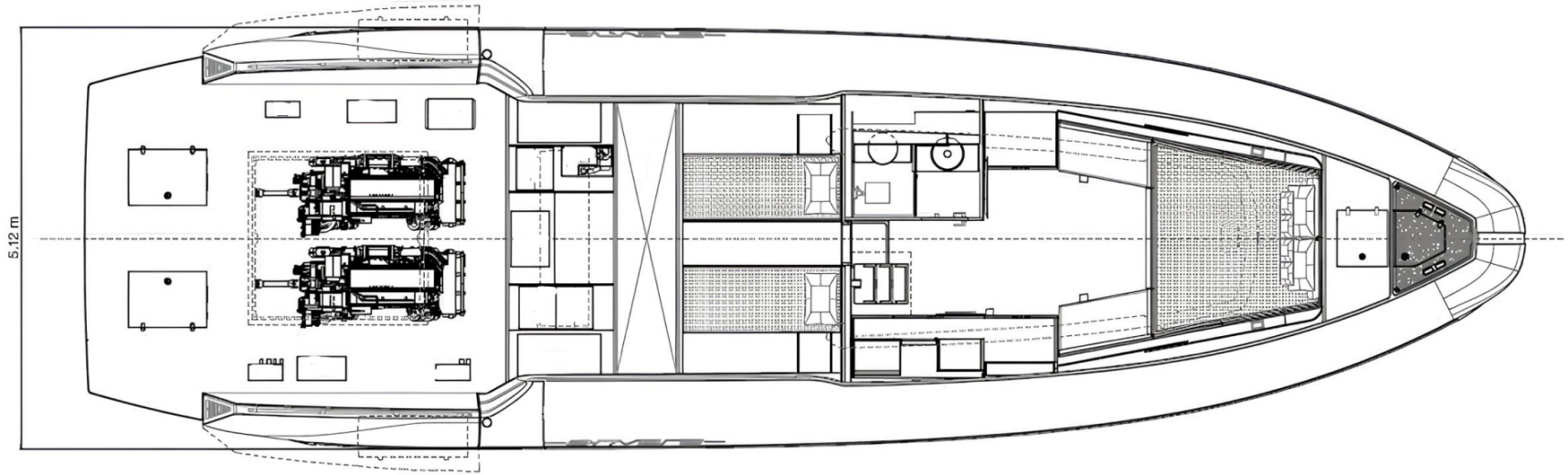

LOWER DECK



KIRILL KUATOV

+377 607 93 15 20

+39 333 576 44 44

[Send e-mail](#)

[WhatsApp](#)

[Telegram](#)