

Brokerage

NAU
YACHTS

LADY MAUREEN

MOTOR YACHT FALCON 26.1M 2006

€975,000 (VAT paid)
FLAG - MALTA

MOTOR YACHT

LADY MAUREEN



LADY MAUREEN is a 26.1-metre **Falcon 86** motor yacht built in 2006 by **Cantiere Navale Falcon**. Commercially registered under the Malta flag and VAT paid, she represents an attractive proposition in the 26-metre segment, combining Italian design, spacious decks, and a flexible layout for up to 10 guests.

Her exterior was designed by Stefano Righini, visible in the yacht's balanced silhouette and classic proportions. A white fiberglass hull and superstructure, teak main deck, and practical flybridge configuration create the profile of a comfortable Mediterranean yacht suited to both private use and commercial operation.

Accommodation is arranged for up to 10 guests across 4 cabins. On the lower deck, the owner's cabin is positioned amidships and offers good storage areas and a large bathroom with a Jacuzzi and separate shower. Forward, the VIP cabin has its own en-suite bathroom. Two twin guest cabins are supplemented by fold-down berths, increasing flexibility for family use or charter groups.

The main deck interior is finished in a warm classic style, with wood panelling, soft furnishings, and large windows that bring natural light into the saloon. The lounge area is designed for relaxed indoor living, while the forward dining area in the saloon seats six guests. A fully equipped galley with appliances from Bosch, Rosieres, AEG, Liebherr, and Miele supports comfortable onboard living and full service during longer cruises.

Outdoor spaces are one of **LADY MAUREEN's** strengths. The flybridge offers a generous open-air social area with shaded dining, a U-shaped sofa, central table, helm station, and sunbathing spaces. The aft deck and exterior side decks further expand the yacht's lifestyle offering, creating practical areas for dining, relaxation, and social time at sea.

Overall, **LADY MAUREEN** is a well-balanced motor yacht with proven **Falcon** construction, design by Stefano Righini, a spacious guest layout, and commercial registration. She offers comfort, flexibility, and straightforward operational logic for an owner seeking a yacht in the 26-metre class with complete guest areas, a large flybridge.

[see more information about M/Y LADY MAUREEN at www.nauyachts.com](http://www.nauyachts.com)

SPECIFICATION

SHIPYARD, MODEL	Falcon 86
BUILT	2006
LENGTH	26.1 m
WATERLINE LENGTH	21.83 m
HULL CONFIGURATION	PLANING
BEAM	6.4 m
RANGE	450
DRAFT	1.8 m
GROSS TONNAGE	80 GT
YACHT CLASS	BUREAU VERITAS
CABINS	4+2
MASTER CABIN	LOWER DECK
GUESTS	10
BERTHS	10+4
CREW	4
HEADS	4+2

EXTERIOR DESIGN	STEFANO RIGHINI
INTERIOR DESIGN	FALCON YACHTS
HULL	GRP
SUPERSTRUCTURE	GRP
ENGINES	2 x MTU M91 16V 2000 M91 1800 h.p.
TYPE OF DRIVE	SHAFT LINE
ENGINE HOURS	N/A
MAXIMUM SPEED	24 kn
CRUISING SPEED	20 kn
FUEL CONSUMPTION AT ECONOMICAL SPEED	~ 150 l/h
FUEL	8500 l
GREY WATER	N/A
BLACK WATER	N/A
FRESH WATER	1500 l
DISPLACEMENT	70

[see more information about M/Y LADY MAUREEN at www.nauyachts.com](http://www.nauyachts.com)



EXTERIOR FALCON 86 2006 MY LADY
MAUREEN

M/Y LADY MAUREEN



EXTERIOR FALCON 86 2006 MY LADY
MAUREEN

M/Y LADY MAUREEN



EXTERIOR FALCON 86 2006 MY LADY
MAUREEN

M/Y LADY MAUREEN



EXTERIOR FALCON 86 2006 MY LADY
MAUREEN

M/Y LADY MAUREEN



EXTERIOR FALCON 86 2006 MY LADY
MAUREEN

M/Y LADY MAUREEN



EXTERIOR FALCON 86 2006 MY LADY
MAUREEN

M/Y LADY MAUREEN



FLYBRIDGE LOUNGE AREA

M/Y LADY MAUREEN



FLYBRIDGE LOUNGE AREA

M/Y LADY MAUREEN



FLYBRIDGE LOUNGE AREA

M/Y LADY MAUREEN



FLYBRIDGE LOUNGE AREA

M/Y LADY MAUREEN



FLYBRIDGE LOUNGE AREA

M/Y LADY MAUREEN



FLYBRIDGE DINING AREA

M/Y LADY MAUREEN



FLYBRIDGE DINING AREA

M/Y LADY MAUREEN



FLYBRIDGE LOUNGE AREA

M/Y LADY MAUREEN



FLYBRIDGE GRILL

M/Y LADY MAUREEN



SECOND HELM STATION

M/Y LADY MAUREEN



AFT AREA

M/Y LADY MAUREEN



COCKPIT DINING AREA

M/Y LADY MAUREEN



COCKPIT DINING AREA

M/Y LADY MAUREEN



MAIN SALON LOUNGE AREA

M/Y LADY MAUREEN



MAIN SALON DINING AREA

M/Y LADY MAUREEN



MAIN SALON LOUNGE AREA

M/Y LADY MAUREEN



MAIN SALON DINING AREA

M/Y LADY MAUREEN

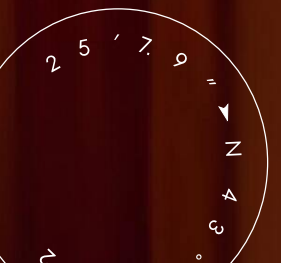

MASTER CABIN

M/Y LADY MAUREEN



MASTER CABIN

M/Y LADY MAUREEN



MASTER CABIN

M/Y LADY MAUREEN



MASTER CABIN

M/Y LADY MAUREEN



MASTER BATHROOM

M/Y LADY MAUREEN



MASTER BATHROOM

M/Y LADY MAUREEN



MASTER BATHROOM

M/Y LADY MAUREEN



GUEST CABIN

M/Y LADY MAUREEN



GUEST CABIN

M/Y LADY MAUREEN



GUEST CABIN

M/Y LADY MAUREEN

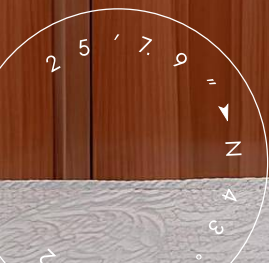

GUEST CABIN

M/Y LADY MAUREEN



GUEST BATHROOM

M/Y LADY MAUREEN



VIP CABIN

M/Y LADY MAUREEN



VIP CABIN

M/Y LADY MAUREEN



MAIN HELM STATION

M/Y LADY MAUREEN



MAIN HELM STATION

M/Y LADY MAUREEN



GALLEY

M/Y LADY MAUREEN



ENGINE ROOM

M/Y LADY MAUREEN

General Arrangement

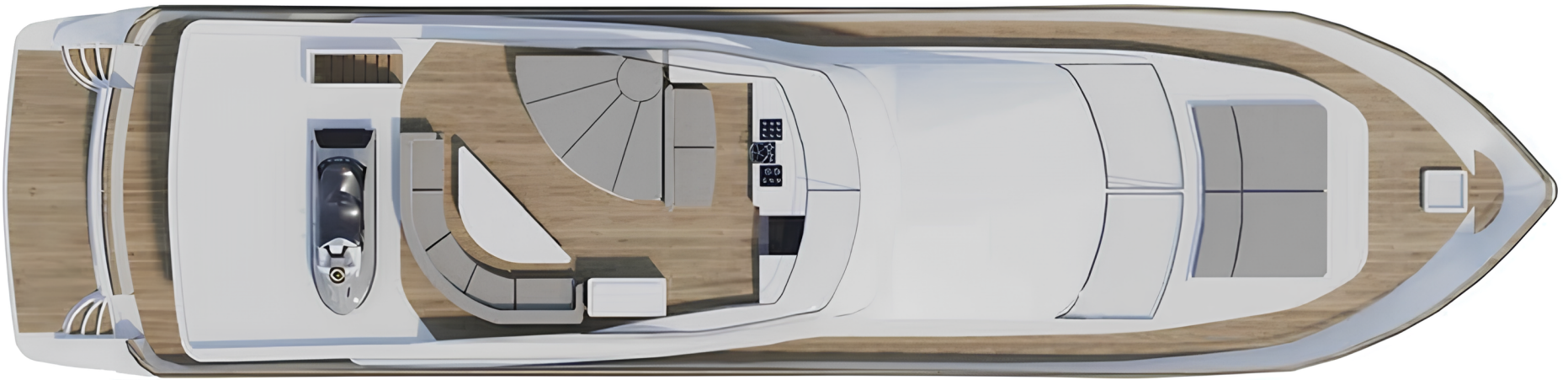

FLYBRIDGE

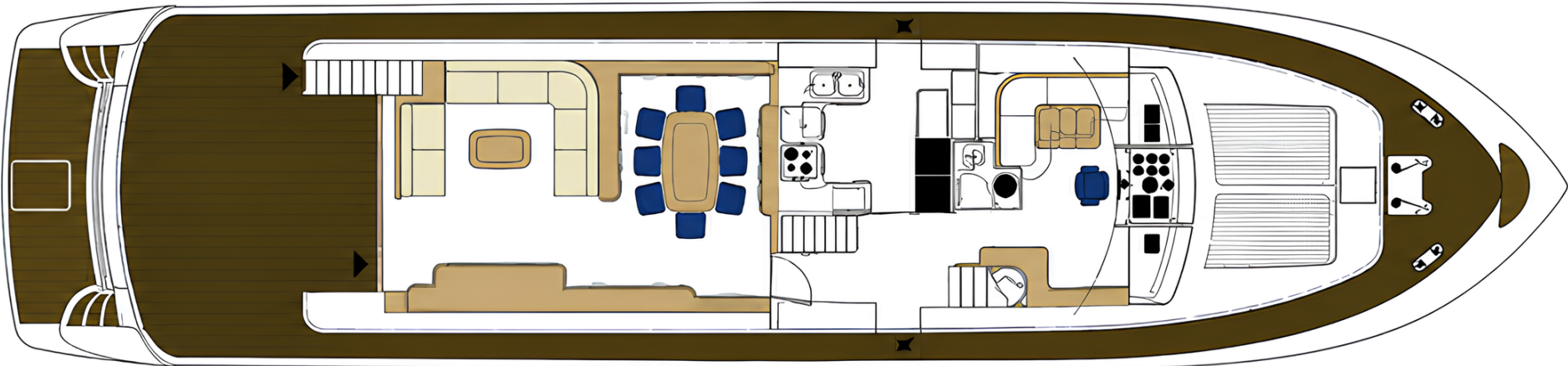

MAIN DECK

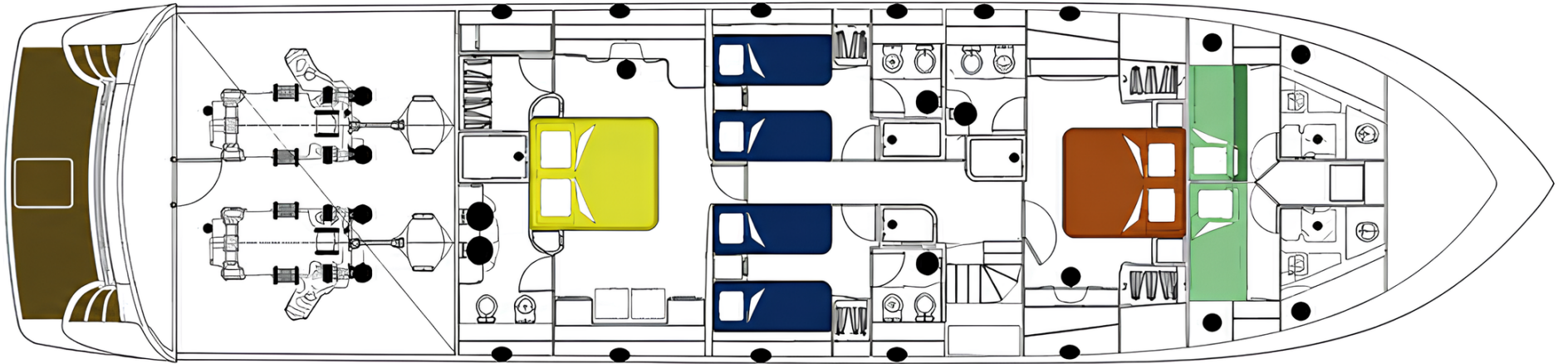

LOWER DECK



KIRILL KUATOV

+377 607 93 15 20

+39 333 576 44 44

[Send e-mail](#)

[WhatsApp](#)

[Telegram](#)