



Brokerage

NAU
YACHTS

HAYAT

MOTOR YACHT SANLORENZO 31.09M 2021

€8,300,000

FLAG - UK

MOTOR YACHT

HAYAT



HAYAT is a 31.08-metre **Sanlorenzo SL102 Asymmetric** motor yacht built in 2021 by **Sanlorenzo Yachts** to a design by Zuccon International Project. The model has become one of the most recognizable yachts in the SL range thanks to its asymmetric architecture, which increases interior volume and creates a noticeably more open feeling compared with traditional yachts of this class.

Built in fiberglass, **HAYAT** underwent a refit in 2024 and is presented in excellent condition, fully ready for operation.

The yacht's defining feature is the asymmetric main-deck layout. One side deck is retained for exterior circulation, while the opposite side allows the interior living area to be expanded, making the saloon wider, brighter, and more comfortable for onboard living.

The interior follows a contemporary Italian aesthetic, with light tones, natural materials, and large panoramic windows creating a calm and elegant atmosphere. The main saloon is filled with natural light and maintains a constant visual connection with the sea.

Accommodation is arranged for up to 10 guests across 5 cabins. The owner's suite is positioned on the main deck and benefits from large windows and generous storage areas. Guest cabins are located on the lower deck and are well suited to comfortable longer cruises.

Exterior decks are organised around a Mediterranean lifestyle concept, with multiple areas for sunbathing, dining, and outdoor relaxation spread across the aft deck, foredeck, and flybridge.

HAYAT is powered by twin MTU 16V 2000 M96 engines, each producing 2,434 hp. Cruising speed is around 24 knots, with a maximum speed of up to 28 knots. The yacht also carries a Williams Dieseljet 445 tender.

Overall, **HAYAT** is one of the most interesting contemporary yachts in the 30-metre segment. She combines an innovative layout, modern Italian styling, a comfortable interior, and strong performance, while remaining equally suitable for private cruising and charter use.

[see more information about M/Y HAYAT at www.nauyachts.com](http://www.nauyachts.com)

SPECIFICATION

SHIPYARD, MODEL	Sanlorenzo SL102 Asymmetric
BUILT	2021
LENGTH	31.09 m
WATERLINE LENGTH	27.13 m
HULL CONFIGURATION	PLANING
BEAM	7.1 m
RANGE	1350
DRAFT	1.92 m
GROSS TONNAGE	180 GT
YACHT CLASS	RINA
CABINS	5+3
MASTER CABIN	MAIN DECK
GUESTS	10
BERTHS	10+6
CREW	6
HEADS	6+3

EXTERIOR DESIGN	ZUCCON INTERNATIONAL PROJECT
INTERIOR DESIGN	ZUCCON INTERNATIONAL PROJECT
HULL	GRP
SUPERSTRUCTURE	GRP
ENGINES	2 x MTU 16V 2434 h.p.
TYPE OF DRIVE	SHAFT LINE
ENGINE HOURS	1581 h
MAXIMUM SPEED	28 kn
CRUSING SPEED	24 kn
FUEL CONSUMPTION AT ECONOMICAL SPEED	~ 700 l/h
FUEL	12100 l
GREY WATER	850 l
BLACK WATER	950 l
FRESH WATER	1900 l
DISPLACEMENT	105

[see more information about M/Y HAYAT at www.nauyachts.com](http://www.nauyachts.com)



EXTERIOR SANLORENZO SL102A 2021 MY
HAYAT

M/Y HAYAT



EXTERIOR SANLORENZO SL102A 2021 MY
HAYAT

M/Y HAYAT



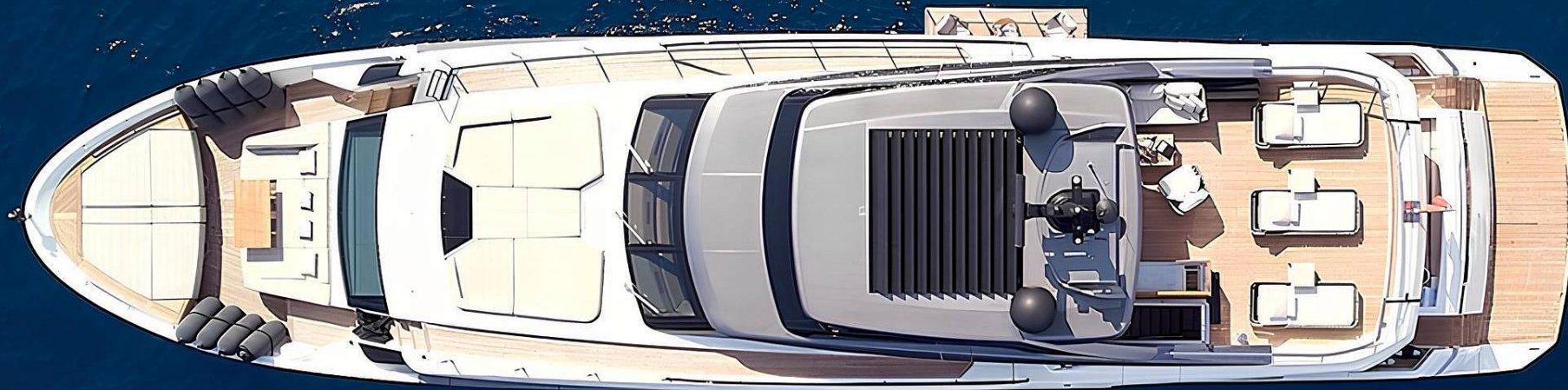

EXTERIOR SANLORENZO SL102A 2021 MY
HAYAT

M/Y HAYAT



FLYBRIDGE LOUNGE AREA

M/Y HAYAT



FLYBRIDGE DINING AREA

M/Y HAYAT



FLYBRIDGE LOUNGE AREA

M/Y HAYAT



SECOND HELM STATION

M/Y HAYAT



BOW LOUNGE AREA

M/Y HAYAT



COCKPIT DINING AREA

M/Y HAYAT



FOLDING STARBOARD BALCONY

M/Y HAYAT



SWIMMING PLATFORM AND WATER TOYS

M/Y HAYAT



MAIN SALON LOUNGE AREA

M/Y HAYAT



MAIN SALON DINING AREA

M/Y HAYAT



MAIN HELM STATION

M/Y HAYAT



MASTER CABIN

M/Y HAYAT



MASTER BATHROOM

M/Y HAYAT

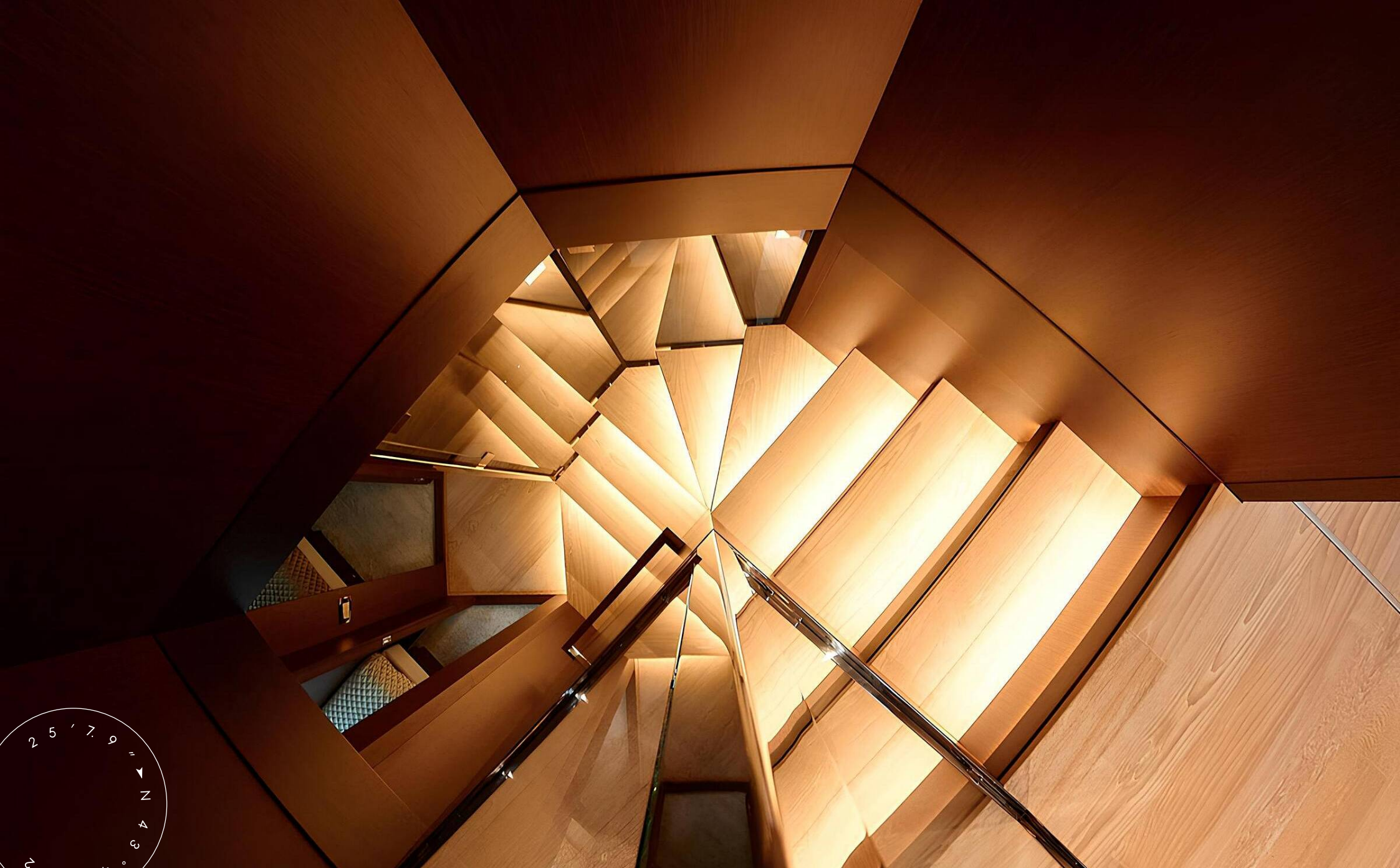

STAIRS FROM MD TO LD

M/Y HAYAT



VIP CABIN

M/Y HAYAT

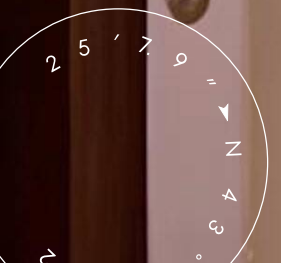

VIP BATHROOM

M/Y HAYAT

General Arrangement



PROFILE

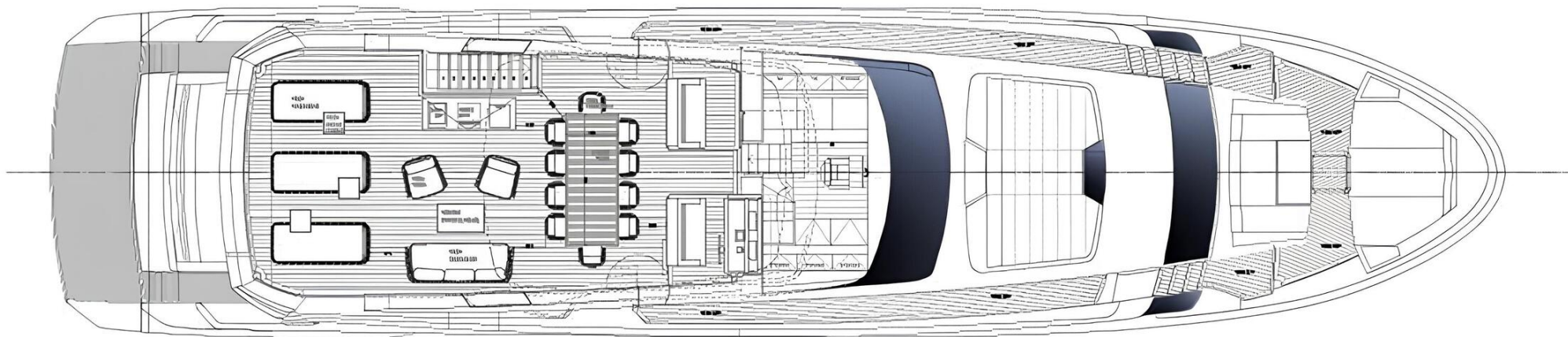

FLYBRIDGE

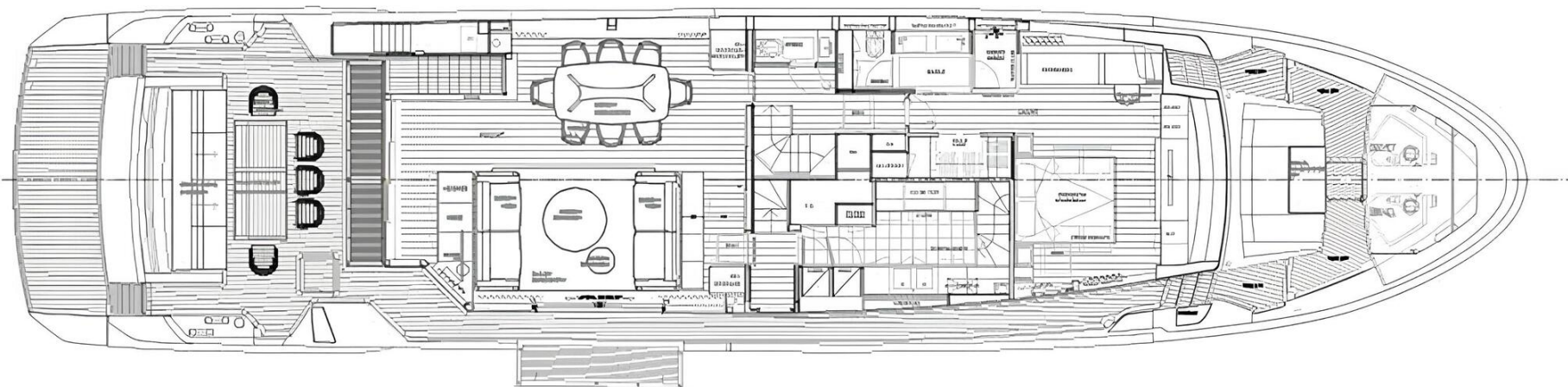

MAIN DECK

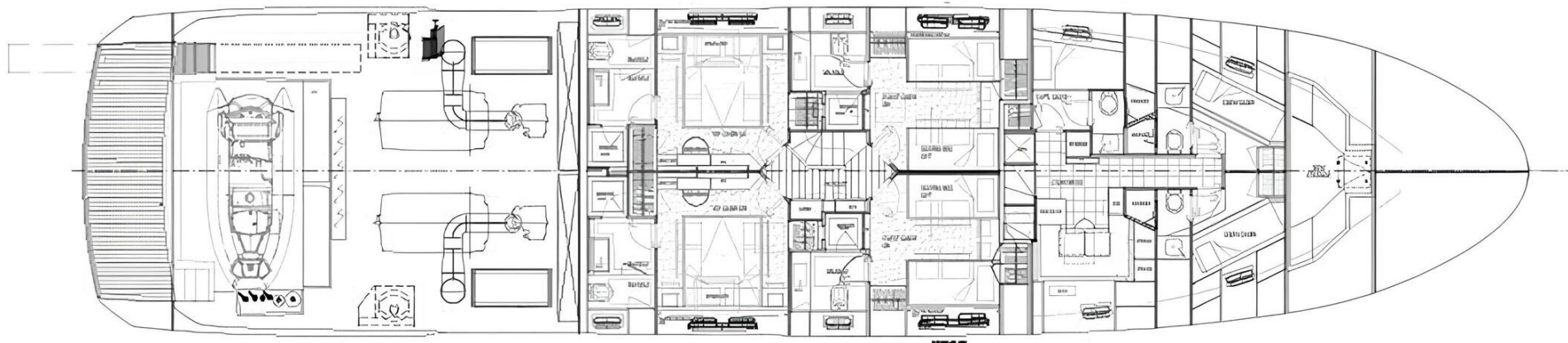

LOWER DECK



KIRILL KUATOV

+377 607 93 15 20

+39 333 576 44 44

[Send e-mail](#)

[WhatsApp](#)

[Telegram](#)