

Brokerage

NAU
YACHTS

CRAZY DIAMOND

MOTOR YACHT MONTE CARLO YACHTS 21.3M 2016

€1,490,000 (VAT paid)
FLAG - FRANCE

MOTOR YACHT

CRAZY DIAMOND

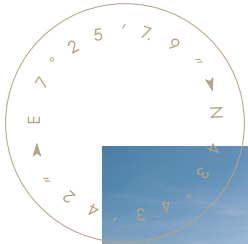

CRAZY DIAMOND is a **Monte Carlo Yachts MCY 70**, built in late 2016 and launched in 2017. Combining contemporary Italian styling, generous outdoor living areas and a highly practical layout, she remains one of the most sought-after models in the 70-foot flybridge segment.

Presented in excellent condition, **CRAZY DIAMOND** has accumulated approximately 500 engine hours, has been privately owned throughout her life and has benefited from consistent maintenance. With VAT paid status and a comprehensive specification, she is ready for immediate use following purchase.

The yacht is equipped with an impressive package designed to enhance comfort and manoeuvrability, including twin Seakeeper 9 gyro stabilisers, a Dynamic Positioning System (DPS), joystick controls, Humphree automatic trim control, and both bow and stern thrusters. Together, these systems make handling straightforward while significantly improving comfort both underway and at anchor. The main deck benefits from abundant natural light thanks to large panoramic windows. The saloon combines a comfortable lounge area, formal dining space and an open-plan galley equipped with Miele appliances, creating a practical and sociable environment for everyday life on board.

Accommodation is arranged for up to 8 guests in 4 cabins. The layout includes a full-beam owner's suite, a forward VIP cabin, a twin guest cabin and a bunk-bed cabin. This versatile configuration is particularly well suited to family cruising and hosting guests of different ages.

Outdoor spaces have been designed for relaxed Mediterranean living. The aft cockpit features an al fresco dining area, while the hydraulic swim platform provides convenient access to the water and tender. Forward, guests can enjoy dedicated sunbathing and lounge areas, while the flybridge is equipped with a hardtop, bar, refrigerator, ice maker and barbecue, creating an additional social space with panoramic views.

A Williams Turbojet 385 tender is also included, completing a specification that makes **CRAZY DIAMOND** an attractive turnkey opportunity for private cruising and family adventures on the water.

[see more information about M/Y CRAZY DIAMOND at www.nauyachts.com](http://www.nauyachts.com)

SPECIFICATION

SHIPYARD, MODEL	Monte Carlo Yachts MCY 70
BUILT	2016
LENGTH	21.3 m
WATERLINE LENGTH	19.88 m
HULL CONFIGURATION	PLANING
BEAM	5.72 m
RANGE	280
DRAFT	1.76 m
GROSS TONNAGE	52 GT
YACHT CLASS	RINA
CABINS	4+1
MASTER CABIN	LOWER DECK
GUESTS	8
BERTHS	8+2
CREW	2
HEADS	4+1

EXTERIOR DESIGN	MONTE CARLO YACHTS
INTERIOR DESIGN	MONTE CARLO YACHTS
HULL	GRP
SUPERSTRUCTURE	GRP
ENGINES	2 x MAN V8 1200 h.p.
TYPE OF DRIVE	SHAFT LINE
ENGINE HOURS	500 h
MAXIMUM SPEED	29 kn
CRUSING SPEED	22 kn
FUEL CONSUMPTION AT ECONOMICAL SPEED	~ 360 l/h
FUEL	4000 l
GREY WATER	300 l
BLACK WATER	400 l
FRESH WATER	800 l
DISPLACEMENT	45

[see more information about M/Y CRAZY DIAMOND at www.nauyachts.com](http://www.nauyachts.com)



EXTERIOR MCY 70 2016 MY CRAZY DIAMOND

M/Y CRAZY DIAMOND



EXTERIOR MCY 70 2016 MY CRAZY DIAMOND

M/Y CRAZY DIAMOND



EXTERIOR MCY 70 2016 MY CRAZY DIAMOND

M/Y CRAZY DIAMOND



EXTERIOR MCY 70 2016 MY CRAZY DIAMOND

M/Y CRAZY DIAMOND



TENDER

M/Y CRAZY DIAMOND



COCKPIT DINING AREA

M/Y CRAZY DIAMOND



BOW LOUNGE AREA

M/Y CRAZY DIAMOND



BOW LOUNGE AREA

M/Y CRAZY DIAMOND



FLYBRIDGE LOUNGE AREA

M/Y CRAZY DIAMOND



FLYBRIDGE LOUNGE AREA

M/Y CRAZY DIAMOND



SECOND HELM STATION

M/Y CRAZY DIAMOND



FLYBRIDGE LOUNGE AREA

M/Y CRAZY DIAMOND



MAIN SALON LOUNGE AREA

M/Y CRAZY DIAMOND



MAIN SALON LOUNGE AREA

M/Y CRAZY DIAMOND



MAIN SALON LOUNGE AREA

M/Y CRAZY DIAMOND



MAIN SALON DINING AREA

M/Y CRAZY DIAMOND



GALLEY

M/Y CRAZY DIAMOND



VIP CABIN

M/Y CRAZY DIAMOND



VIP BATHROOM

M/Y CRAZY DIAMOND



GUEST CABIN

M/Y CRAZY DIAMOND



GUEST BATHROOM

M/Y CRAZY DIAMOND



GUEST CABIN

M/Y CRAZY DIAMOND



GUEST BATHROOM

M/Y CRAZY DIAMOND



MASTER CABIN

M/Y CRAZY DIAMOND



MASTER CABIN

M/Y CRAZY DIAMOND



MASTER BATHROOM

M/Y CRAZY DIAMOND



MASTER BATHROOM

M/Y CRAZY DIAMOND



ENGINE ROOM

M/Y CRAZY DIAMOND

General Arrangement

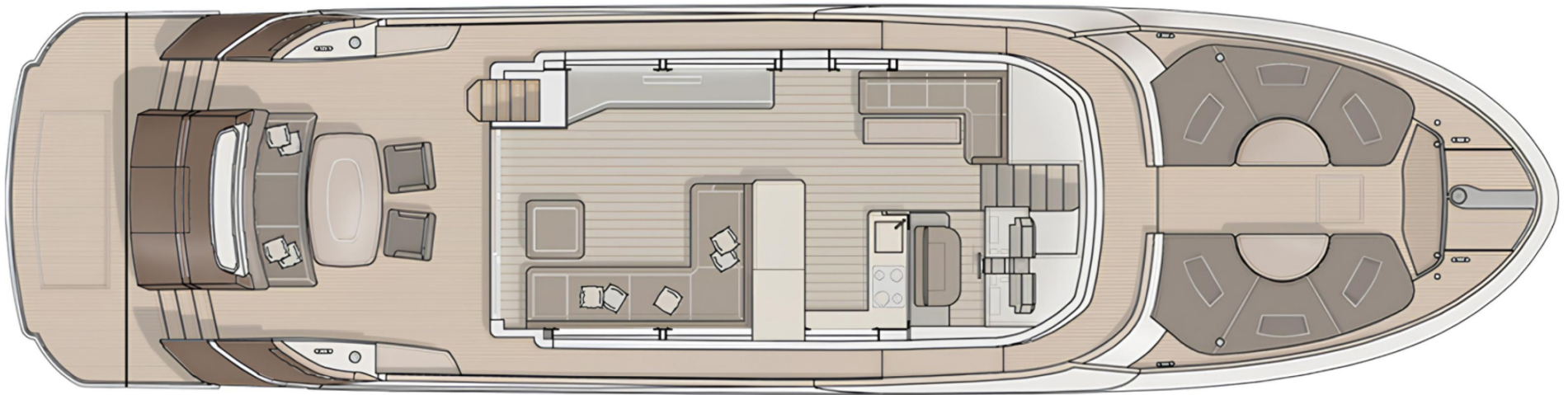

MAIN DECK



LOWER DECK



KIRILL KUATOV

+377 607 93 15 20

+39 333 576 44 44

[Send e-mail](#)

[WhatsApp](#)

[Telegram](#)