



Brokerage

NAU
YACHTS

ST JUDE

MOTOR YACHT AZIMUT 26.09M 2025

€6,495,000
FLAG - PORTUGAL

MOTOR YACHT

ST JUDE

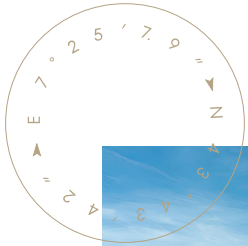

ST JUDE is a 2025 Azimut Grande 26M presented in exceptional condition and professionally managed by a dedicated crew since delivery. With approximately €2 million invested in factory options, technical upgrades and bespoke enhancements, she stands among the highest-specified Grande 26M yachts ever built and offers a rare opportunity to acquire a virtually new yacht without the lead time associated with a new-build project.

Offering approximately 122 GT of internal volume and accommodation for up to 11 guests, **ST JUDE** combines the proven Grande 26M platform with a level of equipment and customisation rarely found within this segment of the market. Every aspect of the yacht has been carefully specified to enhance comfort, functionality and long-term ownership experience.

One of **ST JUDE's** most significant advantages is her comprehensive stabilisation package. The yacht is equipped with both fin stabilisers and an upgraded Seakeeper 35 gyroscopic stabiliser, delivering exceptional comfort both underway and at anchor. This dual-system configuration significantly reduces motion in a wide range of conditions, enhancing the onboard experience during extended cruising and time spent at anchor.

Performance and manoeuvrability have also been enhanced through a combination of upgraded MAN V12 engines, joystick controls and advanced propulsion systems. Together, these features provide excellent handling, simplified docking procedures and improved operational efficiency, making the yacht equally comfortable for owner operation and professional crew management.

With her extensive specification, proven design platform and virtually new condition, **ST JUDE** represents one of the most compelling opportunities currently available in the 26-metre market, combining the benefits of a recent delivery with a level of equipment and refinement rarely achieved even among new-build examples.

[see more information about M/Y ST JUDE at www.nauyachts.com](http://www.nauyachts.com)

SPECIFICATION

SHIPYARD, MODEL	Azimut Grande 26M
BUILT	2025
LENGTH	26.09 m
WATERLINE LENGTH	21.81 m
HULL CONFIGURATION	PLANING
BEAM	6.3 m
RANGE	379
DRAFT	2.05 m
GROSS TONNAGE	122 GT
YACHT CLASS	CE
CABINS	5+3
MASTER CABIN	MAIN DECK
GUESTS	11
BERTHS	11+5
CREW	5
HEADS	6+1

EXTERIOR DESIGN	ALBERTO MANCINI
INTERIOR DESIGN	ACHILLE SALVAGNI ARCHITETTI
HULL	GRP
SUPERSTRUCTURE	GRP
ENGINES	2 x MAN V12 1650 h.p.
TYPE OF DRIVE	SHAFT LINE
ENGINE HOURS	422 h
MAXIMUM SPEED	26 kn
CRUISING SPEED	23 kn
FUEL CONSUMPTION AT ECONOMICAL SPEED	~ 170 l/h
FUEL	8500 l
GREY WATER	820 l
BLACK WATER	820 l
FRESH WATER	1500 l
DISPLACEMENT	84.4

[see more information about M/Y ST JUDE at www.nauyachts.com](http://www.nauyachts.com)



EXTERIOR AZIMUT GRANDE 26M 2025 MY ST
JUDE

M/Y ST JUDE



EXTERIOR AZIMUT GRANDE 26M 2025 MY ST
JUDE

M/Y ST JUDE



EXTERIOR AZIMUT GRANDE 26M 2025 MY ST
JUDE

M/Y ST JUDE



EXTERIOR AZIMUT GRANDE 26M 2025 MY ST
JUDE

M/Y ST JUDE



EXTERIOR AZIMUT GRANDE 26M 2025 MY ST
JUDE

M/Y ST JUDE



EXTERIOR AZIMUT GRANDE 26M 2025 MY ST
JUDE

M/Y ST JUDE



AFT AREA

M/Y ST JUDE



FLYBRIDGE LOUNGE AREA

M/Y ST JUDE



FLYBRIDGE LOUNGE AREA

M/Y ST JUDE



FLYBRIDGE DINING AREA

M/Y ST JUDE



FLYBRIDGE DINING AREA

M/Y ST JUDE



SECOND HELM STATION

M/Y ST JUDE



FLYBRIDGE LOUNGE AREA

M/Y ST JUDE



COCKPIT DINING AREA

M/Y ST JUDE



COCKPIT DINING AREA

M/Y ST JUDE



BOW LOUNGE AREA

M/Y ST JUDE



BOW LOUNGE AREA

M/Y ST JUDE



MAIN SALON LOUNGE AREA

M/Y ST JUDE



MAIN SALON LOUNGE AREA

M/Y ST JUDE



MAIN SALON LOUNGE AREA

M/Y ST JUDE



MAIN SALON LOUNGE AREA

M/Y ST JUDE



MAIN SALON DINING AREA

M/Y ST JUDE



MAIN SALON DINING AREA

M/Y ST JUDE



MASTER CABIN

M/Y ST JUDE



MASTER CABIN

M/Y ST JUDE



MASTER CABIN

M/Y ST JUDE



MAKE-UP TABLE IN MASTER CABIN

M/Y ST JUDE



MASTER BATHROOM

M/Y ST JUDE



MASTER BATHROOM

M/Y ST JUDE



VIP CABIN

M/Y ST JUDE



VIP CABIN

M/Y ST JUDE



VIP BATHROOM

M/Y ST JUDE



GUEST CABIN

M/Y ST JUDE



MAIN HELM STATION

M/Y ST JUDE



GALLEY

M/Y ST JUDE



CREW AREA

M/Y ST JUDE

General Arrangement

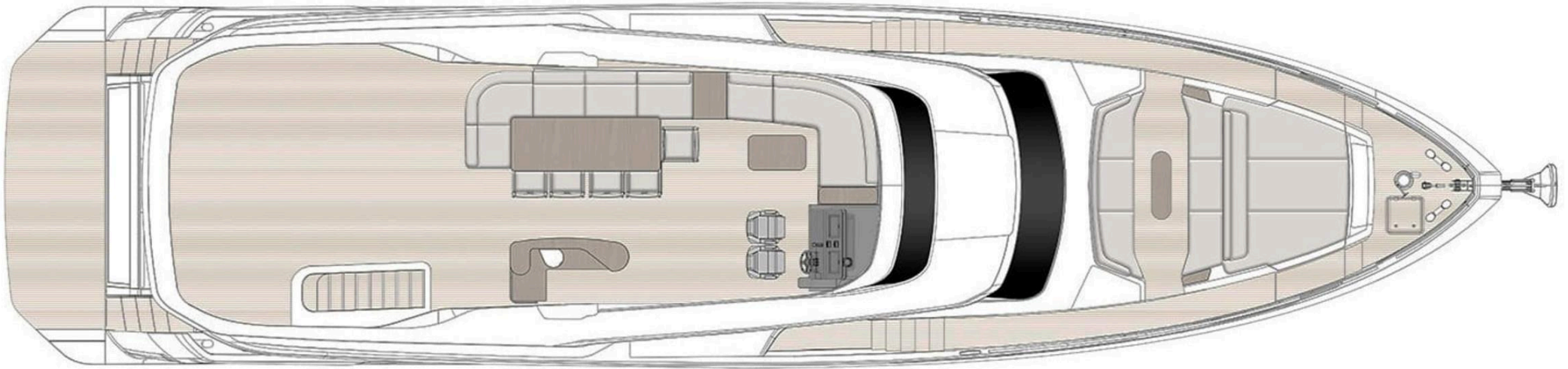

FLYBRIDGE

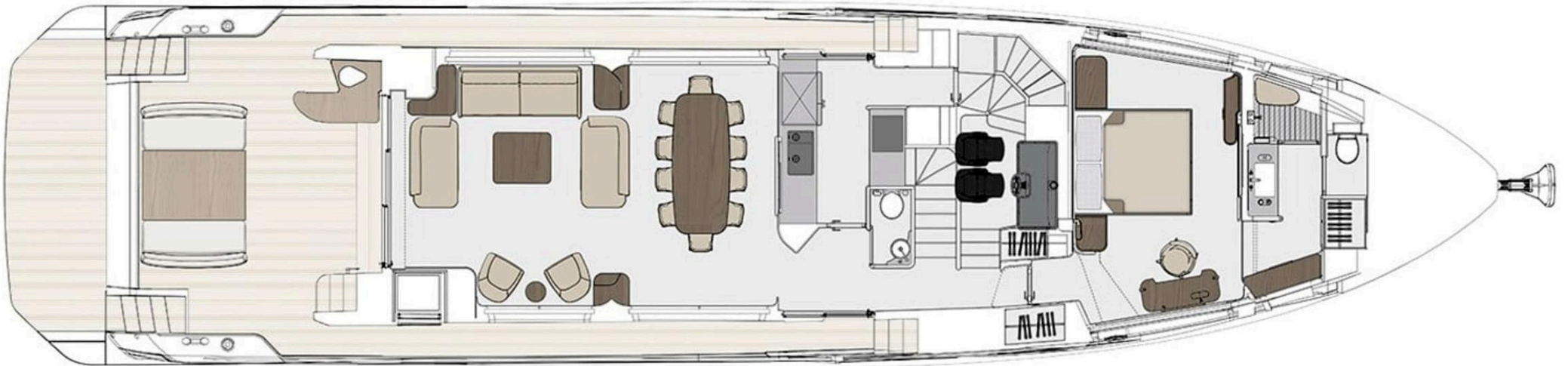

MAIN DECK

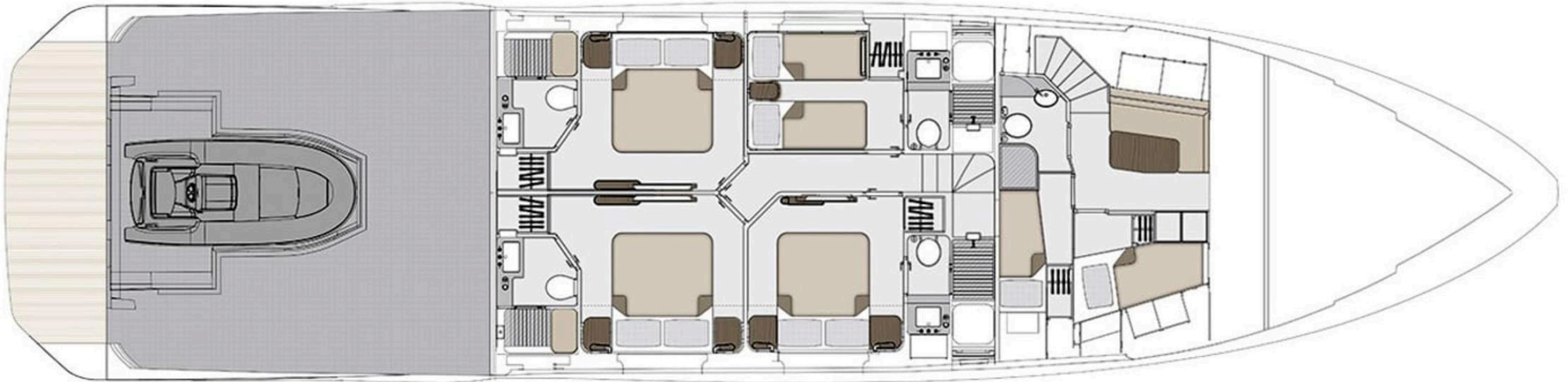

LOWER DECK



KIRILL KUATOV

+377 607 93 15 20

+39 333 576 44 44

[Send e-mail](#)

[WhatsApp](#)

[Telegram](#)