



Brokerage

NAU
YACHTS

LORI

MOTOR YACHT OCEAN KING 41.8M 2024

€21,500,000 (VAT
paid)

FLAG - MALTA

MOTOR YACHT

LORI



LORI is a 41.8-metre **Ocean King Doge 400 GT** delivered in 2024 and designed for owners seeking genuine long-range cruising capability without compromising on comfort, contemporary styling or onboard amenities. Featuring a steel hull, aluminium superstructure and naval architecture by Simon Rogers, she combines the robustness and reliability of an explorer platform with modern Italian design and exceptional cruising autonomy.

With an internal volume of 335 GT, accommodation for up to 10 guests and a range of approximately 5,500 nautical miles, **LORI** is equally suited to extended private voyages, remote cruising destinations and commercial charter operations. Within the 40-metre segment, few yachts offer such a compelling combination of volume, range and self-sufficiency in such a contemporary package.

Built by **Ocean King**, a shipyard renowned for its commercial and expedition heritage, **LORI** has been engineered with long-distance cruising at the forefront of the design brief. Her substantial 55,000-litre fuel capacity, 15,000-litre freshwater capacity and efficient MAN propulsion system provide the endurance and reliability expected of a true explorer yacht while maintaining the comfort and refinement associated with modern superyacht ownership.

The result is a yacht capable of undertaking ambitious cruising itineraries with confidence, offering owners and guests the freedom to explore remote regions while enjoying spacious accommodations, contemporary living spaces and a high degree of onboard independence.

Combining expedition capability, modern design and impressive long-range credentials, **LORI** stands out as one of the most versatile and capable yachts in her class, equally at home on extended private adventures or operating as a premium charter platform.

[see more information about M/Y LORI at www.nauyachts.com](http://www.nauyachts.com)

SPECIFICATION

SHIPYARD, MODEL	Ocean King Doge 400GT
BUILT	2024
LENGTH	41.8 m
WATERLINE LENGTH	35.65 m
HULL CONFIGURATION	DISPLACEMENT
BEAM	8.5 m
RANGE	5500
DRAFT	2.4 m
GROSS TONNAGE	335 GT
YACHT CLASS	LLOYD'S
CABINS	5+4
MASTER CABIN	MAIN DECK
GUESTS	10
BERTHS	10+7
CREW	7
HEADS	7+4

EXTERIOR DESIGN	ALOT
INTERIOR DESIGN	MARGINI ARCHITECTS
HULL	STEEL
SUPERSTRUCTURE	ALUMINIUM
ENGINES	2 x MAN D2868 LE 489V12 1450 h.p.
TYPE OF DRIVE	SHAFT LINE
ENGINE HOURS	657 h
MAXIMUM SPEED	16 kn
CRUSING SPEED	10 kn
FUEL CONSUMPTION AT ECONOMICAL SPEED	N/A
FUEL	55000 l
GREY WATER	5000 l
BLACK WATER	5000 l
FRESH WATER	15000 l
DISPLACEMENT	320

[see more information about M/Y LORI at www.nauyachts.com](http://www.nauyachts.com)



EXTERIOR OCEAN KING DOGE 400 GT 2024
MY LORI

M/Y LORI



EXTERIOR OCEAN KING DOGE 400 GT 2024
MY LORI

M/Y LORI



EXTERIOR OCEAN KING DOGE 400 GT 2024
MY LORI

M/Y LORI



EXTERIOR OCEAN KING DOGE 400 GT 2024
MY LORI

M/Y LORI



EXTERIOR OCEAN KING DOGE 400 GT 2024
MY LORI

M/Y LORI



EXTERIOR OCEAN KING DOGE 400 GT 2024
MY LORI

M/Y LORI



AFT AREA

M/Y LORI



BEACH CLUB

M/Y LORI



BEACH CLUB

M/Y LORI



BEACH CLUB

M/Y LORI



AFT MAIN DECK LOUNGE AREA

M/Y LORI



AFT MAIN DECK LOUNGE AREA

M/Y LORI



AFT UPPER DECK LOUNGE AREA
ОТДЫХА НА КОРМЕ ГЛАВНОЙ ПАЛУБЫ

M/Y LORI



SUNDECK LOUNGE AREA

M/Y LORI



SUNDECK LOUNGE AREA

M/Y LORI



SUNDECK LOUNGE AREA

M/Y LORI



SUNDECK LOUNGE AREA

M/Y LORI



UPPER DECK SALOON

M/Y LORI



UPPER DECK SALOON

M/Y LORI



MAIN SALON LOUNGE AREA

M/Y LORI



MAIN SALON LOUNGE AREA

M/Y LORI



MAIN SALON LOUNGE AREA

M/Y LORI



MAIN SALON DINING AREA

M/Y LORI



MAIN SALON LOBBY

M/Y LORI



MASTER CABIN

M/Y LORI



OFFICE IN THE MASTER CABIN

M/Y LORI



MASTER BATHROOM

M/Y LORI



VIP CABIN

M/Y LORI



VIP BATHROOM

M/Y LORI



VIP CABIN

M/Y LORI



VIP CABIN

M/Y LORI



VIP CABIN

M/Y LORI



MAIN HELM STATION

M/Y LORI

General Arrangement

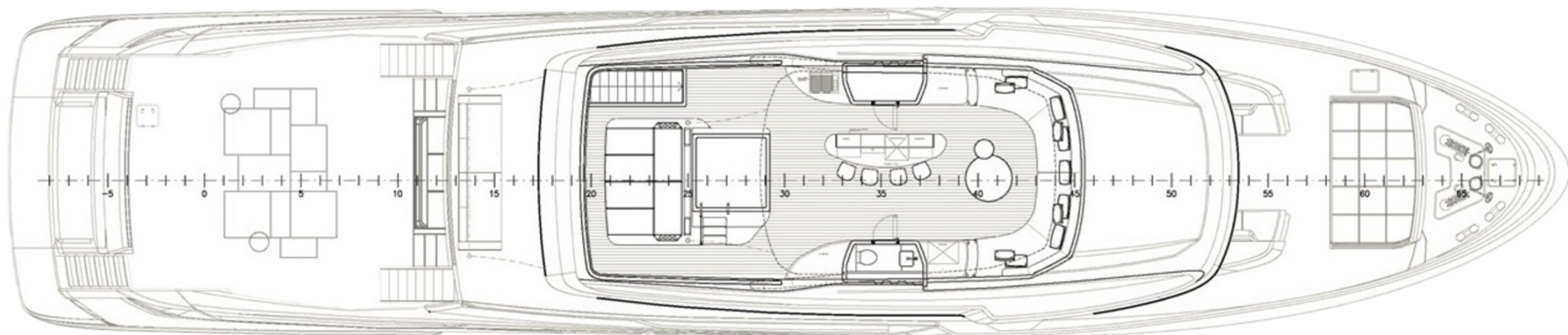

SUNDECK

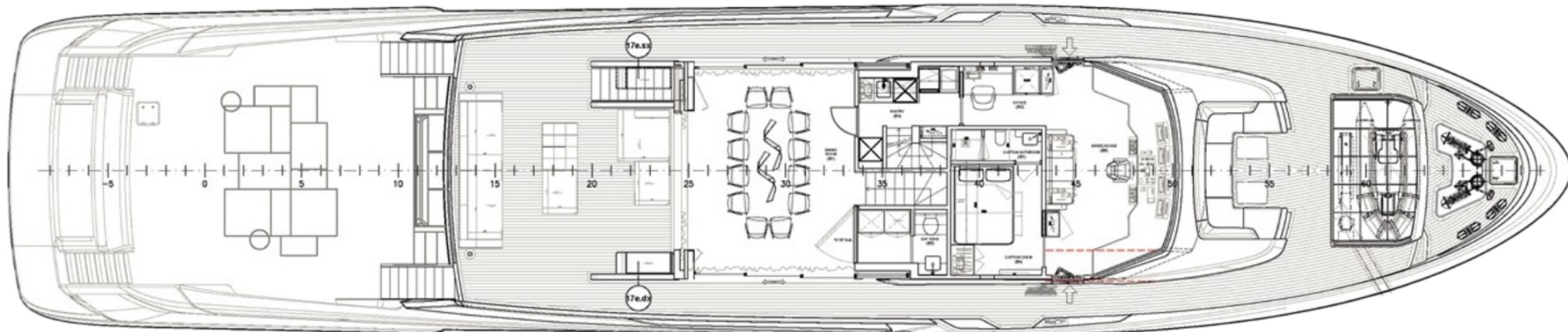

UPPER DECK

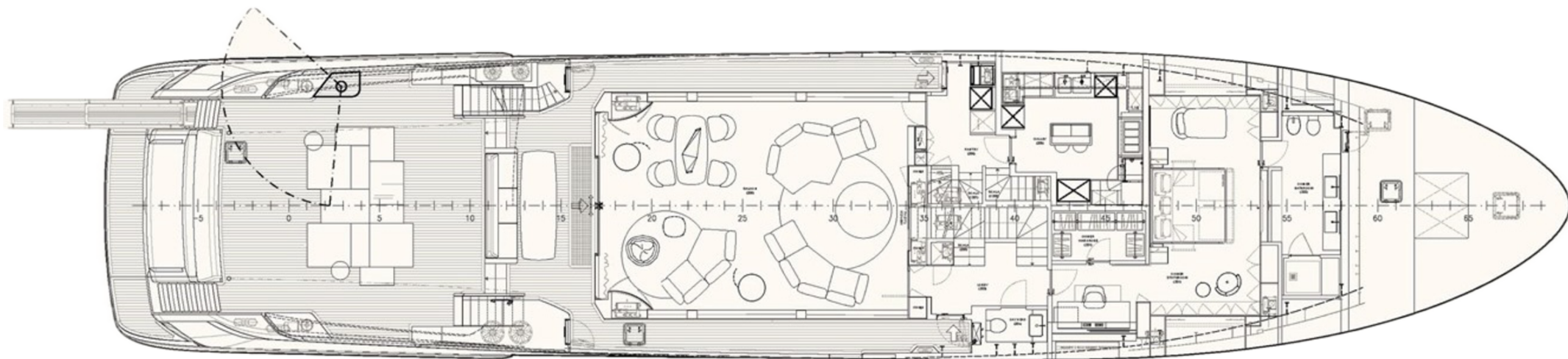

MAIN DECK

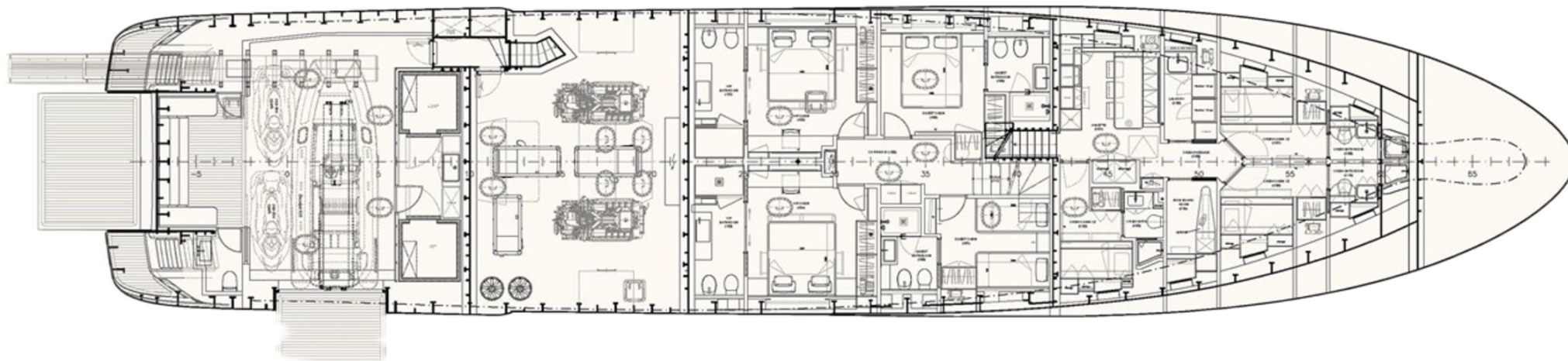

LOWER DECK



KIRILL KUATOV

+377 607 93 15 20

+39 333 576 44 44

[Send e-mail](#)

[WhatsApp](#)

[Telegram](#)