



Brokerage

NAU
YACHTS

GRACE

MOTOR YACHT MONTE CARLO YACHTS 20.11M 2020

€1,640,000
FLAG - POLAND

MOTOR YACHT

GRACE



GRACE is an exceptionally well-specified **Monte Carlo Yachts MCY 66**, delivered in 2020 and privately owned since new. With just 710 engine hours, an extensive factory options package and a history of consistent professional maintenance, she is presented in outstanding condition and represents one of the most attractive **MCY 66** opportunities currently available on the market.

Both the exterior and interior were designed by renowned Italian studio Nuvolari Lenard, whose signature approach combines timeless styling, elegant proportions and practical functionality. The result is a yacht that offers the distinctive character of the Monte Carlo Yachts brand together with impressive comfort and versatility. **GRACE** features a Deep V hull constructed in GRP and reinforced with Kevlar® and carbon fibre, creating a structure that is both lightweight and exceptionally strong. This advanced construction enhances efficiency, improves performance and contributes to the confident seakeeping characteristics for which the **MCY** range is widely respected.

Accommodation is arranged for up to six guests in three en-suite cabins, complemented by separate crew quarters. The interior offers a refined and welcoming atmosphere, making the yacht equally suited to family cruising, entertaining guests or extended stays on board.

A comprehensive specification further enhances her appeal. Key features include a Seakeeper NG9 gyroscopic stabiliser, joystick manoeuvring controls, a Williams 325 Jet Tender, watermaker, upgraded generator package and numerous additional options selected to support comfortable long-range cruising and effortless day-to-day operation.

Combining elegant Italian design, advanced construction, low engine hours and a highly desirable specification, **GRACE** stands out as one of the finest examples of the **Monte Carlo Yachts MCY 66** currently available.

[see more information about M/Y GRACE at www.nauyachts.com](http://www.nauyachts.com)

SPECIFICATION

SHIPYARD, MODEL	Monte Carlo Yachts MCY 66
BUILT	2020
LENGTH	20.11 m
WATERLINE LENGTH	16.11 m
HULL CONFIGURATION	PLANING
BEAM	5.2 m
RANGE	250
DRAFT	1.24 m
GROSS TONNAGE	45 GT
YACHT CLASS	CE
CABINS	3+1
MASTER CABIN	LOWER DECK
GUESTS	6
BERTHS	6+2
CREW	2
HEADS	3+1

EXTERIOR DESIGN	NUVOLARI LENARD
INTERIOR DESIGN	NUVOLARI LENARD
HULL	GRP
SUPERSTRUCTURE	GRP
ENGINES	2 x MAN V8 1200 h.p.
TYPE OF DRIVE	SHAFT LINE
ENGINE HOURS	710 h
MAXIMUM SPEED	30 kn
CRUSING SPEED	26 kn
FUEL CONSUMPTION AT ECONOMICAL SPEED	~ 300 l/h
FUEL	3500 l
GREY WATER	200 l
BLACK WATER	350 l
FRESH WATER	750 l
DISPLACEMENT	36

[see more information about M/Y GRACE at www.nauyachts.com](http://www.nauyachts.com)



EXTERIOR MONTE CARLO YACHTS MCY 66
2020 MY GRACE

M/Y GRACE



EXTERIOR MONTE CARLO YACHTS MCY 66
2020 MY GRACE

M/Y GRACE



EXTERIOR MONTE CARLO YACHTS MCY 66
2020 MY GRACE

M/Y GRACE



EXTERIOR MONTE CARLO YACHTS MCY 66
2020 MY GRACE

M/Y GRACE



EXTERIOR MONTE CARLO YACHTS MCY 66
2020 MY GRACE

M/Y GRACE



EXTERIOR MONTE CARLO YACHTS MCY 66
2020 MY GRACE

M/Y GRACE



FLYBRIDGE LOUNGE AREA

M/Y GRACE



FLYBRIDGE LOUNGE AREA

M/Y GRACE



MAIN SALON LOUNGE AREA

M/Y GRACE



MAIN SALON LOUNGE AREA

M/Y GRACE



MAIN SALON LOUNGE AREA

M/Y GRACE



MAIN SALON DINING AREA

M/Y GRACE



MAIN HELM STATION

M/Y GRACE



MASTER CABIN

M/Y GRACE



MASTER CABIN

M/Y GRACE



MASTER BATHROOM

M/Y GRACE



LOWER DECK LOBBY

M/Y GRACE



VIP CABIN

M/Y GRACE



VIP BATHROOM

M/Y GRACE



GUEST CABIN

M/Y GRACE

General Arrangement

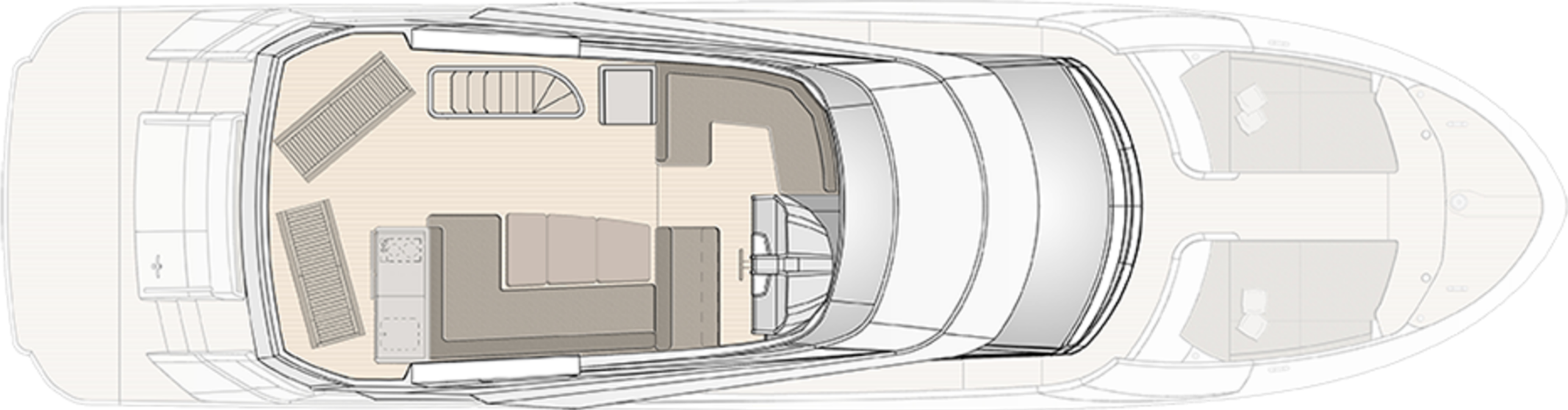

FLYBRIDGE

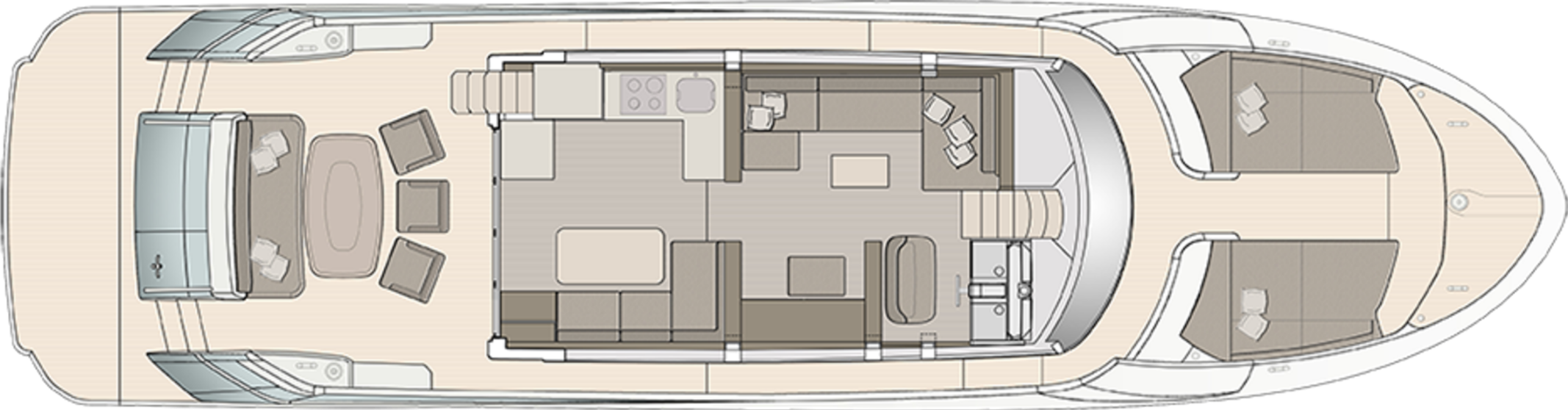

MAIN DECK

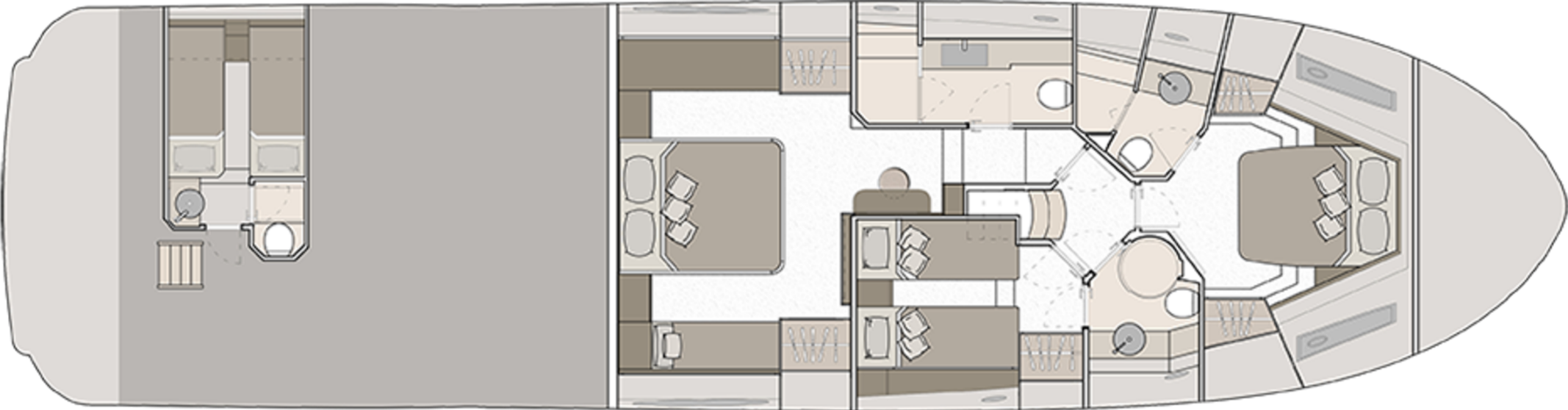

LOWER DECK



KIRILL KUATOV

+377 607 93 15 20

+39 333 576 44 44

[Send e-mail](#)

[WhatsApp](#)

[Telegram](#)