



Brokerage

NAU
YACHTS

ANTARES

CUSTOM BUILT 40M 2005

€6,900,000
FLAG - UK

ANTARES



ANTARES is an exceptional **Royal Huisman** world-cruising motorsailer that combines proven transoceanic capability, outstanding Dutch craftsmanship and an extraordinary level of maintenance and investment throughout her life. Designed for serious long-range sailing and extended periods of autonomous living aboard, she represents a rare opportunity to acquire a genuinely capable bluewater yacht in turnkey condition.

Designed by Dixon Yacht Designs and built entirely in aluminium to the exacting standards for which Royal Huisman is internationally renowned, **ANTARES** was engineered from the outset for global exploration. Her robust construction, well-considered technical architecture and extensive operational history in remote regions have established her as a yacht capable of undertaking demanding ocean passages with confidence and reliability.

One of the most significant milestones in the yacht's recent history was the successful completion of her 20-year Lloyd's Special Survey in May 2025. For a sailing yacht of this size, this represents one of the most important stages in her lifecycle, providing independent confirmation of her technical condition and significantly enhancing her appeal to future owners. In conjunction with the survey, **ANTARES** benefited from further upgrades to onboard systems, engineering equipment and living spaces, ensuring she remains ready for immediate cruising. **ANTARES** also boasts a proven record of long-distance voyaging, including extensive cruising throughout the South Pacific. Unlike many yachts that are marketed as world cruisers but have rarely ventured beyond established yachting destinations, **ANTARES** has repeatedly demonstrated her capabilities in real-world conditions. Her systems have been developed and refined for self-sufficient operation far from major support infrastructure, while ongoing upgrades have focused on reliability, serviceability and long-term independence during extended passages.

Guest accommodation is arranged in four en-suite cabins, offering comfort and privacy for owners and guests alike. Particular attention should be given to the full-beam owner's suite on the lower deck, which benefits from a private entrance to the aft deck. This uncommon arrangement provides a level of privacy and exclusivity more typically associated with substantially larger sailing yachts.

Combining **Royal Huisman** pedigree, proven global cruising credentials, a completed Lloyd's 20-year survey and a remarkable history of continuous upgrades, **ANTARES** stands as one of the most compelling long-range sailing yachts available today for owners seeking genuine bluewater capability without compromise.

[see more information about ANTARES at www.nauyachts.com](http://www.nauyachts.com)

SPECIFICATION

SHIPYARD, MODEL	Custom Built Ketch Sailing Yacht
BUILT	2005
LENGTH	40 m
WATERLINE LENGTH	33.75 m
HULL CONFIGURATION	DISPLACEMENT
BEAM	8.77 m
RANGE	3500
DRAFT	4.22 m
GROSS TONNAGE	218 GT
YACHT CLASS	LLOYD'S
CABINS	4+3
MASTER CABIN	LOWER DECK
GUESTS	9
BERTHS	9+6
CREW	6
HEADS	4+2

EXTERIOR DESIGN	DIXON YACHT DESIGNS
INTERIOR DESIGN	DICK YOUNG DESIGNS
HULL	ALUMINIUM
SUPERSTRUCTURE	ALUMINIUM
ENGINES	CATERPILLAR C18 ACERT 715 H.P.
TYPE OF DRIVE	SHAFT LINE
ENGINE HOURS	11650 h
MAXIMUM SPEED	12.5 kn
CRUISING SPEED	11 kn
FUEL CONSUMPTION AT ECONOMICAL SPEED	~ 70 l/h
FUEL	16837 l
GREY WATER	3100 l
BLACK WATER	3100 l
FRESH WATER	4067 l
DISPLACEMENT	210

[see more information about ANTARES at www.nauyachts.com](http://www.nauyachts.com)



EXTERIOR ROYAL HUISMAN 40M 2005 MS
ANTARES

ANTARES



EXTERIOR ROYAL HUISMAN 40M 2005 MS
ANTARES

ANTARES



EXTERIOR ROYAL HUISMAN 40M 2005 MS
ANTARES

ANTARES



EXTERIOR ROYAL HUISMAN 40M 2005 MS
ANTARES

ANTARES



BOW AREA

ANTARES



BOW AREA

ANTARES



BOW LOUNGE AREA

ANTARES



SECOND HELM STATION

ANTARES



MAIN DECK LOUNGE AREA

ANTARES



MAIN DECK LOUNGE AREA

ANTARES



STARBOARD

ANTARES



AFT AREA

ANTARES



SWIMMING PLATFORM

ANTARES



MAIN SALON DINING AREA

ANTARES



MAIN SALON DINING AREA

ANTARES



MAIN HELM STATION

ANTARES



MAIN SALON LOUNGE AREA

ANTARES



LOWER DECK LOBBY

ANTARES



LOWER DECK LOBBY

ANTARES



OFFICE IN THE MASTER CABIN

ANTARES



MASTER CABIN

ANTARES



MASTER CABIN

ANTARES



MASTER CABIN

ANTARES



MASTER CABIN

ANTARES



MASTER BATHROOM

ANTARES



VIP CABIN

ANTARES



VIP CABIN

ANTARES



VIP BATHROOM

ANTARES



GALLEY

ANTARES

General Arrangement

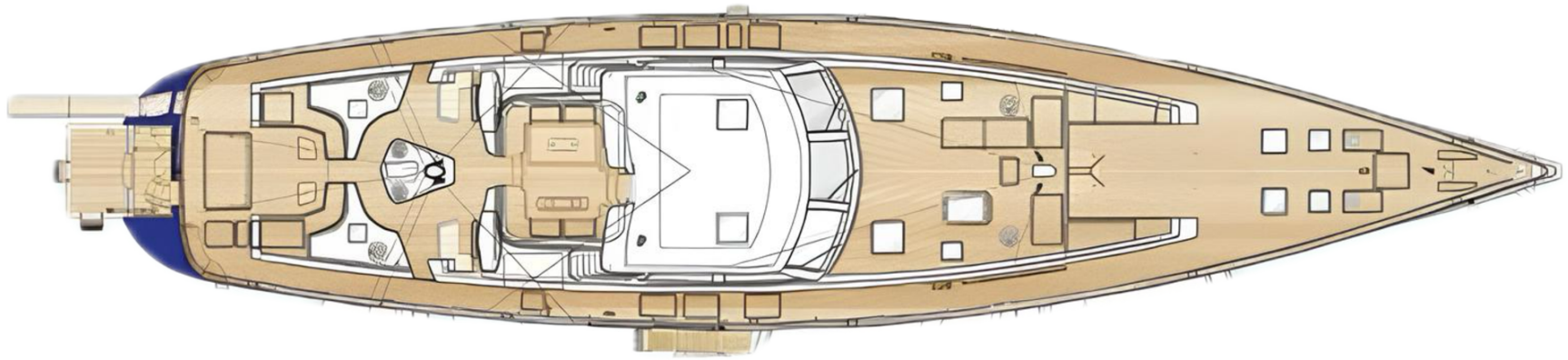

MAIN DECK

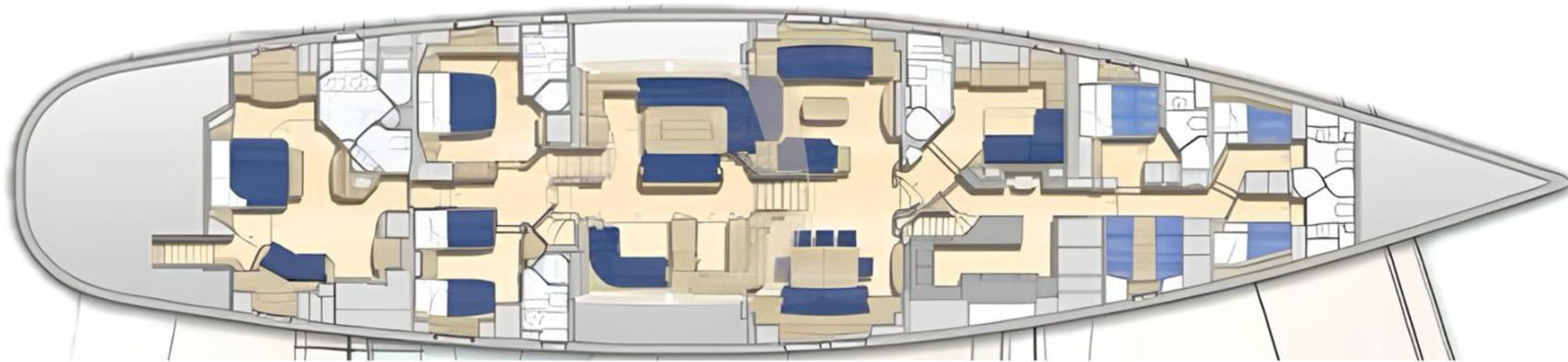

LOWER DECK



KIRILL KUATOV

+377 607 93 15 20

+39 333 576 44 44

[Send e-mail](#)

[WhatsApp](#)

[Telegram](#)

[More information about ANTARES at www.nauyachts.com](http://www.nauyachts.com)

[Watch video](#)