



Brokerage

NAU  
YACHTS

ARMONEE

MOTOR YACHT    COUACH 23.2M    2017

€1,400,000  
FLAG - FRANCE



MOTOR YACHT

## ARMONEE

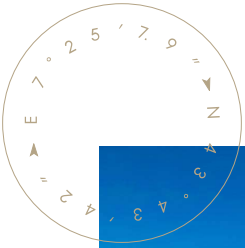

**ARMONEE** is a 23.2-metre flybridge motor yacht built by **Couach** in 2017 as part of the **2300 Fly** series. This model represents a natural evolution of the shipyard's 1800, 1900 and 2200 lines, retaining Couach's signature performance while benefiting from updated hull architecture, modern onboard systems and advanced composite construction. Teak decks run throughout, and the hull is finished in a distinctive silver-brown colour. With a beam of 5.77 metres and a draft of just 1.35 metres, **ARMONEE** is well suited to Mediterranean cruising, anchoring in shallow bays and accessing marinas with limited depth.

The layout accommodates up to eight guests in four cabins. Three cabins are notably spacious, while the fourth is designed for teenagers or occasional guests. The interior features a neutral grey and beige palette, combining natural wood, marble, parquet flooring and high-quality textiles to create a calm and contemporary atmosphere. Lighting, blinds and multimedia systems are fully integrated into an onboard automation system. A separate crew cabin for two ensures discreet and efficient service.

Power comes from twin MAN V12 engines, each producing 1,400 hp, delivering a comfortable cruising speed of around 24 knots and a top speed of up to 34 knots. Noise and vibration levels are kept to a minimum thanks to underwater exhausts, specialised engine mounts and zero-speed gyroscopic stabilisers, enhancing comfort both underway and at anchor.

Flying the French flag and maintained in very good condition, **ARMONEE** is a modern flybridge yacht designed for owners who value a combination of performance, comfort and **Couach's** engineering expertise.

[see more information about M/Y ARMONEE at www.nauyachts.com](http://www.nauyachts.com)

# SPECIFICATION

SHIPYARD, MODEL	Couach 2300 Fly
BUILT	2017
LENGTH	23.2 m
WATERLINE LENGTH	21 m
HULL CONFIGURATION	PLANING
BEAM	5.77 m
RANGE	1120
DRAFT	1.35 m
GROSS TONNAGE	70 GT
YACHT CLASS	BUREAU VERITAS
CABINS	4+1
MASTER CABIN	LOWER DECK
GUESTS	8
BERTHS	8+2
CREW	2
HEADS	3+1

EXTERIOR DESIGN	COUACH
INTERIOR DESIGN	COUACH
HULL	GRP
SUPERSTRUCTURE	GRP
ENGINES	2 x MAN V12 1400 h.p.
TYPE OF DRIVE	SHAFT LINE
ENGINE HOURS	2120 h
MAXIMUM SPEED	30 kn
CRUISING SPEED	10 kn
FUEL CONSUMPTION AT ECONOMICAL SPEED	~ 350 l/h
FUEL	6000 l
GREY WATER	600 l
BLACK WATER	600 l
FRESH WATER	1000 l
DISPLACEMENT	49.5

[see more information about M/Y ARMONEE at www.nauyachts.com](http://www.nauyachts.com)





EXTERIOR COUACH 2300 FLY 2017 MY  
ARMONEE

M/Y ARMONEE





EXTERIOR COUACH 2300 FLY 2017 MY  
ARMONEE

M/Y ARMONEE





COCKPIT DINING AREA

M/Y ARMONEE





BOW LOUNGE AREA

M/Y ARMONEE





FLYBRIDGE DINING AREA

M/Y ARMONEE





MAIN SALON LOUNGE AREA

M/Y ARMONEE





MASTER CABIN

M/Y ARMONEE





MASTER CABIN

M/Y ARMONEE





MASTER CABIN

M/Y ARMONEE





MASTER CABIN

M/Y ARMONEE





MAKE-UP TABLE IN MASTER CABIN

M/Y ARMONEE





MASTER BATHROOM

M/Y ARMONEE





MASTER BATHROOM

M/Y ARMONEE





VIP CABIN

M/Y ARMONEE





VIP CABIN

M/Y ARMONEE





VIP CABIN

M/Y ARMONEE





VIP CABIN

M/Y ARMONEE





VIP CABIN

M/Y ARMONEE





VIP BATHROOM

M/Y ARMONEE





GUEST CABIN

M/Y ARMONEE



# General Arrangement



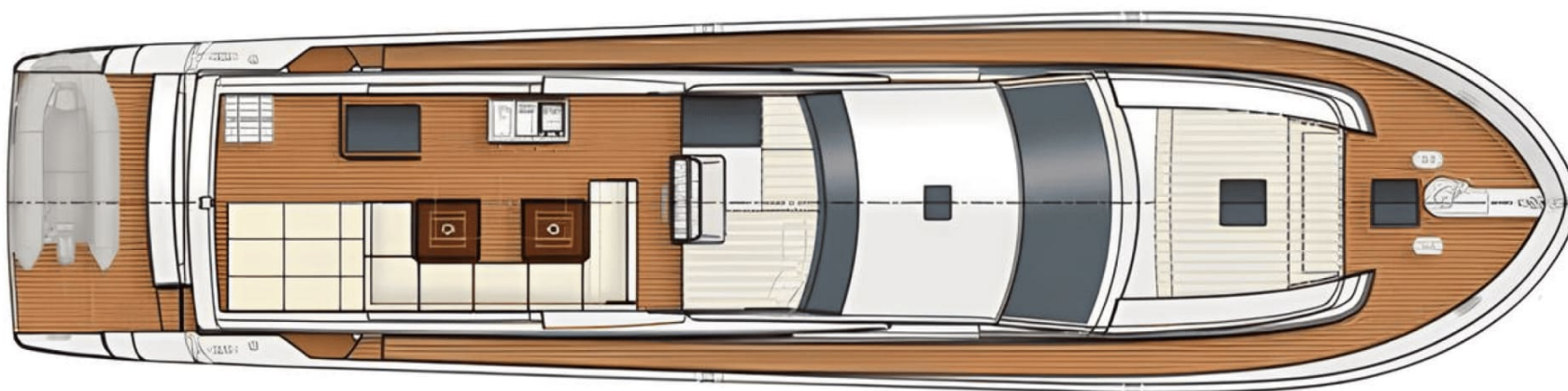

FLYBRIDGE



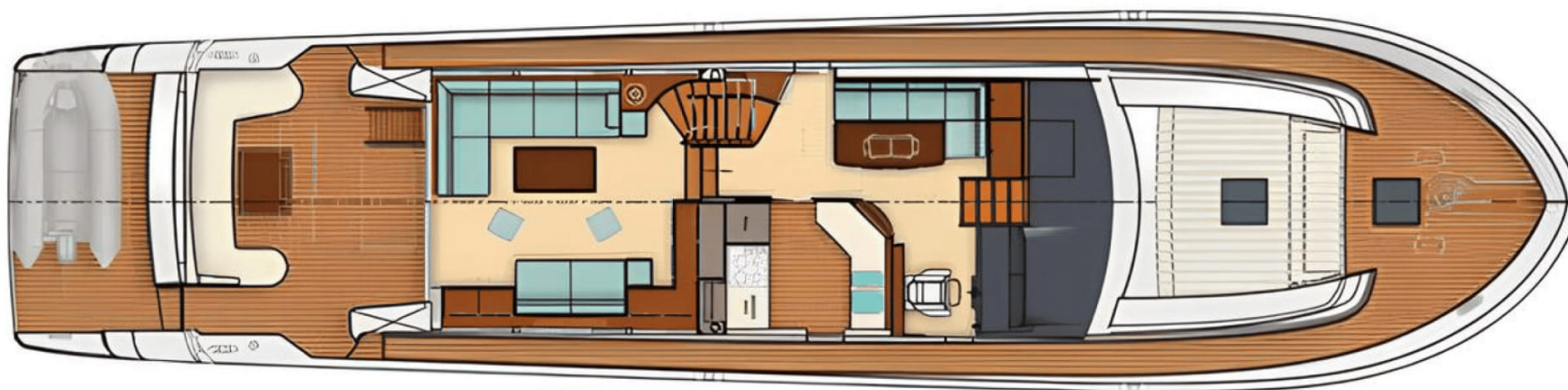

MAIN DECK





LOWER DECK





KIRILL KUATOV

+377 607 93 15 20

+39 333 576 44 44

 [Send e-mail](#)

 WhatsApp

 Telegram